

(12)
United States Patent
Mennie et al.

(10) **Patent No.:** **US 12,333,886 B2**
(45) **Date of Patent:** **Jun. 17, 2025**

(54) **COIN PAD FOR COIN PROCESSING SYSTEM**

(71) Applicant: **Cummins-Allison Corp.**, Mount Prospect, IL (US)

(72) Inventors: **Douglas U. Mennie**, Barrington, IL (US); **John R. Blake**, St. Charles, IL (US); **Ricky Newsom**, Bolingbrook, IL (US); **James M. Rasmussen**, Chicago, IL (US); **Kevin M. Carrara**, Des Plaines, IL (US); **Glenn S. Gordon**, Cameron Park, CA (US)

(73) Assignee: **Cummins-Allison Corp.**, Mount Prospect, IL (US)

(*) Notice: Subject to any disclaimer, the term of this patent is extended or adjusted under 35 U.S.C. 154(b) by 21 days.

(21) Appl. No.: **18/365,334**
(22) Filed: **Aug. 4, 2023**

(65) **Prior Publication Data**
US 2023/0419762 A1 Dec. 28, 2023

 Related U.S. Application Data
(60) Continuation of application No. 17/816,393, filed on Jul. 29, 2022, now Pat. No. 11,776,345, which is a (Continued)

(51) **Int. Cl.**
G07D 3/12 (2006.01)
G07D 5/02 (2006.01)
(52) **U.S. Cl.**
CPC **G07D 3/128** (2013.01); **G07D 5/02** (2013.01); **G07D 2205/00** (2013.01)
(58) **Field of Classification Search**
CPC **G07D 3/128**
See application file for complete search history.

(56) **References Cited**

U.S. PATENT DOCUMENTS

4,203,603 A * 5/1980 Konta A63F 7/2409 273/129 W
4,269,413 A * 5/1981 Langieri A63F 7/26 273/DIG. 26

(Continued)

FOREIGN PATENT DOCUMENTS

CA 2189330 C 12/2000
CA 2235925 C 7/2001
(Continued)

OTHER PUBLICATIONS

NPL WO (Year: 2017).*

(Continued)

Primary Examiner — Thien M Le
Assistant Examiner — Asifa Habib

(57) **ABSTRACT**

A resilient coin sorting pad for imparting motion to a plurality of coins is provided, the resilient coin sorting pad designed to be coupled to a rotatable disc of a coin sorter, the resilient coin sorting pad being generally circular and having an outer periphery edge. The resilient coin sorting pad comprises a lower foam layer having a top surface, an upper skin layer coupled to the top surface of the foam layer, and a layer of mesh material. According to some embodiments, the upper skin layer comprises at least one layer of nitrile rubber and the layer of mesh material is nylon fiber mesh. According to some embodiments, the upper skin layer comprises at least two layers of nitrile rubber and the layer of mesh material is positioned between the at least two layers of nitrile rubber.

14 Claims, 27 Drawing Sheets

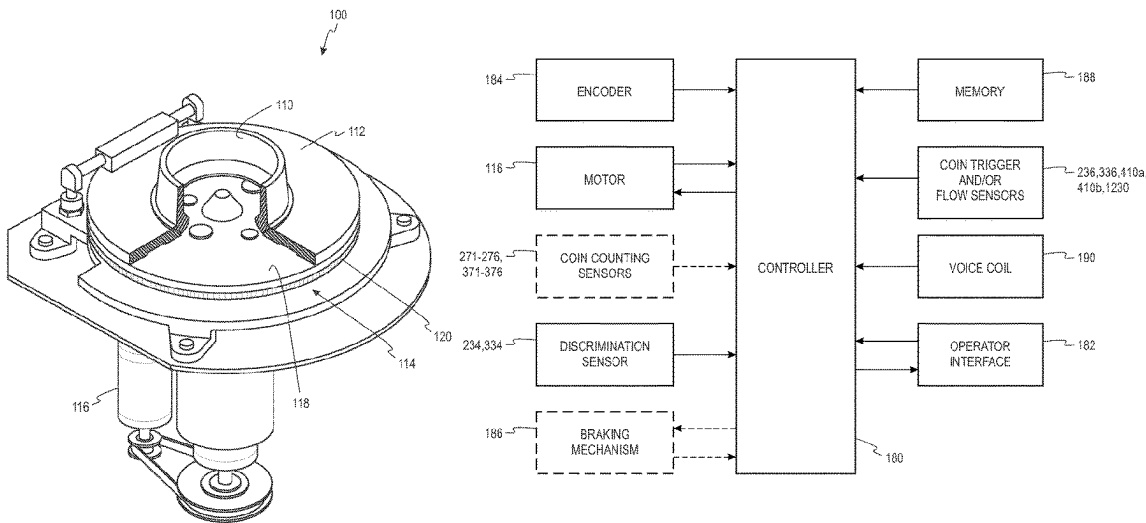

Page 2

5,026,320	A	6/1991	Rasmussen
5,031,098	A	7/1991	Miller
5,033,602	A	7/1991	Saarinén
5,039,848	A	8/1991	Stoken
5,055,086	A	10/1991	Raterman
5,055,657	A	10/1991	Miller
5,056,643	A	10/1991	Kirberg
5,064,999	A	11/1991	Okamoto
5,067,928	A	11/1991	Harris
5,080,633	A	1/1992	Ristvedt
5,091,713	A	2/1992	Horne
5,104,353	A	4/1992	Ristvedt
5,105,601	A	4/1992	Horiguchi
5,106,338	A	4/1992	Rasmussen
5,111,927	A	5/1992	Schulze, Jr.
5,114,381	A	5/1992	Ueda
5,120,945	A	6/1992	Nishibe
5,123,873	A	6/1992	Rasmussen
5,129,205	A	7/1992	Rasmussen
5,135,435	A	8/1992	Rasmussen
5,140,517	A	8/1992	Nagata
5,141,443	A	8/1992	Rasmussen
5,141,472	A	8/1992	Todd
5,145,455	A	9/1992	Todd
5,146,067	A	9/1992	Sloan
5,154,272	A	10/1992	Nishiumi
5,163,866	A	11/1992	Rasmussen
5,163,867	A	11/1992	Rasmussen
5,163,868	A	11/1992	Adams
5,167,313	A	12/1992	Dobbins
5,175,416	A	12/1992	Mansvelt
5,176,565	A	1/1993	Ristvedt
5,179,517	A	1/1993	Sarbin
5,183,142	A	2/1993	Latchinian
5,184,709	A	2/1993	Nishiumi
5,194,037	A	3/1993	Jones
5,197,919	A	3/1993	Gelb
5,205,780	A	4/1993	Rasmussen
5,207,784	A	5/1993	Schwartzendruber
5,209,696	A	5/1993	Rasmussen
5,236,071	A	8/1993	Lee
5,243,174	A	9/1993	Veeneman
5,251,738	A	10/1993	Dabrowski
5,252,811	A	10/1993	Henochowicz
5,253,167	A	10/1993	Yoshida
5,259,491	A	11/1993	Ward, II
5,263,566	A	11/1993	Nara
5,265,874	A	11/1993	Dickinson
5,268,561	A	12/1993	Kimura
5,277,651	A	1/1994	Rasmussen
5,282,127	A	1/1994	Mil
5,286,226	A	2/1994	Rasmussen
5,286,954	A	2/1994	Sato
5,291,003	A	3/1994	Avnet
5,291,560	A	3/1994	Daugman
5,293,981	A	3/1994	Abe
5,297,030	A	3/1994	Vassigh
5,297,598	A	3/1994	Rasmussen
5,297,986	A	3/1994	Ristvedt
5,299,977	A	4/1994	Mazur
5,302,811	A	4/1994	Fukatsu
5,324,922	A	6/1994	Roberts
5,326,104	A	7/1994	Pease
5,370,575	A	12/1994	Geib
5,372,542	A	12/1994	Geib
5,374,814	A	12/1994	Kako
5,379,344	A	1/1995	Larsson
5,379,875	A	1/1995	Shames
5,382,191	A	1/1995	Rasmussen
5,390,776	A	2/1995	Thompson
5,401,211	A	3/1995	Geib
5,404,986	A	4/1995	Hossfield
5,410,590	A	4/1995	Blood
RE34,934	E	5/1995	Raterman
5,425,669	A	6/1995	Geib
5,429,550	A	7/1995	Mazur
5,440,108	A	8/1995	Tran
5,443,419	A	8/1995	Adams
5,450,938	A	9/1995	Rademacher

(56)

References Cited

U.S. PATENT DOCUMENTS

5,453,047	A	9/1995	Mazur	6,039,644	A	3/2000	Geib
5,458,285	A	10/1995	Remien	6,039,645	A	3/2000	Mazur
5,468,182	A	11/1995	Geib	6,042,470	A	3/2000	Geib
5,470,079	A	11/1995	LeStrange	6,047,807	A	4/2000	Molbak
5,474,495	A	12/1995	Geib	6,047,808	A	4/2000	Neubarth
5,474,497	A	12/1995	Jones	6,056,104	A	5/2000	Neubarth
5,480,348	A	1/1996	Mazur	6,068,194	A	5/2000	Mazur
5,489,237	A	2/1996	Geib	6,080,056	A	6/2000	Karlsson
5,500,514	A	3/1996	Veeneman	6,082,519	A	7/2000	Martin
5,501,631	A	3/1996	Mennie	6,086,471	A	7/2000	Zimmermann
5,507,379	A	4/1996	Mazur	6,095,313	A	8/2000	Molbak
5,514,034	A	5/1996	Jones	6,116,402	A	9/2000	Beach
5,520,577	A	5/1996	Rasmussen	6,131,625	A	10/2000	Casanova
5,531,309	A	7/1996	Kloss	6,139,418	A	10/2000	Geib
5,538,468	A	7/1996	Ristvedt	6,142,285	A	11/2000	Panzeri
5,542,880	A	8/1996	Geib	6,145,738	A	11/2000	Stinson
5,542,881	A	8/1996	Geib	6,154,879	A	11/2000	Pare, Jr.
5,553,320	A	9/1996	Matsuura	6,168,001	B1	1/2001	Davis
5,559,887	A	9/1996	Davis	6,171,182	B1	1/2001	Geib
5,564,546	A	10/1996	Molbak	6,174,230	B1	1/2001	Gerrity
5,564,974	A	10/1996	Mazur	6,196,371	B1	3/2001	Martin
5,564,978	A	10/1996	Jones	6,196,913	B1	3/2001	Geib
5,570,465	A	10/1996	Tsakanikas	6,202,006	B1	3/2001	Scott
5,573,457	A	11/1996	Watts	6,213,277	B1	4/2001	Blad
5,584,758	A	12/1996	Geib	6,230,928	B1	5/2001	Hanna
5,592,377	A	1/1997	Lipkin	6,264,545	B1	7/2001	Magee
5,602,933	A	2/1997	Blackwell	6,308,887	B1	10/2001	Korman
5,615,625	A	4/1997	Cassidy	6,318,536	B1	11/2001	Korman
5,620,079	A	4/1997	Molbak	6,318,537	B1	11/2001	Jones
5,623,547	A	4/1997	Jones	6,349,972	B1	2/2002	Geiger
5,625,562	A	4/1997	Veeneman	6,386,323	B1	5/2002	Ramachandran
5,630,494	A	5/1997	Strauts	6,412,620	B1	7/2002	Imura
5,641,050	A	6/1997	Smith	6,431,342	B1	8/2002	Schwartz
5,650,605	A	7/1997	Morioka	6,438,230	B1	8/2002	Moore
5,650,761	A	7/1997	Gomm	6,456,928	B1	9/2002	Johnson
5,652,421	A	7/1997	Veeneman	6,471,030	B1	10/2002	Neubarth
5,665,952	A	9/1997	Ziarno	6,474,548	B1	11/2002	Montross
5,679,070	A	10/1997	Ishida	6,484,863	B1	11/2002	Molbak
5,684,597	A	11/1997	Hossfield	6,484,884	B1	11/2002	Gerrity
5,696,366	A	12/1997	Ziarno	6,494,776	B1	12/2002	Molbak
5,743,373	A	4/1998	Strauts	6,499,277	B1	12/2002	Warner
5,746,299	A	5/1998	Molbak	6,503,138	B2	1/2003	Spoehr
5,774,874	A	6/1998	Veeneman	6,520,308	B1	2/2003	Martin
5,782,686	A	7/1998	Geib	6,522,772	B1	2/2003	Morrison
5,799,767	A	9/1998	Molbak	6,547,131	B1	4/2003	Foodman
5,813,510	A	9/1998	Rademacher	6,552,781	B1	4/2003	Rompel
5,823,315	A	10/1998	Hoffman	6,554,185	B1	4/2003	Montross
5,830,054	A	11/1998	Petri	6,579,165	B2	6/2003	Kuhlin
5,838,812	A	11/1998	Pare, Jr.	6,581,042	B2	6/2003	Pare, Jr.
5,842,188	A	11/1998	Ramsey	6,602,125	B2	8/2003	Martin
5,842,916	A	12/1998	Gerrity	6,609,604	B1	8/2003	Jones
5,850,076	A	12/1998	Morioka	6,612,921	B2	9/2003	Geib
5,854,581	A	12/1998	Mori	6,637,576	B1	10/2003	Jones
5,865,673	A	2/1999	Geib	6,640,956	B1	11/2003	Zwieg
5,875,879	A	3/1999	Hawthorn	6,644,696	B2	11/2003	Brown
5,880,444	A	3/1999	Shibata	6,652,380	B1	11/2003	Luciano
5,892,211	A	4/1999	Davis	6,655,585	B2	12/2003	Shinn
5,892,827	A	4/1999	Beach	6,659,259	B2	12/2003	Knox
5,909,793	A	6/1999	Beach	6,662,166	B2	12/2003	Pare, Jr.
5,909,794	A	6/1999	Molbak	6,663,675	B2	12/2003	Blake
5,913,399	A	6/1999	Takemoto	6,666,318	B2	12/2003	Gerrity
5,918,748	A	7/1999	Clark	6,719,121	B2	4/2004	Alexander
5,940,623	A	8/1999	Watts	6,755,730	B2	6/2004	Geib
5,941,364	A	8/1999	Wei	6,758,316	B2	7/2004	Molbak
5,944,162	A	8/1999	Filiberti	6,761,308	B1	7/2004	Hanna
5,944,600	A	8/1999	Zimmermann	6,766,892	B2	7/2004	Martin
5,944,601	A	8/1999	Hayashi	6,783,452	B2	8/2004	Hino
5,951,476	A	9/1999	Beach	6,786,398	B1	9/2004	Stinson
5,957,262	A	9/1999	Molbak	6,854,581	B2	2/2005	Molbak
5,988,348	A	11/1999	Martin	6,854,640	B2	2/2005	Peklo
5,995,949	A	11/1999	Morioka	6,863,168	B1	3/2005	Gerrity
5,997,395	A	12/1999	Geib	6,892,871	B2	5/2005	Strauts
6,017,270	A	1/2000	Ristvedt	6,896,118	B2	5/2005	Jones
6,021,883	A	2/2000	Casanova	6,928,546	B1	8/2005	Nanavati
6,032,859	A	3/2000	Muehlberger	6,950,810	B2	9/2005	Lapsley
				6,953,150	B2	10/2005	Shepley
				6,957,746	B2	10/2005	Martin
				6,966,417	B2	11/2005	Peklo
				6,976,570	B2	12/2005	Molbak

(56)	References Cited			9,875,593 B1 *	1/2018	Adams	G07D 11/235
	U.S. PATENT DOCUMENTS			9,916,713 B1	3/2018	Yacoubian	
				9,934,640 B2	4/2018	Blake	
				10,043,333 B1	8/2018	Adams	
6,988,606 B2	1/2006	Geib		10,049,521 B1	8/2018	Blake	
6,991,530 B2	1/2006	Hino		10,068,406 B1	9/2018	Jagielinski	
7,004,831 B2	2/2006	Hino		10,089,812 B1	10/2018	Blake	
7,014,029 B2	3/2006	Winters		10,181,234 B2	1/2019	Rasmussen	
7,014,108 B2	3/2006	Sorenson		2001/0034203 A1	10/2001	Geib	
7,017,729 B2	3/2006	Gerrity		2001/0048025 A1	12/2001	Shinn	
7,018,286 B2	3/2006	Blake		2002/0065033 A1	5/2002	Geib	
7,028,827 B1	4/2006	Molbak		2002/0069104 A1	6/2002	Beach	
7,036,651 B2	5/2006	Tam		2002/0074209 A1	6/2002	Karlsson	
7,083,036 B2	8/2006	Adams		2002/0085745 A1	7/2002	Jones	
7,113,929 B1	9/2006	Beach		2002/0095587 A1	7/2002	Doyle	
7,131,580 B2	11/2006	Molbak		2002/0107738 A1	8/2002	Beach	
7,149,336 B2	12/2006	Jones		2002/0126885 A1	9/2002	Mennie	
7,152,727 B2	12/2006	Waechter		2002/0130011 A1 *	9/2002	Casanova	G07F 1/048
7,158,662 B2	1/2007	Chiles					194/344
7,188,720 B2	3/2007	Geib		2002/0147588 A1	10/2002	Davis	
7,213,697 B2	5/2007	Martin		2002/0151267 A1	10/2002	Kuhlin	
7,243,773 B2	7/2007	Bochonok		2002/0162724 A1	11/2002	Hino	
7,269,279 B2	9/2007	Chiles		2002/0174348 A1	11/2002	Ting	
7,303,119 B2	12/2007	Molbak		2002/0179401 A1	12/2002	Knox	
7,331,521 B2	2/2008	Sorenson		2003/0004878 A1	1/2003	Akutsu	
7,337,890 B2	3/2008	Bochonok		2003/0013403 A1	1/2003	Blake	
7,427,230 B2	9/2008	Blake		2003/0042110 A1	3/2003	Wilfong	
7,438,172 B2	10/2008	Long		2003/0081824 A1	5/2003	Mennie	
7,464,802 B2	12/2008	Gerrity		2003/0124966 A1	7/2003	Hino	
7,500,568 B2	3/2009	Cousin		2003/0127299 A1	7/2003	Jones	
7,520,374 B2	4/2009	Martin		2003/0150688 A1	8/2003	Martin	
7,551,764 B2	6/2009	Chiles		2003/0168309 A1	9/2003	Geib	
7,552,810 B2	6/2009	Mecklenburg		2003/0168310 A1	9/2003	Strauts	
7,580,859 B2	8/2009	Economy		2003/0182217 A1	9/2003	Chiles	
7,604,107 B2	10/2009	Richard		2003/0190882 A1	10/2003	Blake	
7,654,450 B2	2/2010	Mateen		2003/0230464 A1	12/2003	Deaville	
7,658,270 B2	2/2010	Bochonok		2003/0234153 A1	12/2003	Blake	
7,735,125 B1	6/2010	Alvarez		2004/0021898 A1	2/2004	Ashizaki	
7,735,622 B2 *	6/2010	String	G07D 9/008	2004/0055902 A1	3/2004	Peklo	
			453/57	2004/0092222 A1	5/2004	Kowalczyk	
7,743,902 B2	6/2010	Wendell		2004/0153406 A1	8/2004	Alarcon-Luther	
7,778,456 B2	8/2010	Jones		2004/0153421 A1	8/2004	Robinson	
7,819,308 B2	10/2010	Osterberg		2004/0154899 A1	8/2004	Peklo	
7,874,478 B2	1/2011	Molbak		2004/0173432 A1	9/2004	Jones	
7,886,890 B2	2/2011	Blake		2004/0188221 A1	9/2004	Carter	
7,931,304 B2	4/2011	Brown		2004/0195302 A1	10/2004	Washington	
7,946,406 B2	5/2011	Blake		2004/0199924 A1	10/2004	Ganesh	
7,949,582 B2	5/2011	Mennie		2004/0200691 A1	10/2004	Geib	
7,963,382 B2	6/2011	Wendell		2004/0238319 A1	12/2004	Hand	
7,980,378 B2	7/2011	Jones		2004/0238614 A1	12/2004	Yoshioka	
8,023,715 B2	9/2011	Jones		2004/0256197 A1	12/2004	Blake	
8,042,732 B2	10/2011	Blake		2005/0006197 A1	1/2005	Wendell	
8,229,821 B2	7/2012	Mennie		2005/0035140 A1	2/2005	Carter	
8,346,610 B2	1/2013	Mennie		2005/0040007 A1	2/2005	Geib	
8,352,322 B2	1/2013	Mennie		2005/0040225 A1	2/2005	Csulits	
8,393,455 B2	3/2013	Blake		2005/0045450 A1	3/2005	Geib	
8,443,958 B2	5/2013	Blake		2005/0067305 A1	3/2005	Bochonok	
RE44,252 E	6/2013	Jones		2005/0077142 A1	4/2005	Tam	
8,523,641 B2	9/2013	Kuykendall		2005/0086140 A1	4/2005	Ireland	
8,545,295 B2	10/2013	Blake		2005/0087425 A1	4/2005	Peklo	
8,602,200 B2	12/2013	Blake		2005/0096986 A1	5/2005	Taylor	
8,607,957 B2	12/2013	Blake		2005/0098625 A1	5/2005	Walker	
8,616,359 B2	12/2013	Bochonok		2005/0108165 A1	5/2005	Jones	
RE44,689 E	1/2014	Wendell		2005/0109836 A1	5/2005	Ben-Aissa	
8,684,159 B2	4/2014	Blake		2005/0121507 A1	6/2005	Brown	
8,684,160 B2	4/2014	Hallowell		2005/0124407 A1	6/2005	Rowe	
8,701,860 B1	4/2014	Blake		2005/0150740 A1	7/2005	Finkenzeller	
8,950,566 B2	2/2015	Hallowell		2005/0156318 A1	7/2005	Douglas	
8,959,029 B2	2/2015	Jones		2005/0205654 A1	9/2005	Carter	
9,058,626 B1	6/2015	Donaho		2005/0205655 A1	9/2005	Carter	
9,092,924 B1	7/2015	Rasmussen		2005/0228717 A1	10/2005	Gusler	
9,330,515 B1	5/2016	Rasmussen		2005/0256792 A1	11/2005	Shimizu	
9,430,893 B1	8/2016	Blake		2006/0037835 A1	2/2006	Doran	
9,437,069 B1	9/2016	Blake		2006/0054455 A1	3/2006	Kuykendall	
9,501,885 B1	11/2016	Yacoubian		2006/0054457 A1 *	3/2006	Long	G07F 1/041
9,508,208 B1	11/2016	Jagielinski					194/347
9,633,500 B1	4/2017	Blake		2006/0060363 A2	3/2006	Carter	
9,830,762 B1	11/2017	Blake		2006/0064379 A1	3/2006	Doran	
9,870,668 B1	1/2018	Jagielinski		2006/0065717 A1	3/2006	Hurwitz	

(56)	References Cited			EP	1104920	A1	6/2001
	U.S. PATENT DOCUMENTS			EP	1209639	A2	5/2002
				EP	1528513	A1	5/2005
				FR	2042254	A5	2/1971
2006/0069654	A1	3/2006	Beach	GB	2035642	A	6/1980
2006/0087074	A1 *	4/2006	Moffett	GB	2175427	A	11/1986
			G07F 17/3297	GB	2198274	A	6/1988
			273/143 R	GB	2458387	A	9/2009
2006/0146839	A1	7/2006	Hurwitz	GB	2468783	A	9/2010
2006/0148394	A1	7/2006	Blake	GB	2514241	A	11/2014
2006/0149415	A1	7/2006	Richards	GB	2553928	A	3/2018
2006/0151285	A1	7/2006	String	JP	S4958899	A	6/1974
2006/0154589	A1	7/2006	String	JP	S5214495	A	2/1977
2006/0175176	A1	8/2006	Blake	JP	S5271300	A	6/1977
2006/0182330	A1	8/2006	Chiles	JP	S5640992	A	4/1981
2006/0196754	A1	9/2006	Bochonok	JP	S57117080	A	7/1982
2006/0205481	A1	9/2006	Dominelli	JP	S5979392	A	5/1984
2006/0207856	A1	9/2006	Dean	JP	S6016271	U	2/1985
2006/0219519	A1	10/2006	Molbak	JP	S62134168	U	8/1987
2006/0253332	A1	11/2006	Dobbins	JP	S62182995	A	8/1987
2006/0283685	A1	12/2006	Cousin	JP	S62221773	A	9/1987
2007/0051582	A1	3/2007	Bochonok	JP	S62166562	U	10/1987
2007/0071302	A1	3/2007	Jones	JP	S6435683	A	2/1989
2007/0108015	A1	5/2007	Bochonok	JP	S6442789	A	2/1989
2007/0119681	A1	5/2007	Blake	JP	S6467698	A	3/1989
2007/0181676	A1	8/2007	Mateen	JP	H01118995	A	5/1989
2007/0187494	A1	8/2007	Hanna	JP	H01307891	A	12/1989
2007/0221470	A1	9/2007	Mennie	JP	H0250793	A	2/1990
2007/0251800	A1	11/2007	Castleberry	JP	H02252096	A	10/1990
2007/0269097	A1	11/2007	Chiles	JP	H0312776	A	1/1991
2007/0270997	A1	11/2007	Brumfield	JP	H0363795	A	3/1991
2008/0033829	A1	2/2008	Mennie	JP	H0392994	A	4/1991
2008/0044077	A1	2/2008	Mennie	JP	H03156673	A	7/1991
2008/0135608	A1	6/2008	Ireland	JP	H0485695	A	3/1992
2008/0220707	A1	9/2008	Jones	JP	H04175993	A	6/1992
2008/0223930	A1	9/2008	Rolland	JP	H0546839	A	2/1993
2009/0018959	A1	1/2009	Doran	JP	H05217048	A	8/1993
2009/0045031	A1 *	2/2009	Gunst	JP	H05274527	A	10/1993
			G07D 5/02	JP	H0635946	A	2/1994
			194/320	JP	H06103285	A	4/1994
2009/0236200	A1	9/2009	Hallowell	JP	H09251566	A	9/1997
2009/0236201	A1	9/2009	Blake	JP	2002117439	A	4/2002
2009/0239459	A1	9/2009	Watts	JP	2003242287	A	8/2003
2009/0242626	A1	10/2009	Jones	JP	2004213188	A	7/2004
2009/0320106	A1	12/2009	Jones	SE	44244		9/1988
2010/0038419	A1	2/2010	Blake	WO	1985000909	A1	2/1985
2010/0065623	A1	3/2010	Sauter	WO	1991006927	A1	5/1991
2010/0198726	A1	8/2010	Doran	WO	1991008952	A1	6/1991
2010/0234985	A1	9/2010	Shuren	WO	1991012594	A1	8/1991
2010/0261421	A1	10/2010	Wendell	WO	1991018371	A1	11/1991
2010/0276485	A1	11/2010	Jones	WO	1992008212	A1	5/1992
2010/0327005	A1	12/2010	Martin	WO	1992020043	A1	11/1992
2011/0098845	A1	4/2011	Blake	WO	1992020044	A1	11/1992
2011/0099105	A1	4/2011	Mennie	WO	1992022044	A1	12/1992
2011/0259961	A1	10/2011	Folk	WO	1993000660	A1	1/1993
2011/0270695	A1	11/2011	Jones	WO	1993009621	A1	5/1993
2012/0067950	A1	3/2012	Blake	WO	1994006101	A1	3/1994
2012/0156976	A1	6/2012	Blake	WO	1994008319	A1	4/1994
2013/0178139	A1	7/2013	Hallowell	WO	1994023397	A1	10/1994
2013/0199890	A1	8/2013	Blake	WO	1995002226	A1	1/1995
2013/0205723	A1	8/2013	Blake	WO	1995004978	A1	2/1995
2015/0101907	A1	4/2015	Hall	WO	1995006920	A1	3/1995
2015/0302678	A1	10/2015	Blake	WO	1995009406	A1	4/1995
2018/0108198	A1	4/2018	Rasmussen	WO	1995013596	A1	5/1995
2018/0108199	A1	4/2018	Blake	WO	1995019017	A1	7/1995
2019/0130690	A1	5/2019	Rasmussen	WO	1995023387	A1	8/1995
2019/0139348	A1	5/2019	Rasmussen	WO	1995030215	A1	11/1995
2024/0108972	A1 *	4/2024	Simone	WO	1996007163	A1	3/1996
			A63F 7/2409	WO	1996007990	A1	3/1996
FOREIGN PATENT DOCUMENTS				WO	1996012253	A1	4/1996
CA	2143943	C	3/2003	WO	1996027525	A1	9/1996
CA	2660418	A1	9/2009	WO	1996027859	A1	9/1996
CN	205541081	U	8/2016	WO	1997022919	A1	6/1997
CN	208433036	U	1/2019	WO	1997025692	A1	7/1997
DE	660354	C	5/1938	WO	1998024041	A1	6/1998
DE	3021327	A1	12/1981	WO	1998024067	A1	6/1998
EP	0351217	A2	1/1990	WO	1998048383	A2	10/1998
EP	0667973	A1	8/1995	WO	1998048384	A2	10/1998
EP	0926634	A2	6/1999	WO	1998048385	A2	10/1998

(56)

References Cited

FOREIGN PATENT DOCUMENTS

WO	1998051082	A1	11/1998	
WO	1998059323	A1	12/1998	
WO	1999000776	A1	1/1999	
WO	1999006937	A1	2/1999	
WO	1999016027	A2	4/1999	
WO	1999033030	A1	7/1999	
WO	1999041695	A1	8/1999	
WO	1999048057	A1	9/1999	
WO	1999048058	A1	9/1999	
WO	2000048911	A1	8/2000	
WO	2000065546	A1	11/2000	
WO	2001063565	A2	8/2001	
WO	2002071343	A1	9/2002	
WO	2003052700	A2	6/2003	
WO	2003079300	A1	9/2003	
WO	2003085610	A1	10/2003	
WO	2003107280	A2	12/2003	
WO	2004044853	A1	5/2004	
WO	2004109464	A2	12/2004	
WO	2005041134	A2	5/2005	
WO	2005088563	A1	9/2005	
WO	2006086531	A1	8/2006	
WO	2007031770	A1	3/2007	
WO	2007035420	A2	3/2007	
WO	2007120825	A2	10/2007	
WO	WO-2017048894	A1 *	3/2017 G07D 3/00

OTHER PUBLICATIONS

Brandt; Model 966 Microsort™ Coin Sorter and Counter, 4 pages, (1979).

Childers Corporation: Computerized Sorter/Counter, "To coin an old adage, time is money . . .," 3 pages (1981).

Cummins: JetSort® Coin Sorter Counter/CA-130XL Coin Wrapper, Cummins Automated Money Systems (AMS) Case Study—Fifth-Third, "6,000 Coin Per Minute Counter/Sorter Keeps pace With Fifth-Third Banks Money Processing Needs," (Form 13C1180), 2 pages (Nov. 1981).

Brandt: 95 Series Coin Sorter Counter, 2 pages (1982).

Brandt: Model 958 Coin Sorter/Counter, 5 pages (© 1982).

Cummins: JetSort® 700-01 Coin Sorter/Counter, Operating Instructions, 14 pages (1982).

Cummins: JetSort® 700-01/CA-118 Coin Wrapper, Cummins Automated Money Systems (AMS) Case Study—University State Bank, "Cummins Money Processing System Boosts Teller Service at University State Bank," (Form 13C1192), 2 pages (Mar. 1982).

Cummins: JetSort® 700-01, Cummins Automated Money Systems (AMS) Case Study—First State Bank of Oregon, "JetSort® Gives Bank Coin Service Edge," (Form 13C1196), 2 pages (Apr. 1982).

Cummins: JetSort®, "What do all these Banks have in Common . . .," JetSort, CA-130XL coin wrapper, CA-118 coin wrapper, CA-4000 JetCount, (13C1203), 3 pages (Aug. 1982).

Brandt: Model 817 Automated Coin and Currency Ordering System, 2 pages (1983).

Brandt: Model 970 Coin Sorter and Counter, 2 pages (1983).

Cummins: The Universal Solution to All Coin and Currency Processing Needs (Form 13C1218 3-83), 1 page (Mar. 1983).

Cummins: JetSort® Model CA-750 Coin Sorter/Counter and CA-4050 JetCount currency counter, "Money Processing Made Easy," (Form 13C1221) 2 pages (Jun. 1983).

Cummins: JetSort® 701, Cummins Automated Money Systems (AMS) Case Study—Convenco Vending, "High Speed Coin Sorter increases coin processing power at Convenco Vending," (Form 13C1226), 2 pages (Jul. 1983).

Brandt: Model 960 High-Speed Coin Sorter & Counter, 2 pages (1984).

Cummins: JetSort® Model 1701 with JetStops, Operating Instructions Manual (Form 022-1329-00), 16 pages (1984).

Cummins: JetSort Models 701 and 750, "State-of-the-art coin processing comes of age," 2 pages (Feb. 1984).

Cummins: JetSort® Model CA-750 Coin Processor (Item No. 50-152), 1 page (Jul. 1984).

Cummins: JetSort® Model 1760 brochure, (Form 023-1262-00), 2 pages (Jul. 1985).

Cummins: JetSort® Models 1770 and 3000, Communication Package specification and operating instructions, 10 pages (uncertain, possibly Nov. 1985).

Brandt: Model 1205 Coin Sorter Counter, 2 pages (1986).

Cummins: JetSort® Model 1770, "JetSort® Speed and Accuracy, Now with Communications," (Form 023-1272) 1 page (Oct. 1986).

Cummins: JetSort® 3000, "3,000 Coins per Minute," (Form 023-1312), 1 page (date unknown, est. 1987).

Cummins: JetSort®, "Venders Love JetSort," (13C1255), 1 page (Mar. 1987).

Cummins: JetSort® mailer, "One moving part simplicity," "Vendors-Are validators changing your coin and currency needs" (Form 023-1297), 3 pages (Apr. 1987).

Cummins: JetSort® 3200, Enhanced electronics for the JetSort® 3200 (Form 023-1350), 1 page (Apr. 1987).

Scan Coin: International Report, 49 pages (Apr. 1987).

Scan Coin: World, 2 pages (Feb. 1988).

Cummins: JetSort® "Time for a Change, Be a smashing success," (Form 023-1328), 1 page (Jun. 1988).

Cummins: JetSort® "Time for a Change—JetSort® vs. Brandt X," (Form 023-1330), 1 page (Jun. 1988).

Cummins: JetSort® "Time for a Change—No Coins Sorted After 3:00 or on Saturday," (Form 023-1327), 1 page (Aug. 1988).

Brandt: Model 8904 Upfeed—"High Speed 4-Denomination Currency Dispenser," 2 pages (1989).

Scan Coin: CDS Coin Deposit System-Technical Referens Manual, 47 pages (1989).

Cummins: JetSort® "High Speed Coin Sorter & Counter for Payphone Applications," "CTOCS Ready" (Form 023-1365), 2 pages (Mar. 1989).

Brandt: Model 952 Coin Sorter/Counter, 2 pages (date unknown, prior to Oct. 31, 1989).

Brandt: Model 940-6 High Speed Sorter/Counter, 2 pages (date unknown, prior to Oct. 31, 1989).

Brandt: Model 954 Coin Sorter/Counter, 2 pages (date unknown, prior to Oct. 31, 1989).

Brandt: Model 957 Coin Sorter/Counter, 2 pages (date unknown, prior to Oct. 31, 1989).

Cummins: JetSort® Series V High Speed Coin Sorter/Counter, (Form 023-1383), 2 pages (Sep. 1990).

Scan Coin: CDS MK 1 Coin Deposit System-Technical Manual, 32 pages (1991).

Royal Bank: Hemeon, Jade, "Royals Burlington drive-in bank provides customers 24-hour tellers," The Toronto Star, 1 page (Aug. 21, 1991).

Royal Bank: Oxby, Murray, "Royal Bank Opens "Super Branch,"" The Gazette Montreal, 2 pages (Sep. 14, 1991).

Royal Bank: Leitch, Carolyn, "High-Tech Bank Counts Coins," The Globe and Mail, 2 pages (Sep. 19, 1991).

Cummins: Cash Information and Settlement Systems (Form 023-1408), 4 pages (date Dec. 1991).

Brandt: Mach 7 High-Speed Coin Sorter/Counter, 2 pages (1992).

De La Rue: CDS 500 Cash Deponier System, 6 pages (date unknown, p. 5 has date May 1994, p. 6 has date Dec. 1992) (German).

Royal Bank: SuperBranch, "Experience the Ultimate in Convenience Banking," 2 pages (Feb. 1992).

Cash, Martin: Newspaper Article "Bank Blends New Technology with Service," Winnipeg Free Press, 1 page (Sep. 4, 1992).

Cummins: JetSort® High Speed Sorter/Counter Kits I & J-Operating Instructions (Form 022-7123-00) 12 pages (1994).

Meece, Mickey: Article "Development Bank of Singapore Gets Cobranding Edge with Smart Cards," American Banker, New York, NY, vol. 159, Iss. 195, p. 37, 2 pages (Oct. 10, 1994).

AUI: Coinverter—"No More Lines . . . Self-Serve Cash-Out," by Cassius Elston, 1995 World Games Congress/Exposition Converter, 1 page (dated prior to 1995).

Cummins: JetSort® 3000 Series High Speed Coin Sorter (Form 023-1468 Rev 1), 2 pages (Feb. 1995).

(56)

References Cited**OTHER PUBLICATIONS**

Reis Eurosystems: CRS 6501/CRS 6510 Cash Receipt Systems for Self-Service Area, 3 pages (date unknown, prior to Aug. 13, 1996, maybe Feb. 1995).

Frisco Bay: Commercial Kiosk, "Provide self-service solutions for your business customers," 4 pages (date unknown, prior to Mar. 2, 2011, p. 4 has date 1996).

Glory: CRS-8000 Cash Redemption System, 2 pages (1996).

Intellectual Australia Pty. Ltd.: Microbank, "From down under: Microbank," "hand-held smart card terminal that combines smart card functions and telephone banking," 2 pages (Feb. 1996).

ESD, Inc: Smartrac Card System, "Coinless laundry makes quarters obsolete; Smartrac Card System really makes a change in laundry industry," Business Wire, 2 pages (Feb. 23, 1996).

ISH Electronic: ISH I2005/500 Coin Counter (with translation), 4 pages (date unknown, prior to Aug. 1996).

ISH Electronic: ISH I2005/501 Self-Service Unit (with translation), 4 pages (date unknown, prior to Aug. 1996).

De La Rue: CDS 5700 and CD8 5800 Cash Deponier System (German) and translation, 7 pages (date unknown, prior to Aug. 13, 1996).

NGZ Geldzahlmaschinen-gesellschaft: NGZ 2100 Automated Coin Depository, 4 pages (date unknown, prior to Sep. 1996).

Brandt: Model 920/925 Counter, 2 pages (date unknown, prior to Jul. 2011, possibly prior to Mar. 17, 1997).

Brandt: System 930 Electric Counter/Sorter, "Solving Problems, Pleasing Customer, Building Deposits," 1 page (date unknown, prior to Mar. 2, 2011, possibly prior to Mar. 17, 1997).

Brandt: System 945 High-Speed Sorter, 2 pages (date unknown, prior to Mar. 2, 2011, possibly prior to Mar. 17, 1997).

Brandt: Model 1400 Coin Sorter Counter, 2 pages (date unknown, prior to Mar. 2, 2011, possibly prior to Mar. 17, 1997).

Diebold: Merchant MicroBranch, "Merchant MicroBranch Combines ATM After-Hour Depository Rolled-Coin Dispenser," Bank Technology News, 1 page (Nov. 1997).

Cummins: JetSort® 2000 Series High Speed Coin Sorter/Counter (Form 023-1488), 2 pages (Oct. 2000).

Case ICC Limited: CDS Automated Receipt Giving Cash Deposit System, 3 pages (date unknown, prior to Nov. 15, 2000).

Amiel Industries: AI-1500 "Pulsar" High Performance Sorting and Bagging Machine, 13 pages (date unknown, but prior to Dec. 14, 2000).

C'Tcoin: CDS602 Cash Deposit System, 1 page (date unknown, prior to Jan. 15, 2001).

Glory: AMT Automated Merchant Teller, 4 pages (date unknown, prior to Jan. 15, 2001).

Hamilton: Hamiltons Express Banking Center, In Less Space Than a Branch Managers Desk, 4 pages (date unknown, prior to Jan. 15, 2001).

Namsys, Inc.: Namsys Express, Making currency management . . . more profitable, 2 pages (date unknown, prior to Jan. 15, 2001).

Perconta: Contomat Coin Settlement Machine for Customer Self Service, 2 pages (date unknown, prior to Apr. 2003).

Prema GmbH: Prema 405 (RE) Self Service Coin Deposit Facility, 2 pages (date unknown, prior to Apr. 2003).

Reis Eurosystems: CRS 6520/ CRS 6525 Standard-Class Coin Deposit Systems, 1 page (date unknown, prior to Apr. 2003).

Reis Eurosystems: CS 3510 Disc-Sorter, 1 page (date unknown, prior to Apr. 2003).

Scan Coin: Money Processing Systems, 8 pages (date unknown, prior to Apr. 2003).

Scan Coin: CDS Cash Deposit System, 6 pages (date unknown, prior to Apr. 2003) [SC 0369].

Scan Coin: CDS 600 Users Manual, 14 pages (date unknown, prior to Apr. 2003).

Scan Coin: CDS 600 & CDS 640 Cash Deposit System-Technical Manual, 45 pages (date unknown, prior to Apr. 2003).

Scan Coin: SC 102 Value Counter Technical Manual, 28 pages (date unknown, prior to Apr. 2003).

Pay By Touch: Secure ID News, "Piggly Wiggly Extends Biometric Payments Throughout the Southeast U.S.," 2 pages, (Dec. 14, 2005).

Scan Coin: Coin Sachet System brochure, 4 pages (last page marked "© Scan Coin / Jun. 2007").

"3M Flexomount™ Solid Printing Tapes," Technical Data, 5 pages (Jul. 2009).

Fa. GBS-Geldbearbeitungssysteme: GBS9401SB Technical Specification, 24 pages (date unknown, prior to Nov. 10, 2010).

"3M Repositionable Tapes," Technical Data, 5 pages (Jan. 2011).

U.S. Appl. No. 13/836, 117, filed Mar. 15, 2013, Blake et al., System, Method and Apparatus for Automatically Filling a Coin Cassette.

Camloc Quick-Operating Fasteners, 86 pages (Release Feb. 2017, last 2 pages say Release Aug. 2014).

"New conductive ink for electronic apparel," Phys Org, <https://phys.org/news/2015-06-ink-electronic-apparel.html>, 2 pages (Jun. 25, 2015).

U.S. Appl. No. 15/461,046, filed Mar. 16, 2017, Jagielinski, Systems, Methods and Devices for Processing Batches of Coins Utilizing Coin Imaging Sensor Assemblies.

U.S. Appl. No. 15/827,573, filed Nov. 30, 2017, Blake et al., System, Method and Apparatus for Repurposing Currency.

U.S. Appl. No. 16/028,068, filed Jul. 5, 2018, Adams et al., Systems, Methods and Devices for Coin Processing and Coin Recycling.

U.S. Appl. No. 16/059,765, filed Aug. 9, 2018, Blake et al., Systems, Methods and Devices for Managing Rejected Coins During Coin Processing.

U.S. Appl. No. 16/120,252, filed Sep. 1, 2018, Jagielinski et al., Systems, Methods and Devices for Processing Coins with Linear Array of Coin Imaging Sensors.

U.S. Appl. No. 16/224,246, filed Dec. 18, 2018, Rasmussen, Coin Sorting Head and Coin Processing System Using the Same.

U.S. Appl. No. 16/226,020, filed Dec. 19, 2018, Rasmussen et al., Coin Sorting System Coin Chute.

"Soft, Wearable Health Monitor with Stretchable Electronics," by Georgia Institute of Technology, Tech Briefs, www.techbriefs.com, pp. 35-36, (Sep. 2019).

U.S. Appl. No. 16/733,494, filed Jan. 3, 2020, Mennie et al., Coin Pad for Coin Processing System.

Southco® Quarter-turn fastener information, 1st page entitled "82 DZUS® Performance Quarter-Turn Fasteners, Studs," 22 pages (date unknown, obtained Jan. 22, 2020).

Southco® Quarter-turn fastener information, 1st page entitled "DZUS® Quarter-Turn Fasteners," 63 pages (date unknown, obtained Jan. 22, 2020).

Southco® Quarter-turn fastener information, 1st page entitled "D5 Dzus® Panel Line Quarter-turn Fasteners, Studs" pages (date unknown, obtained Jan. 22, 2020).

Southco® Quarter-turn fastener information, 1st page entitled "D4 Dzus® Standard Line Quarter-Turn Fasteners, Stud Selection-Size 3" 15 pages (date unknown, obtained Jan. 22, 2020).

Southco® DZUS® Quarter-Turn Fasteners webpage, <https://www.southco.com/en-us/product/hierarchy.html?lid=7345>, 1 page (date unknown, obtained Jan. 22, 2020).

McMaster-Carr Quarter-Turn information, 1 page (date unknown, obtained Jan. 22, 2020).

Search Report dated Jun. 17, 2020 in connection with United Kingdom Patent Application No. GB2000070.9, 4 pages.

Examination report dated Mar. 17, 2021 in connection with Canadian Application No. 3,066,598, 4 pages.

Examination Report under Section 18(3) dated Mar. 1, 2022, in connection with United Kingdom Application No. GB2000070.9, 5 pages.

Combined Search and Examination Report under Sections 17 and 18(3) dated Sep. 26, 2022 in connection with United Kingdom Application No. 2212540.5, 5 pages.

Combined Search and Examination Report under Sections 17 and 18(3) dated Mar. 27, 2023 in connection with United Kingdom Application No. 2302853.3, 6 pages.

Combined Search and Examination Report under Sections 17 and 18(3) dated Apr. 3, 2023 in connection with United Kingdom Application No. 2302854.1, 4 pages.

(56)

References Cited

OTHER PUBLICATIONS

Examination Report under Section 18(3) dated May 24, 2023 in connection with United Kingdom Application No. 2302853.3, 4 pages.

Search Report under Section 17 dated Jul. 24, 2023, in connection with United Kingdom Application No. 2302902.5, 3 pages.

* cited by examiner

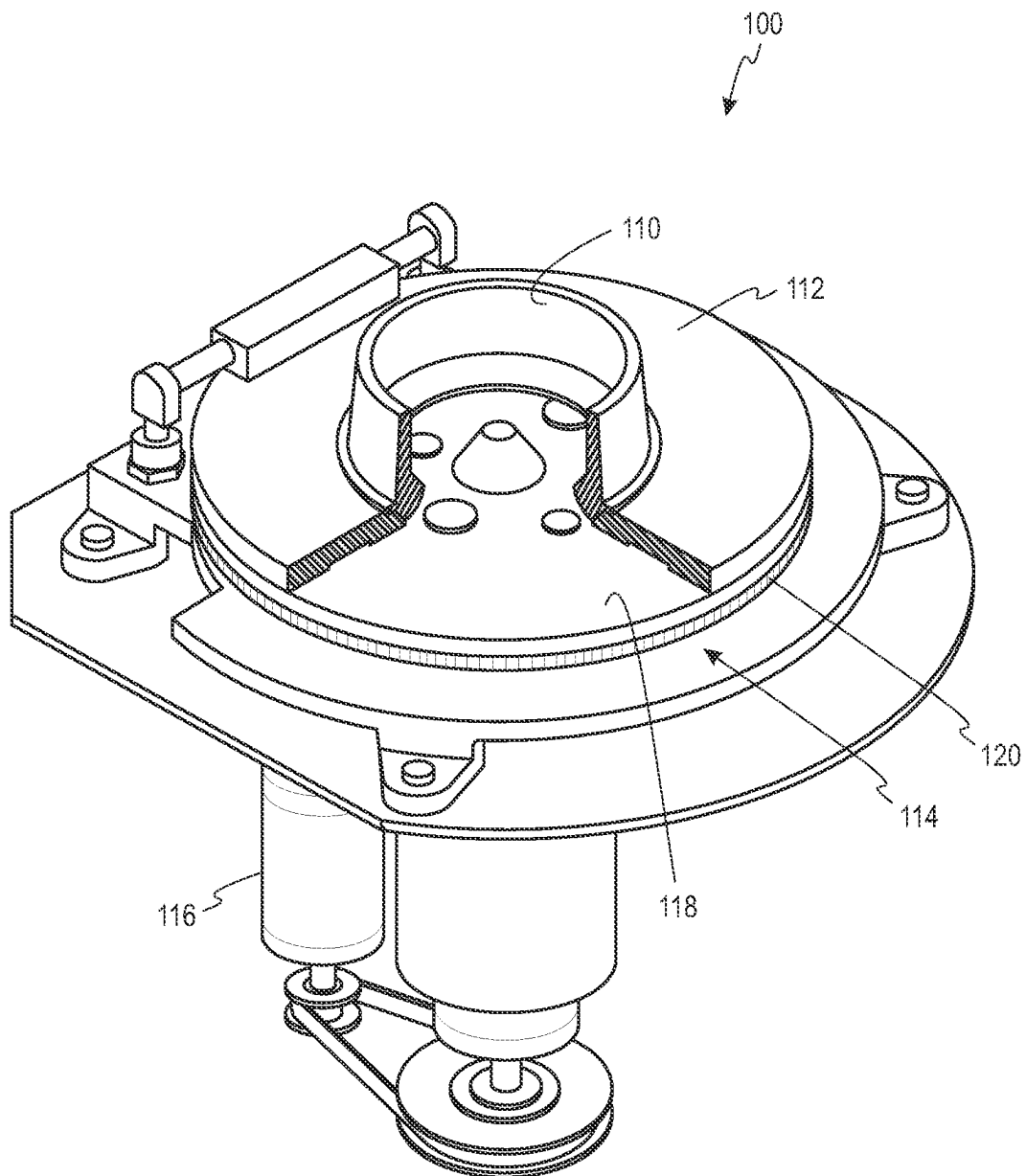

Fig. 1A

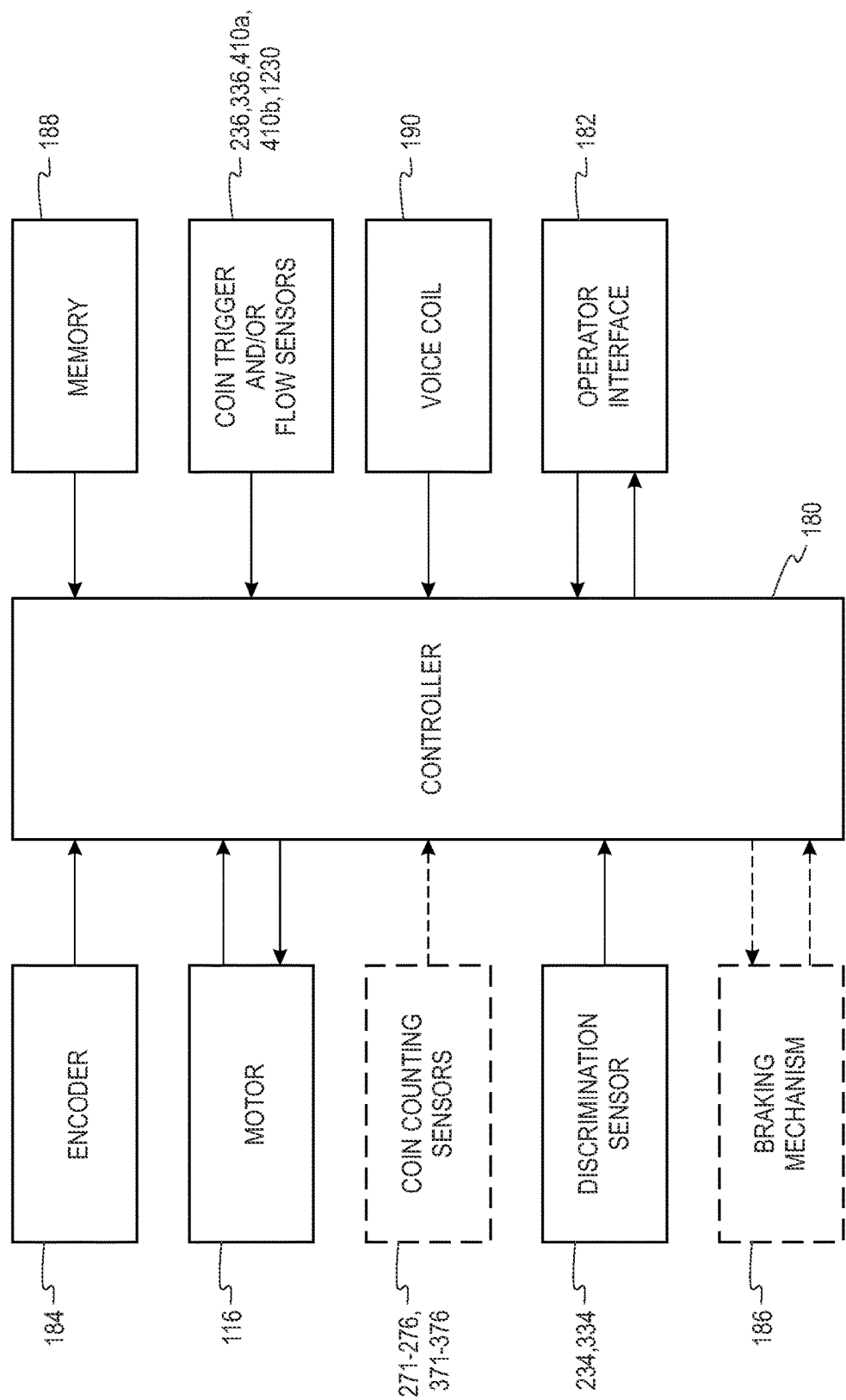

Fig. 1B

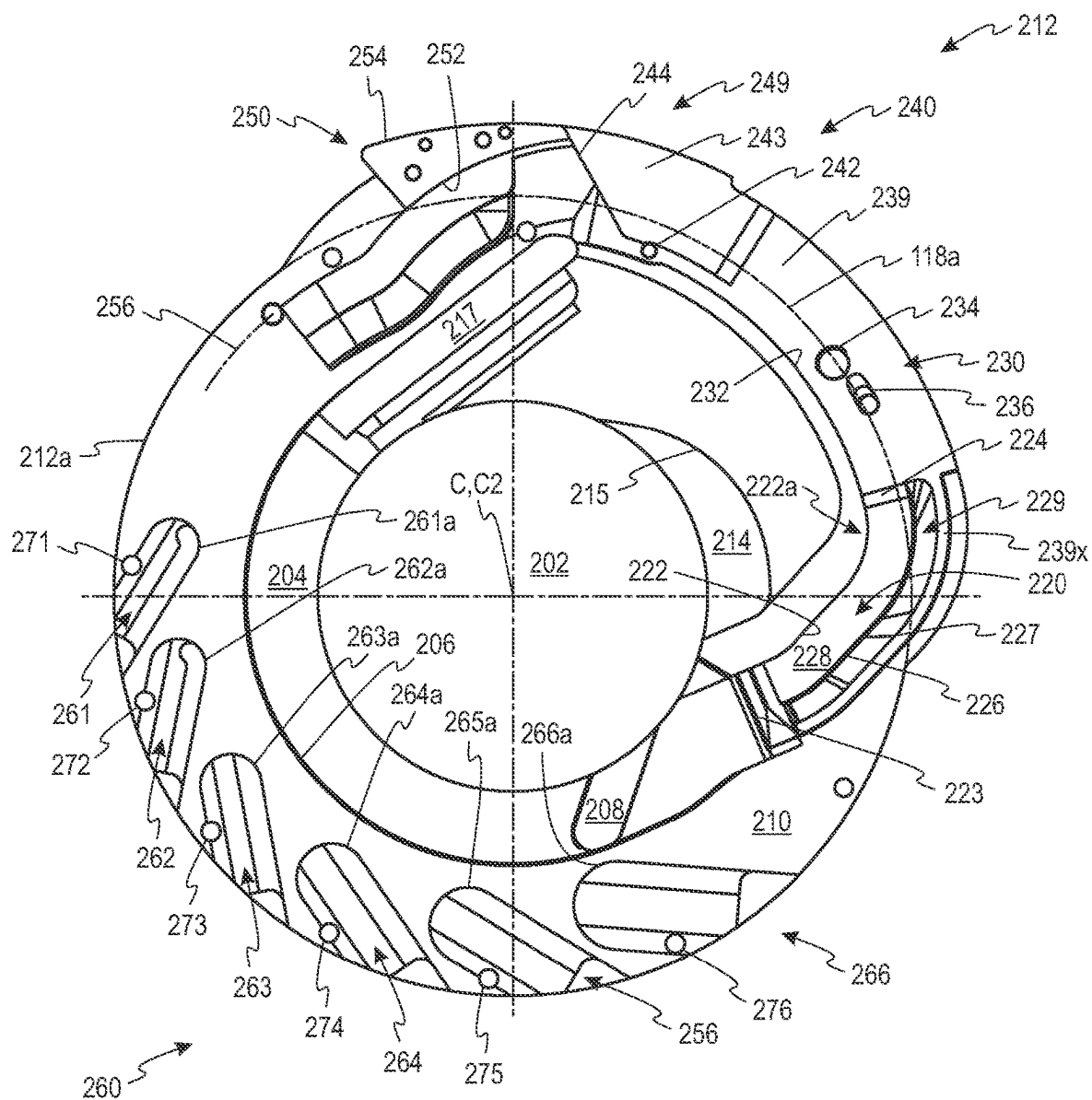

Fig. 2

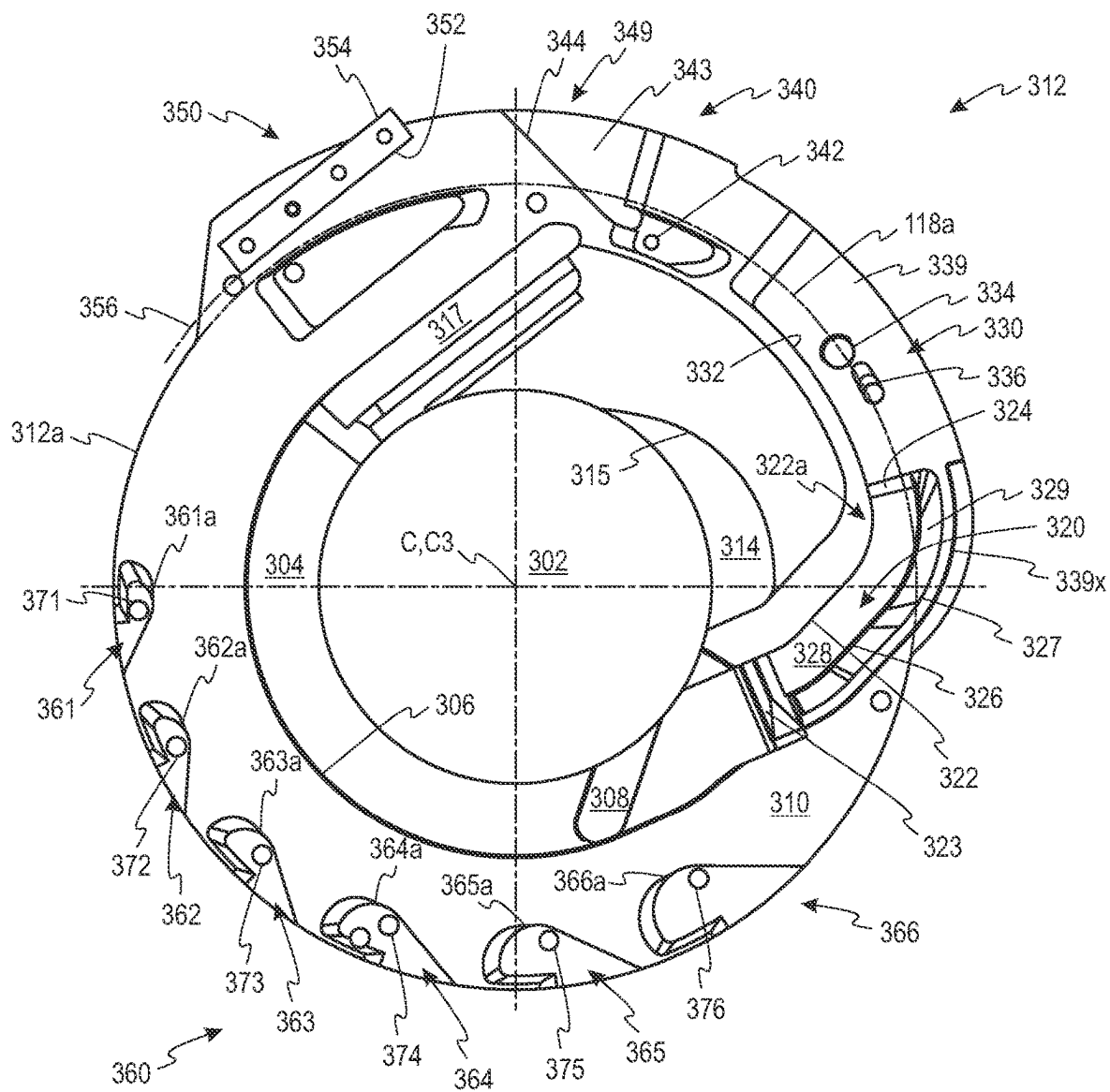

Fig. 3

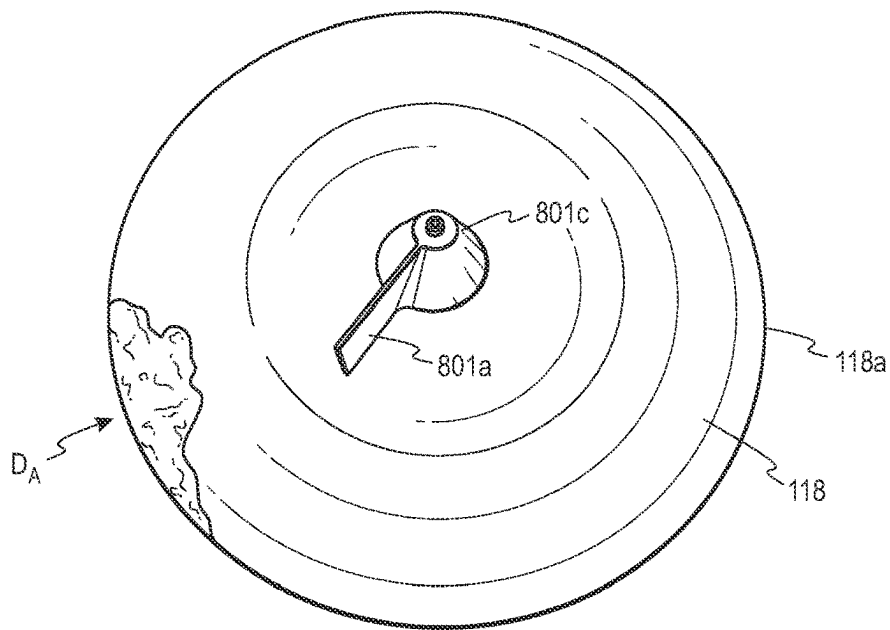

Fig. 4A

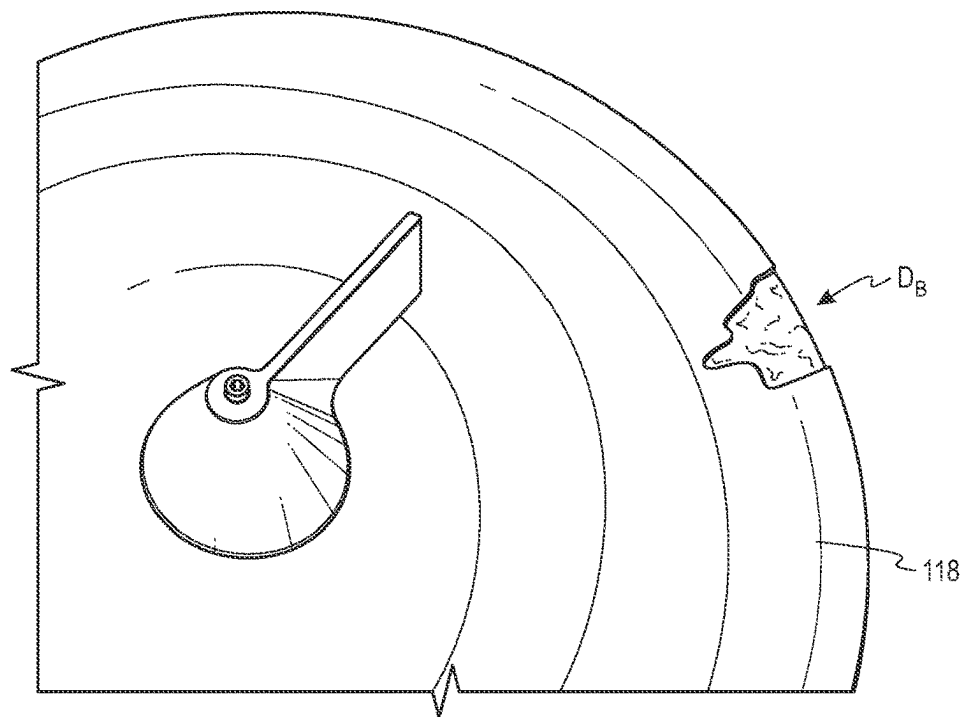

Fig. 4B

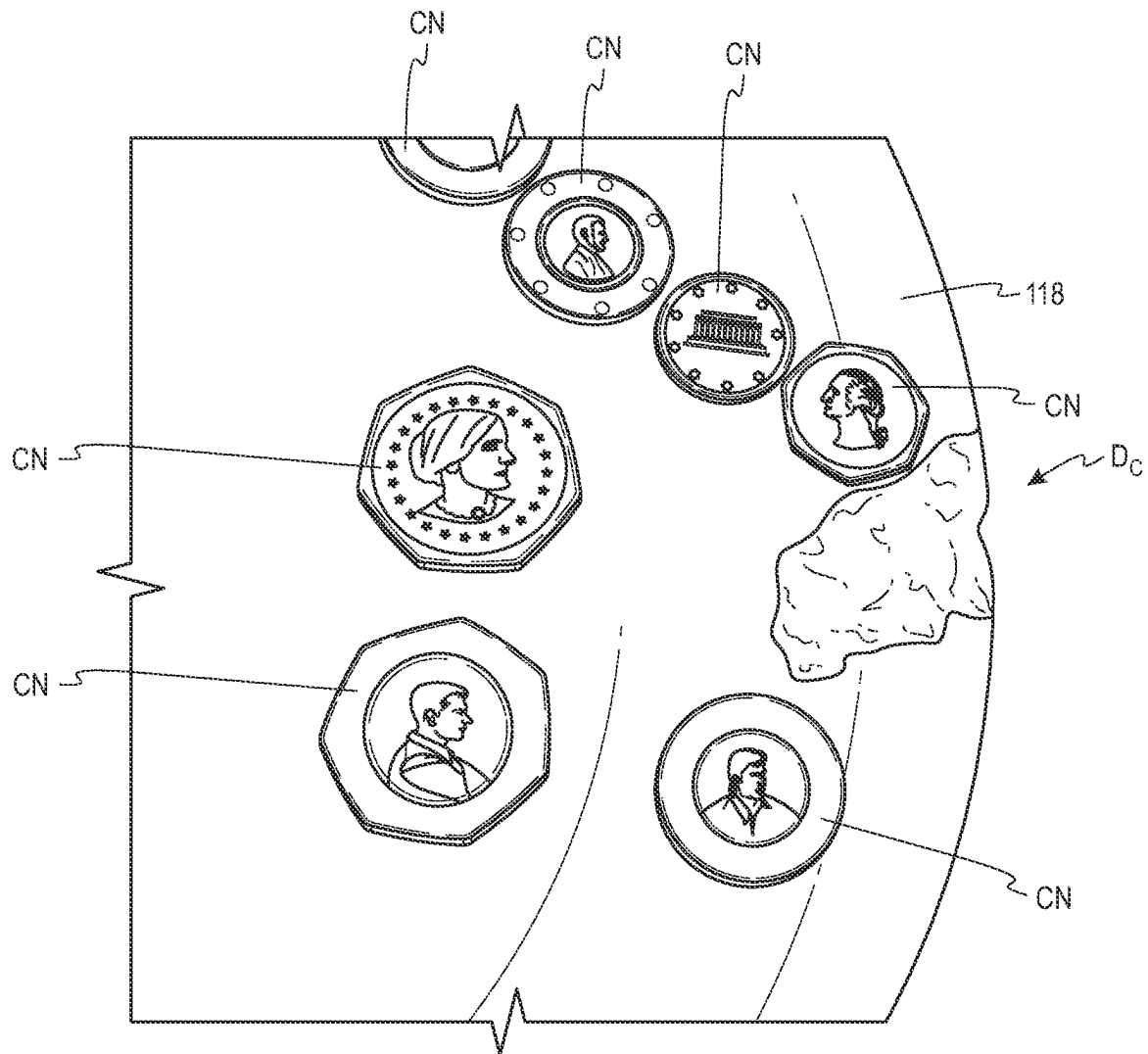

Fig. 4C

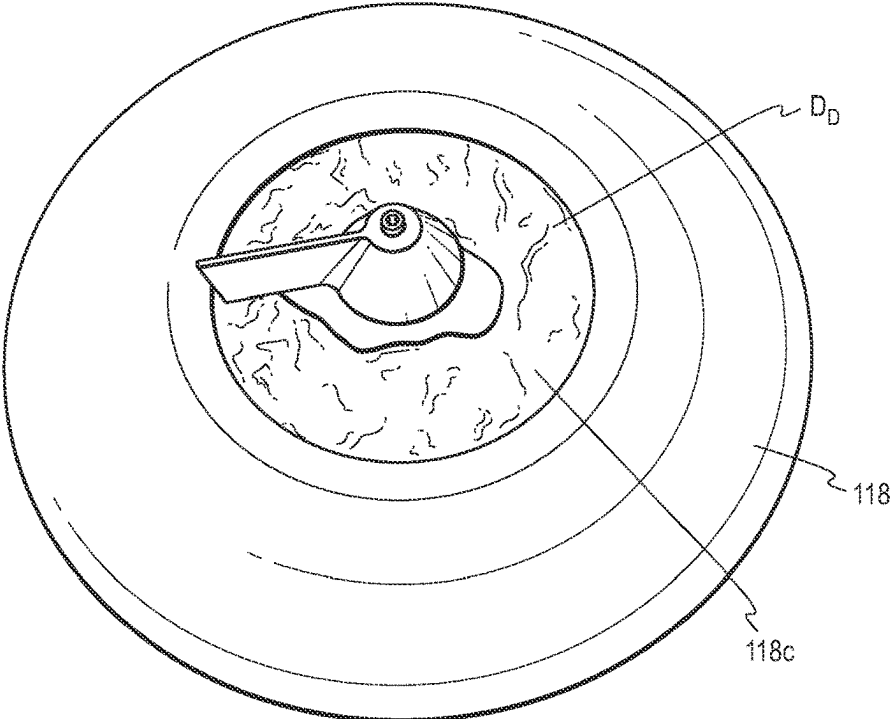

Fig. 4D

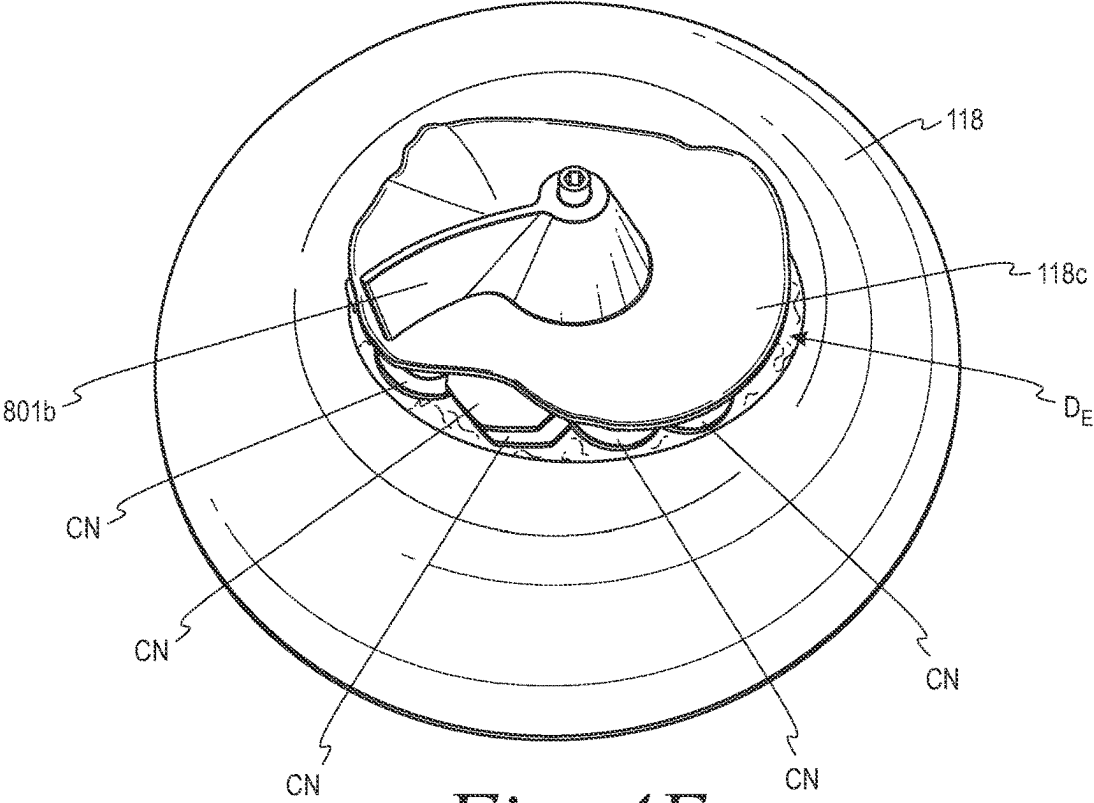

Fig. 4E

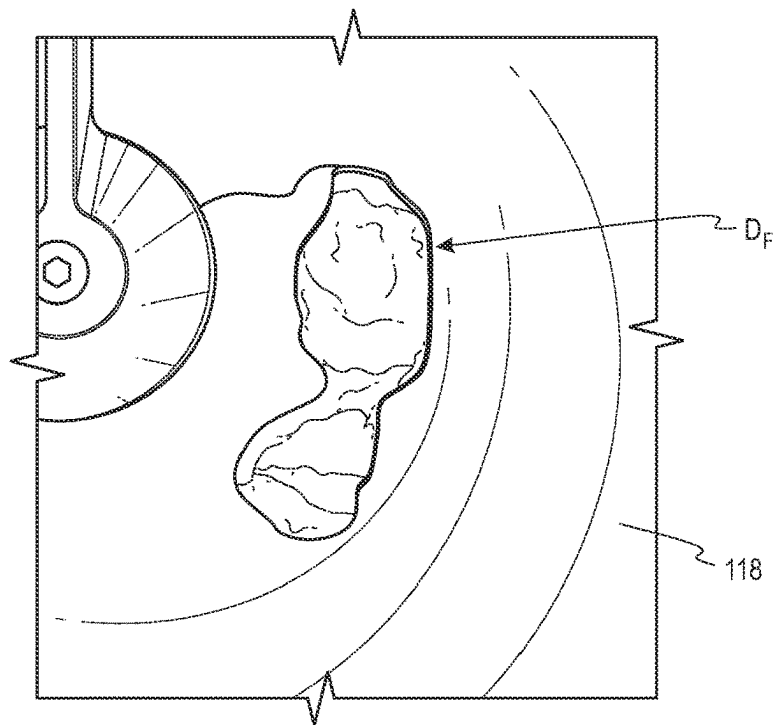

Fig. 4F

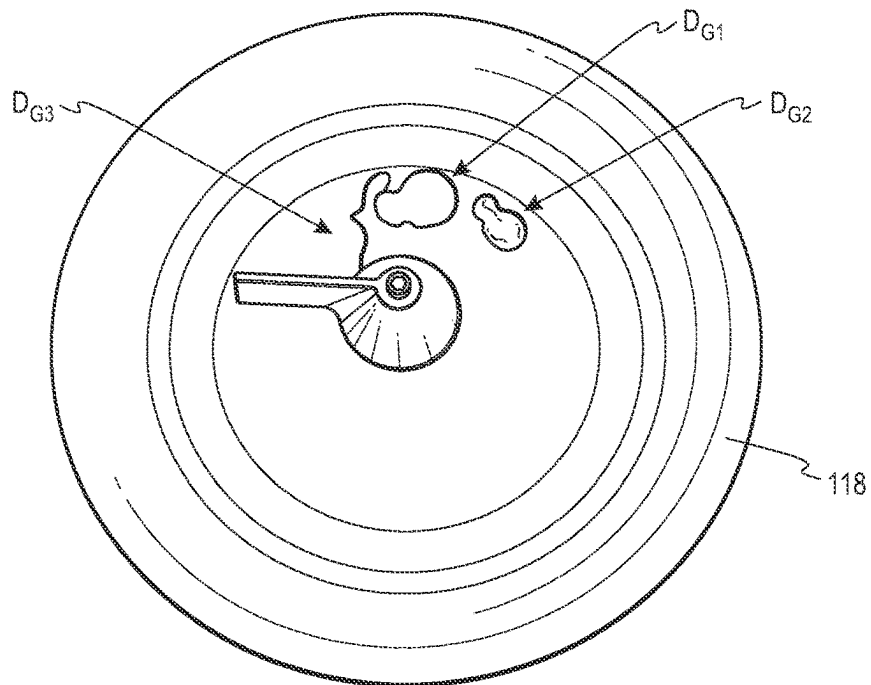

Fig. 4G

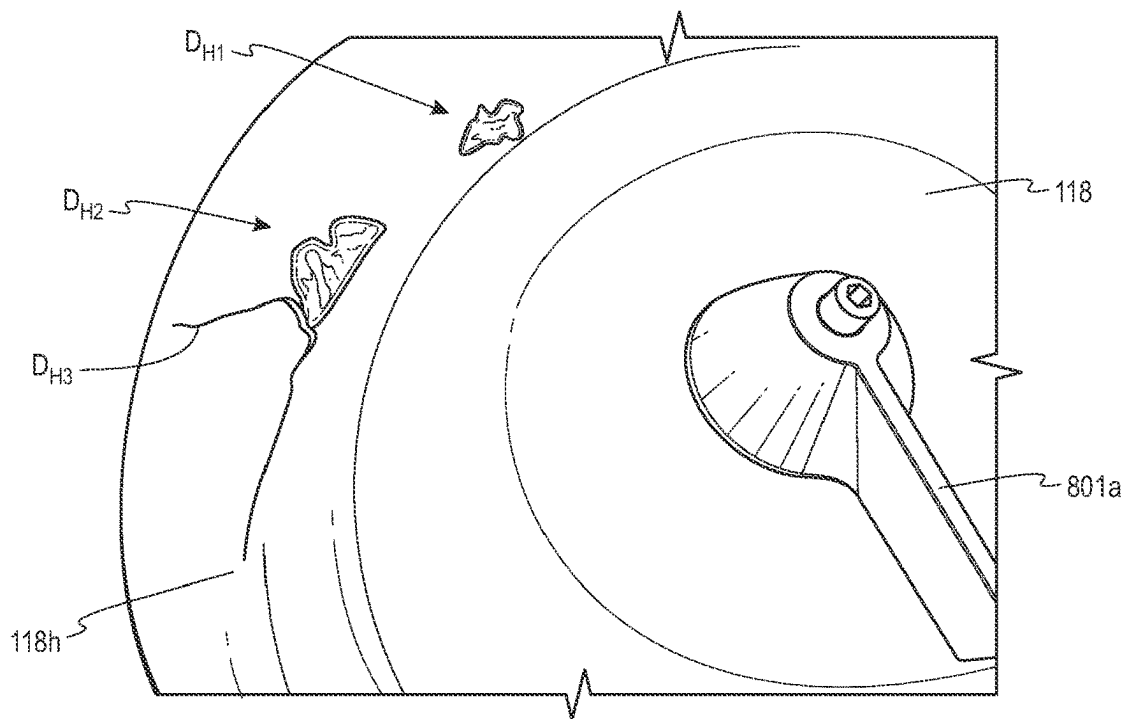

Fig. 4H

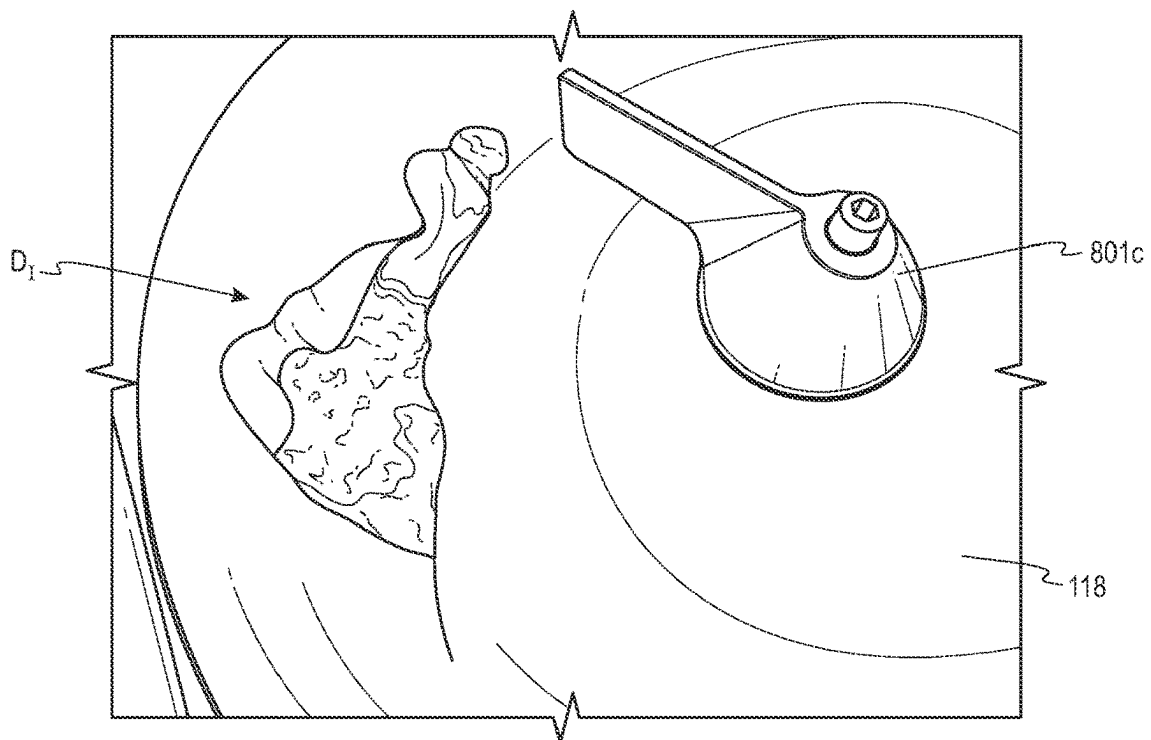
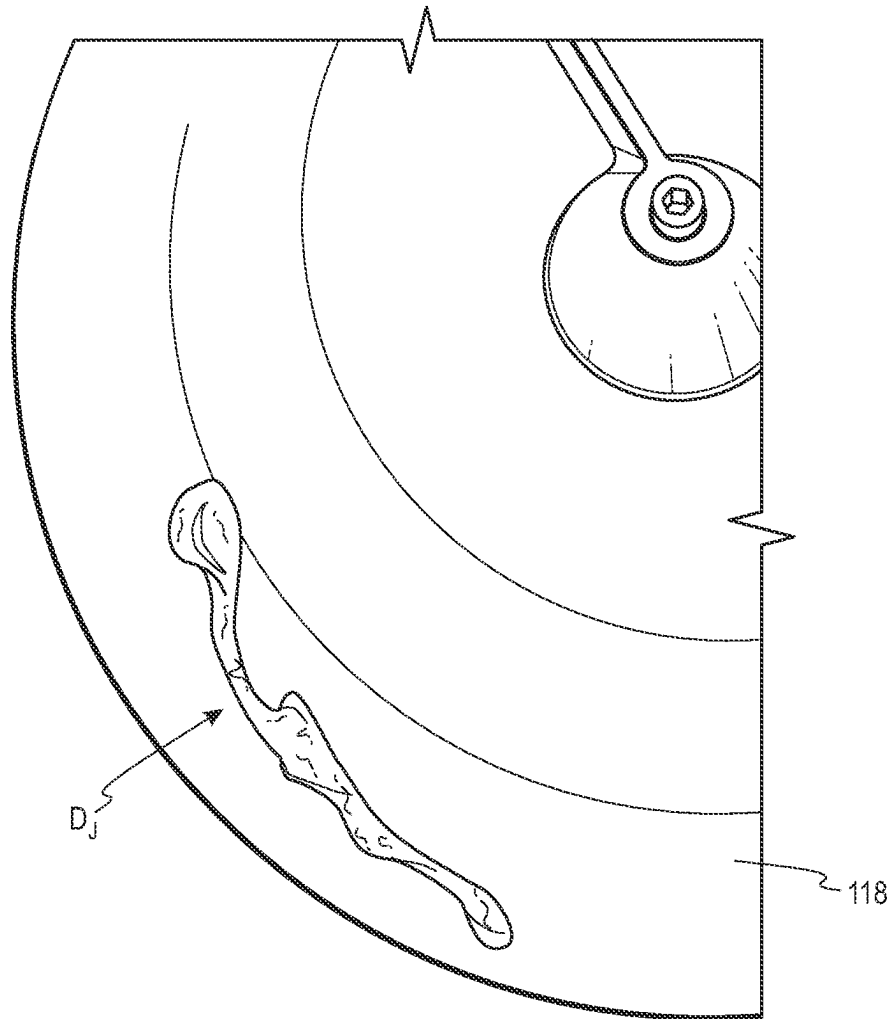

Fig. 4I

*Fig. 4J*

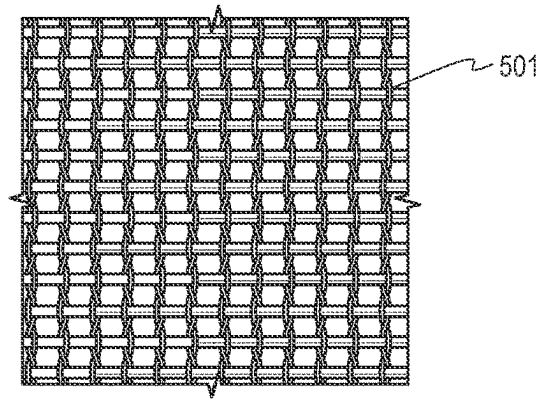

Fig. 5A

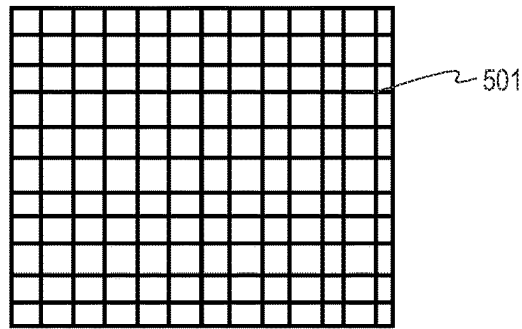

Fig. 5B

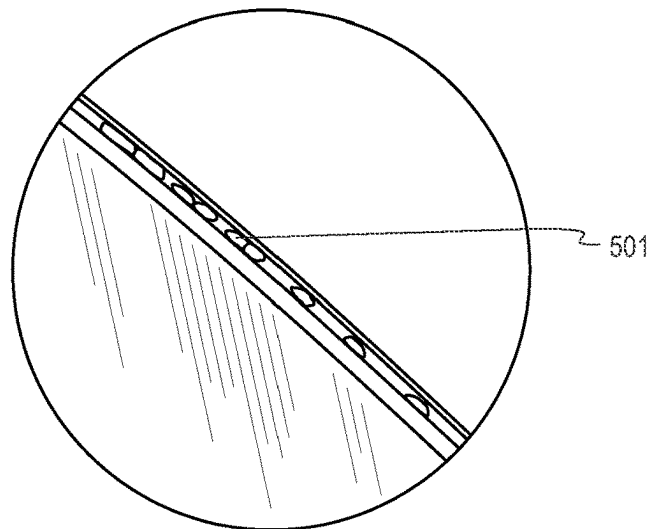

Fig. 5C

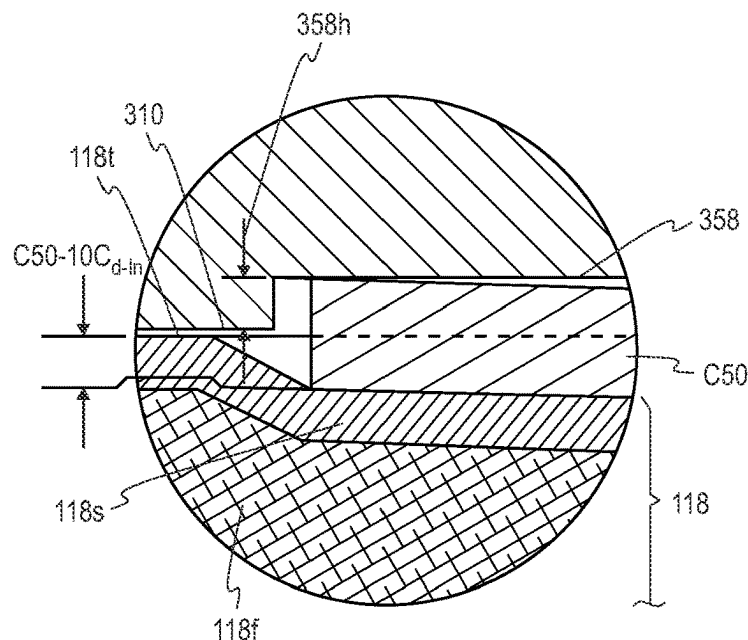

Fig. 5D

OPTION #1	OVERALL HEIGHT - .043"		WARCO 80-P-987 - .028"
			FIBER MESH - .005"
			WARCO 80-P-987 - .010"

OPTION #2	OVERALL HEIGHT - .043"		WARCO 80-P-987 - .019"
			FIBER MESH - CENTERED - .005"
			WARCO 80-P-987 - .019"

OPTION #3	OVERALL HEIGHT - .068"		WARCO 80-P-987 - .053"
			FIBER MESH - .005"
			WARCO 80-P-987 - .010"

Fig. 5E

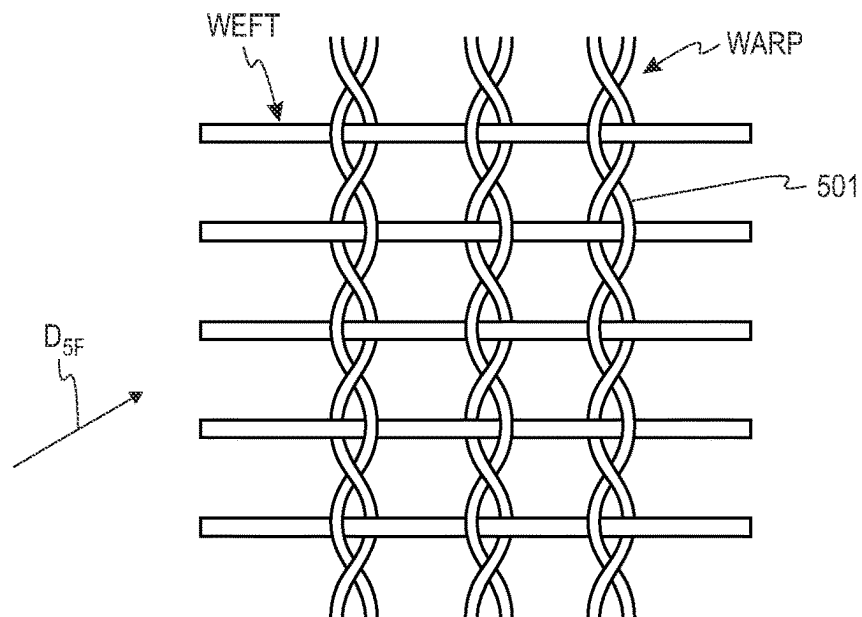

Fig. 5F

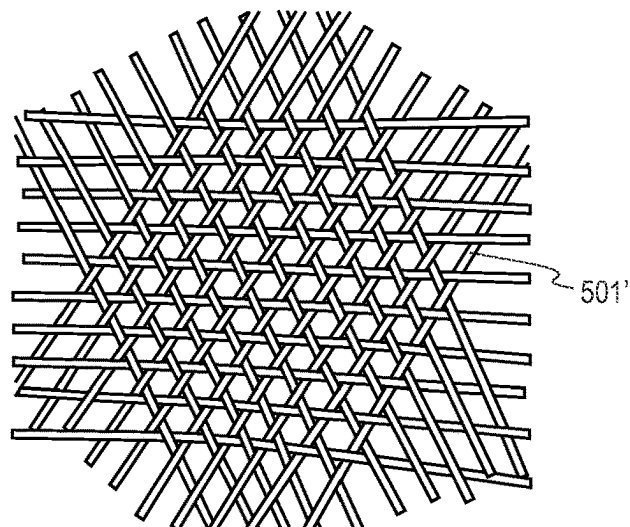

Fig. 5G

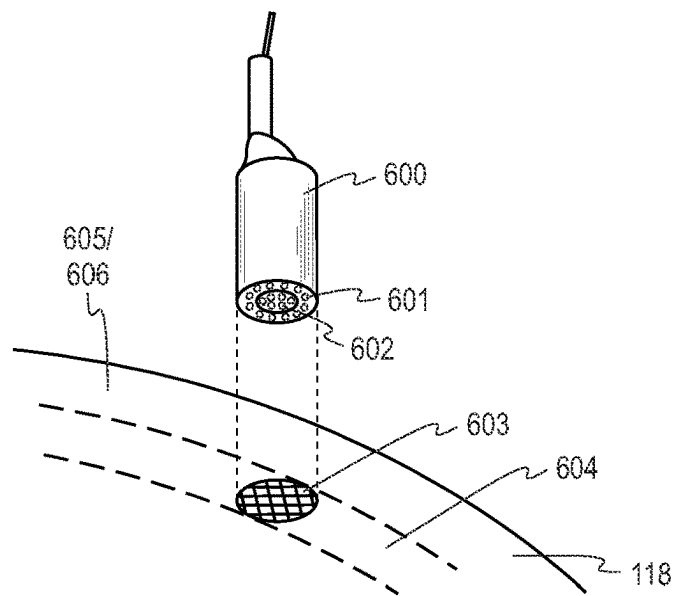

Fig. 6A

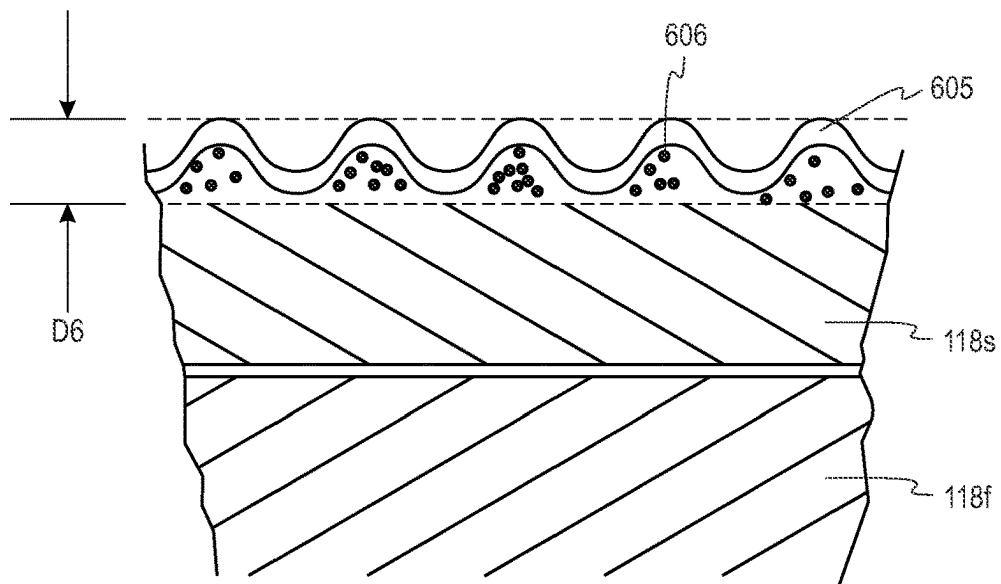

Fig. 6B

Fig. 7A

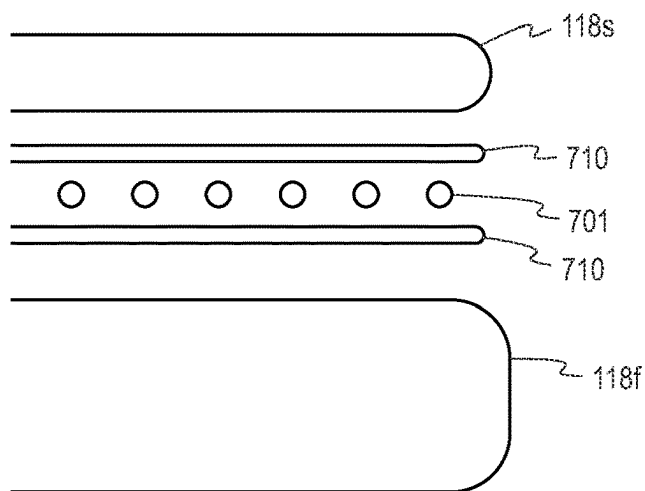

Fig. 7B

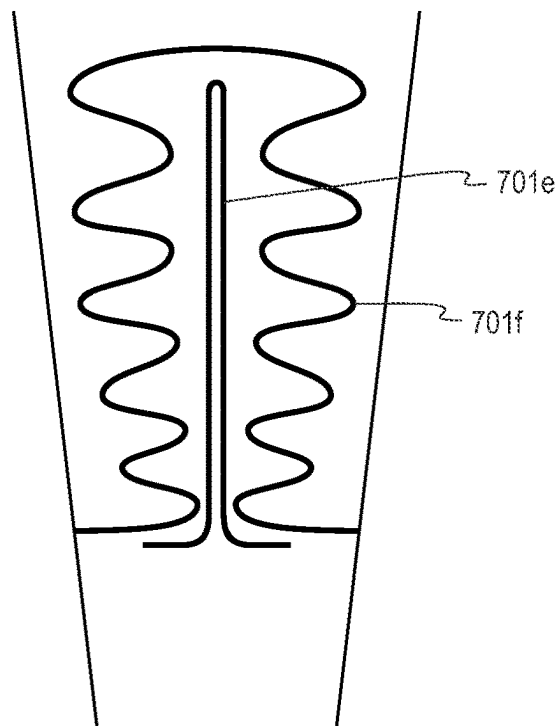
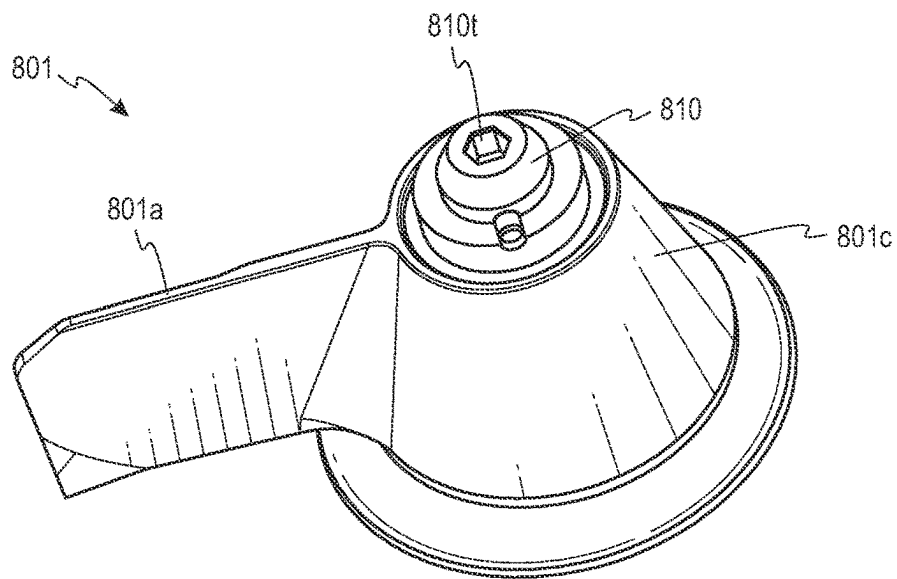
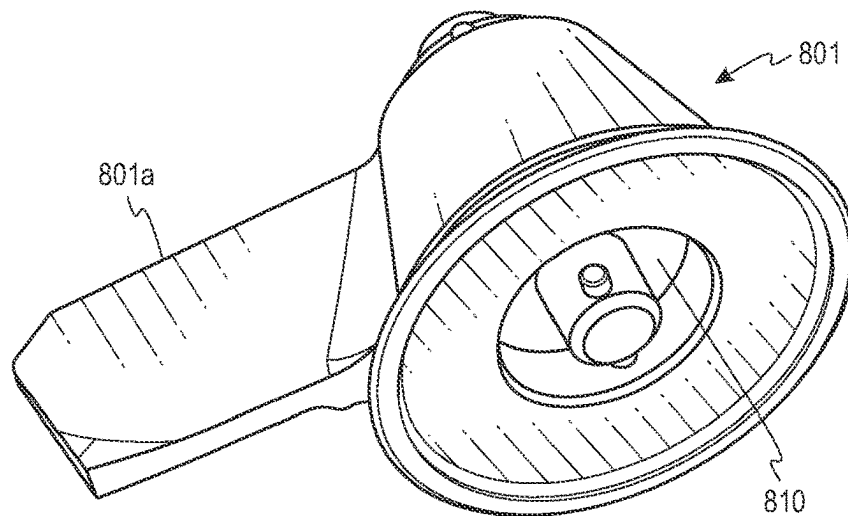

Fig. 7C

*Fig. 8A**Fig. 8B*

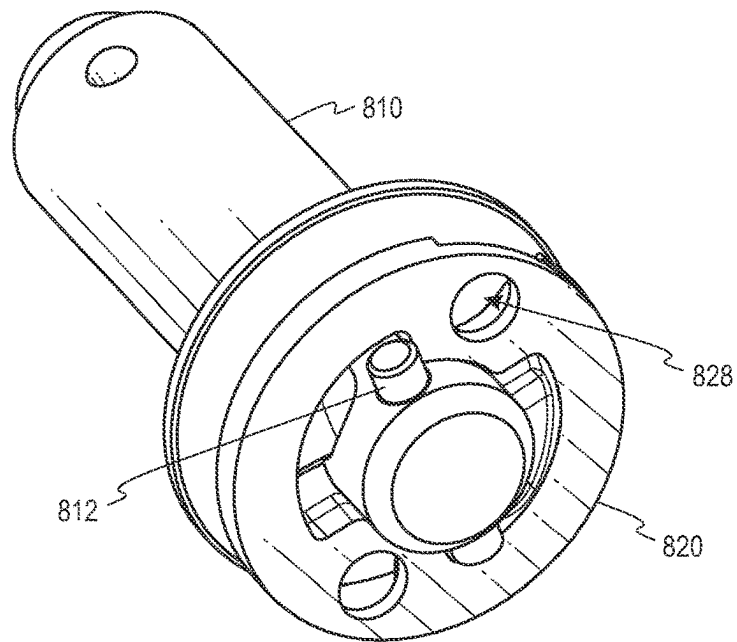

Fig. 8C

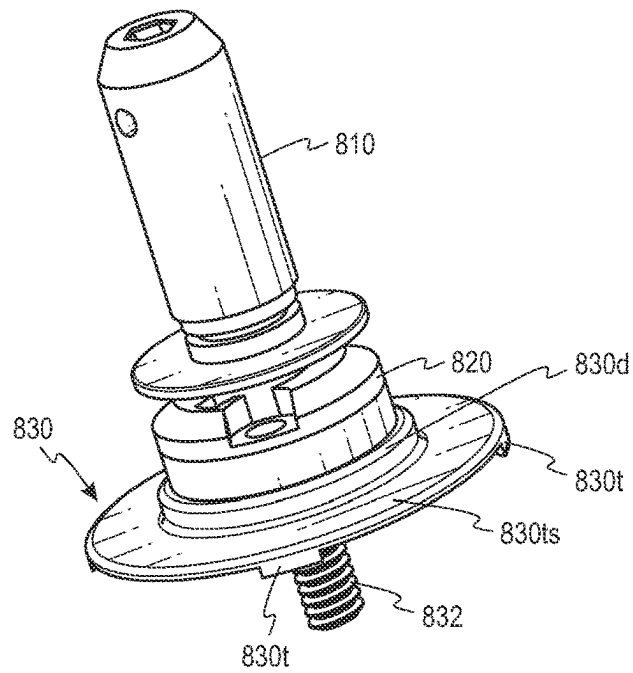

Fig. 8D

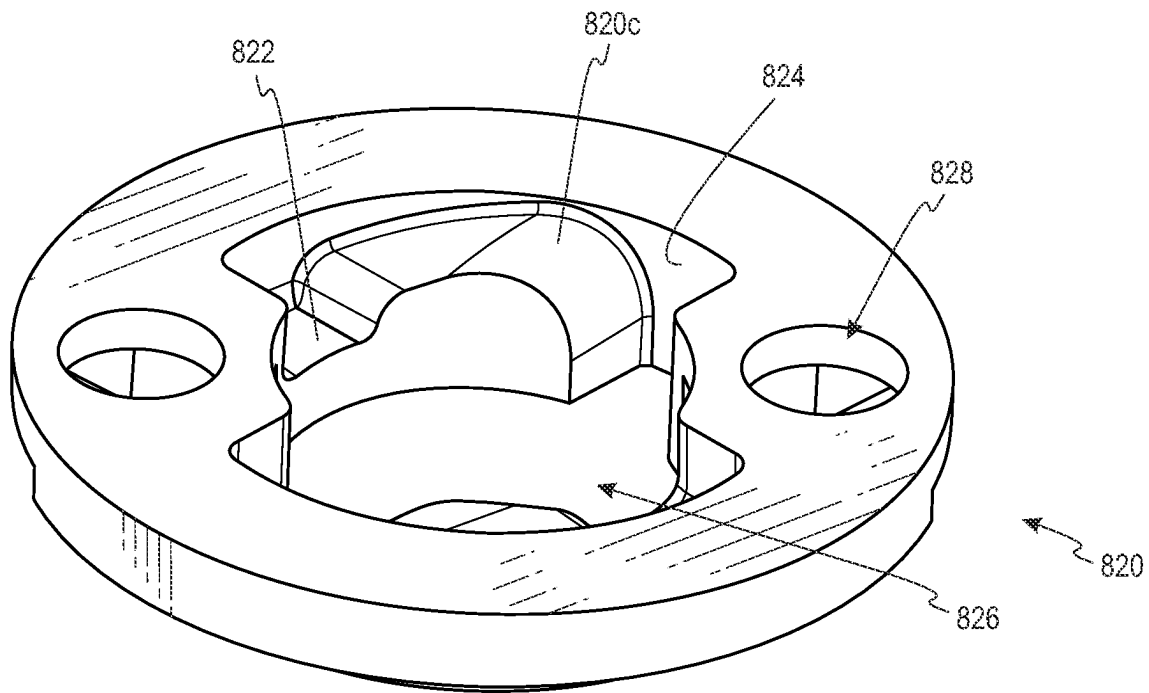

Fig. 8E

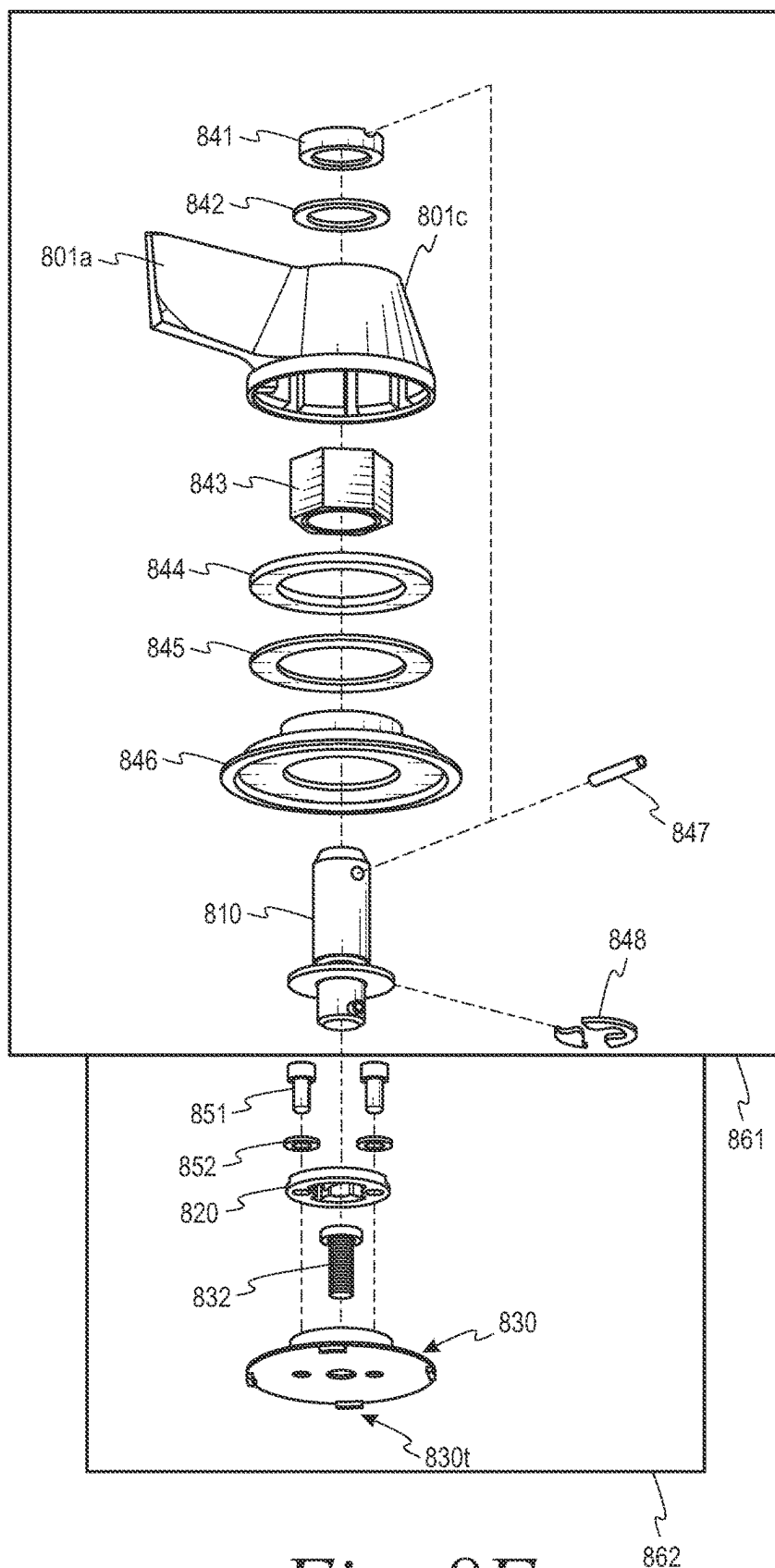

Fig. 8F

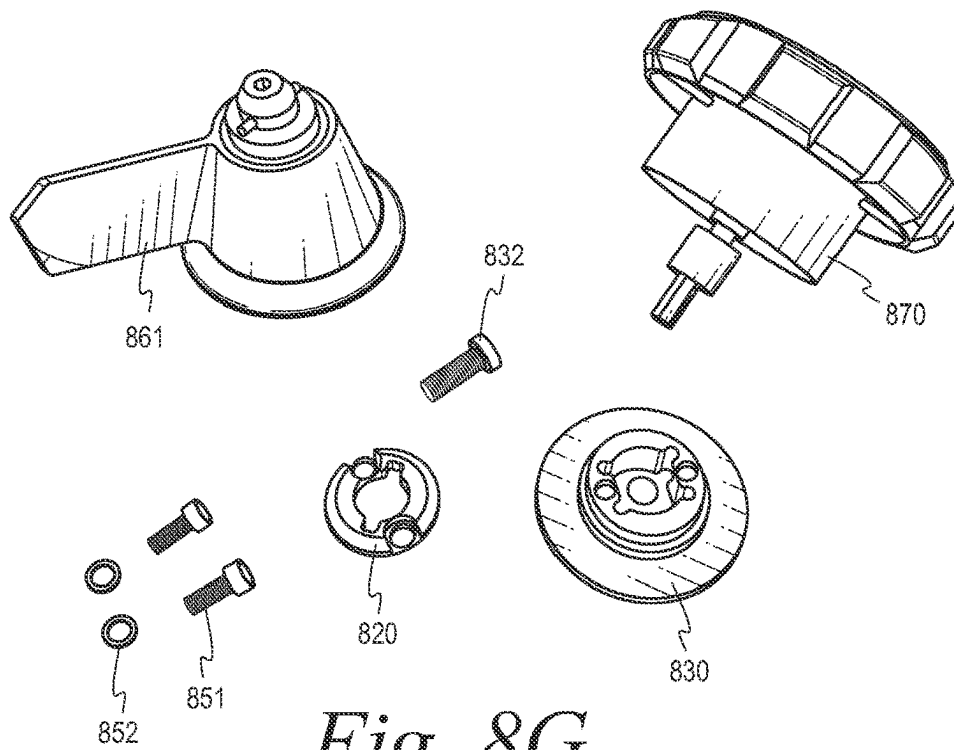

Fig. 8G

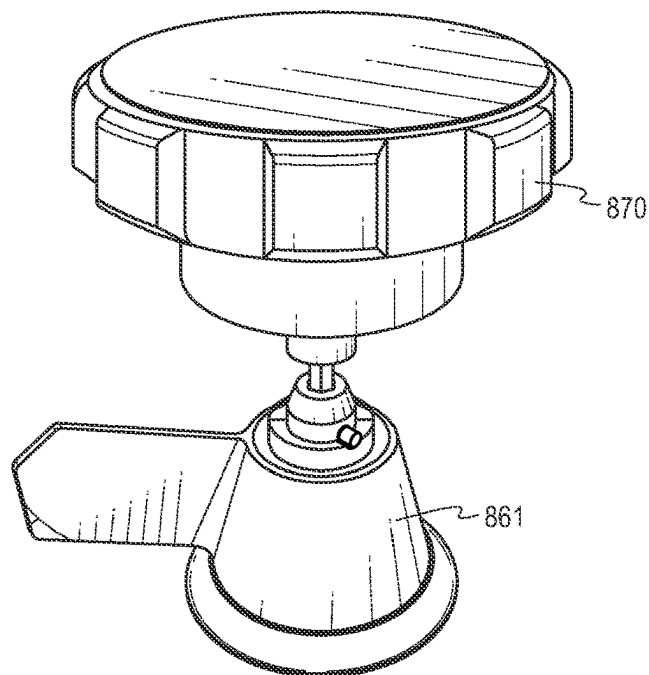

Fig. 8H

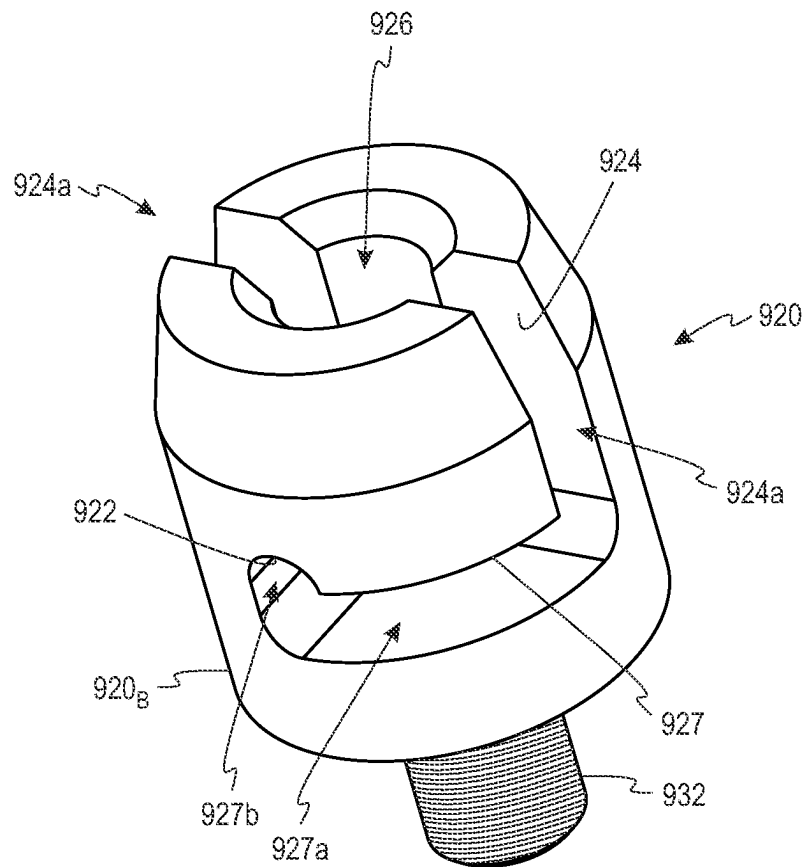

Fig. 9A

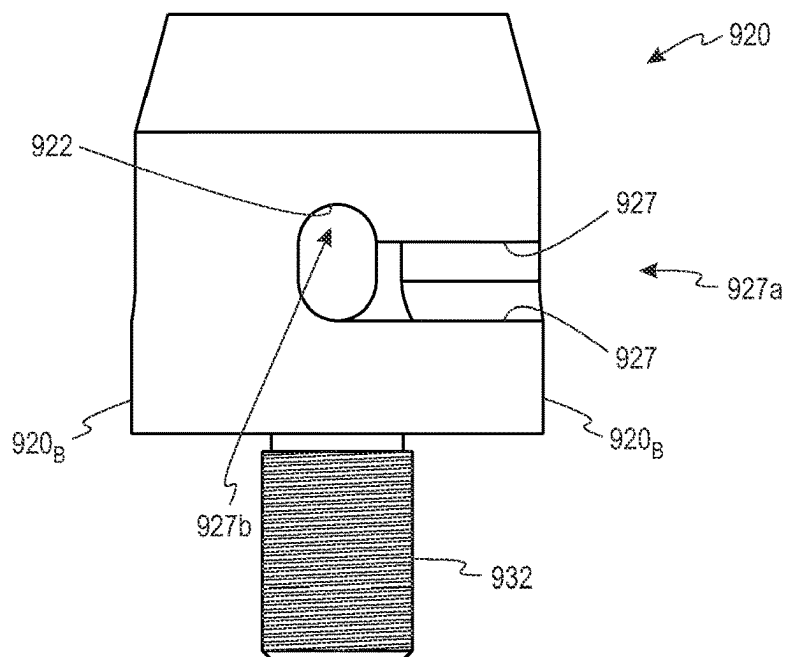

Fig. 9B

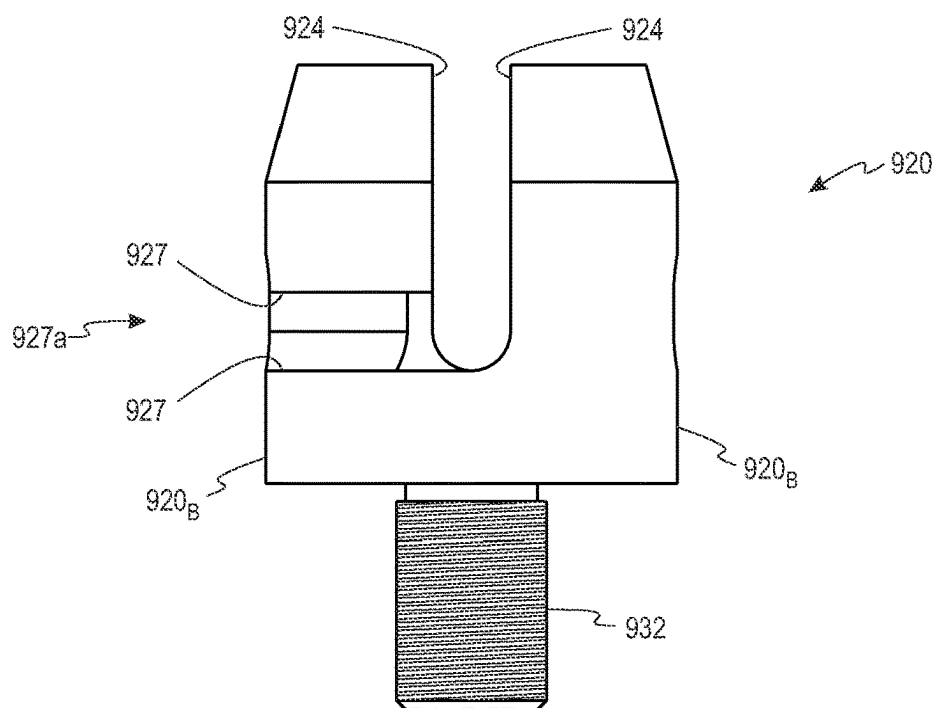

Fig. 9C

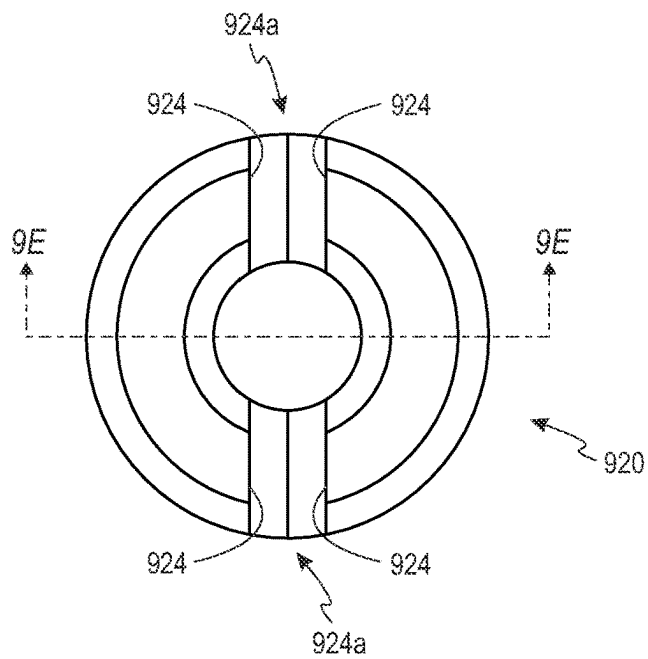

Fig. 9D

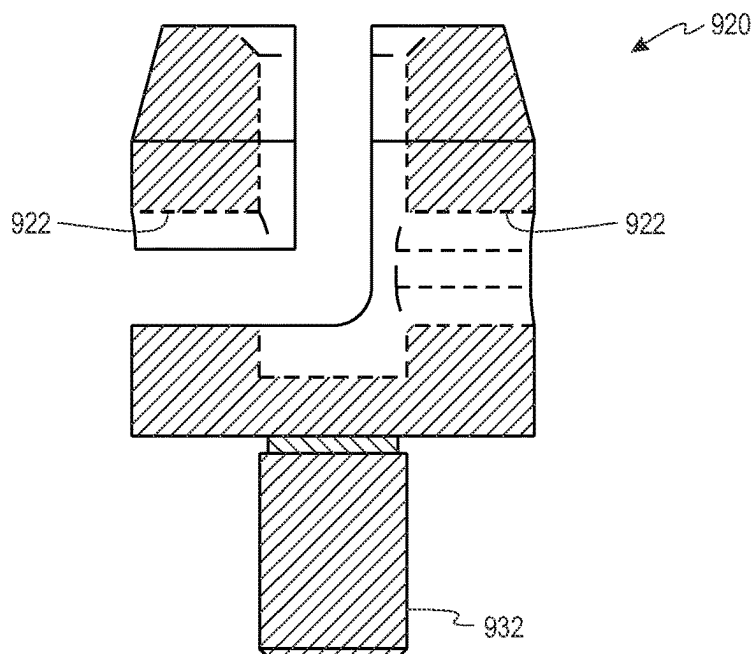

Fig. 9E

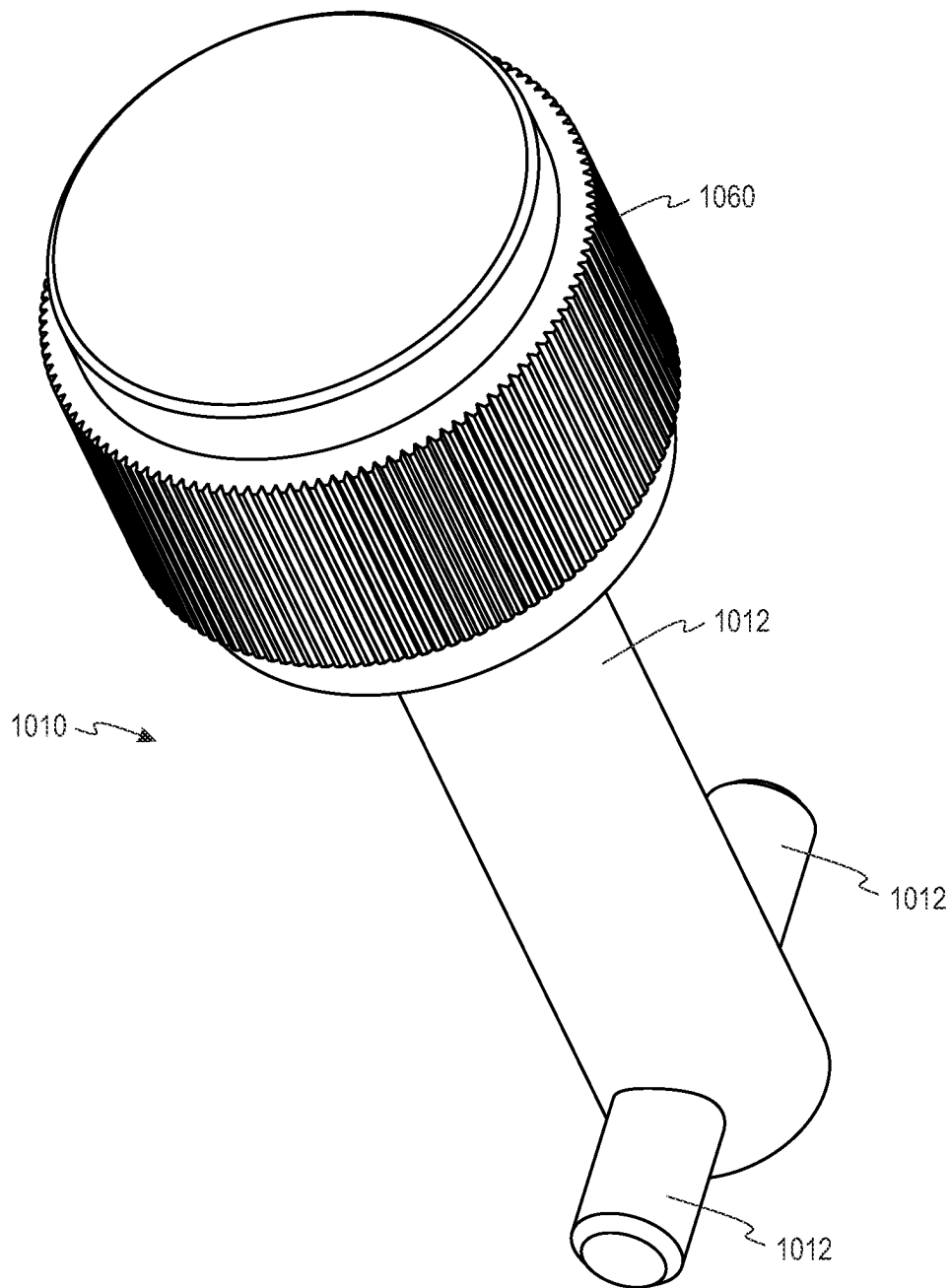
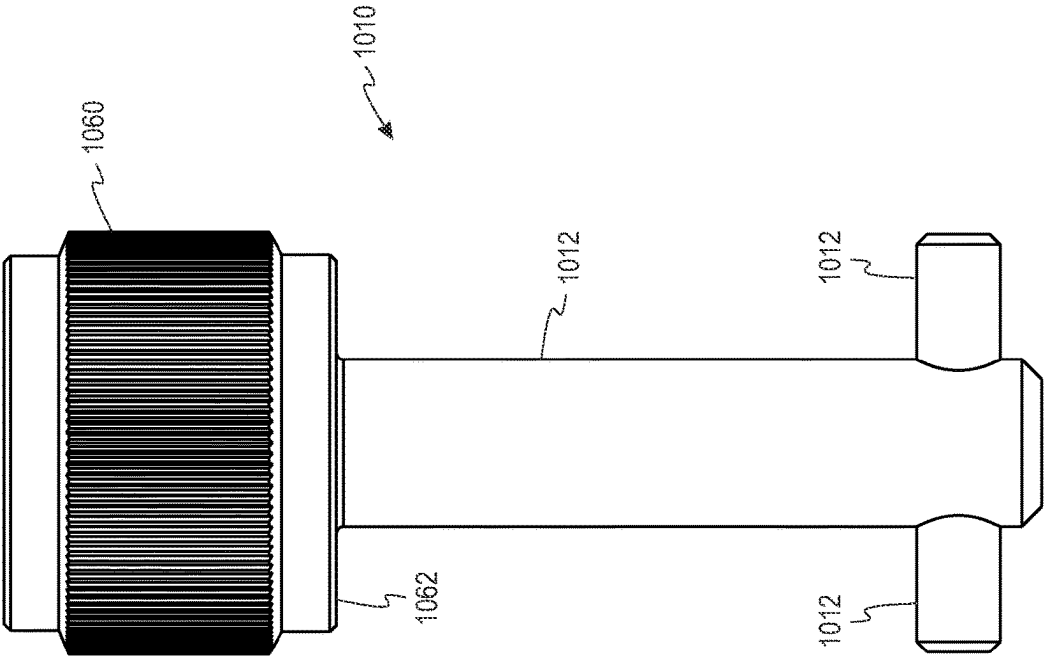
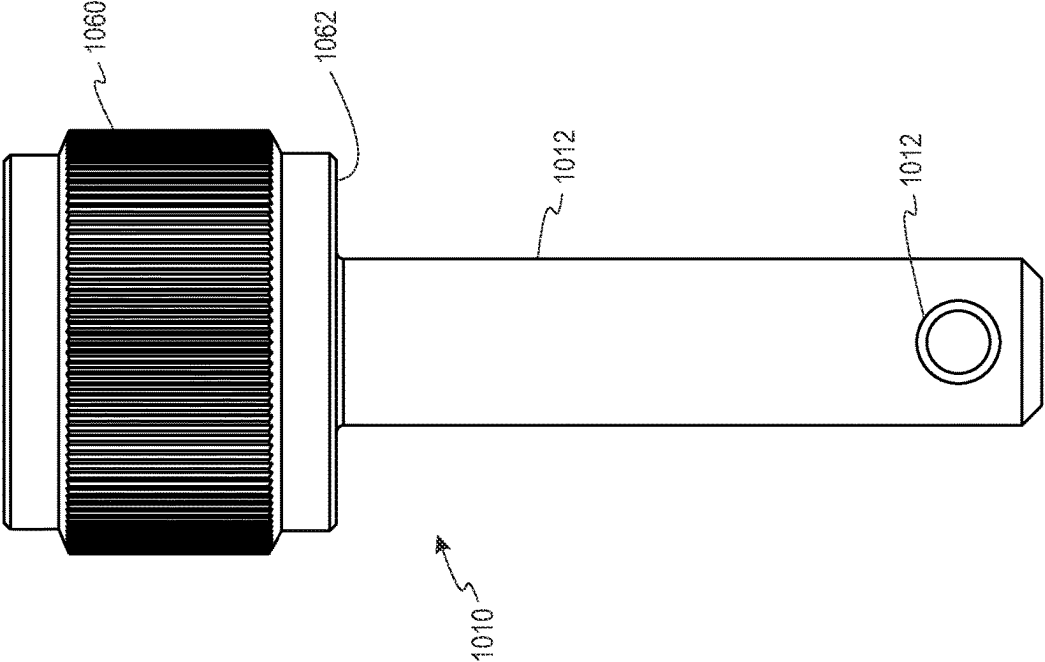
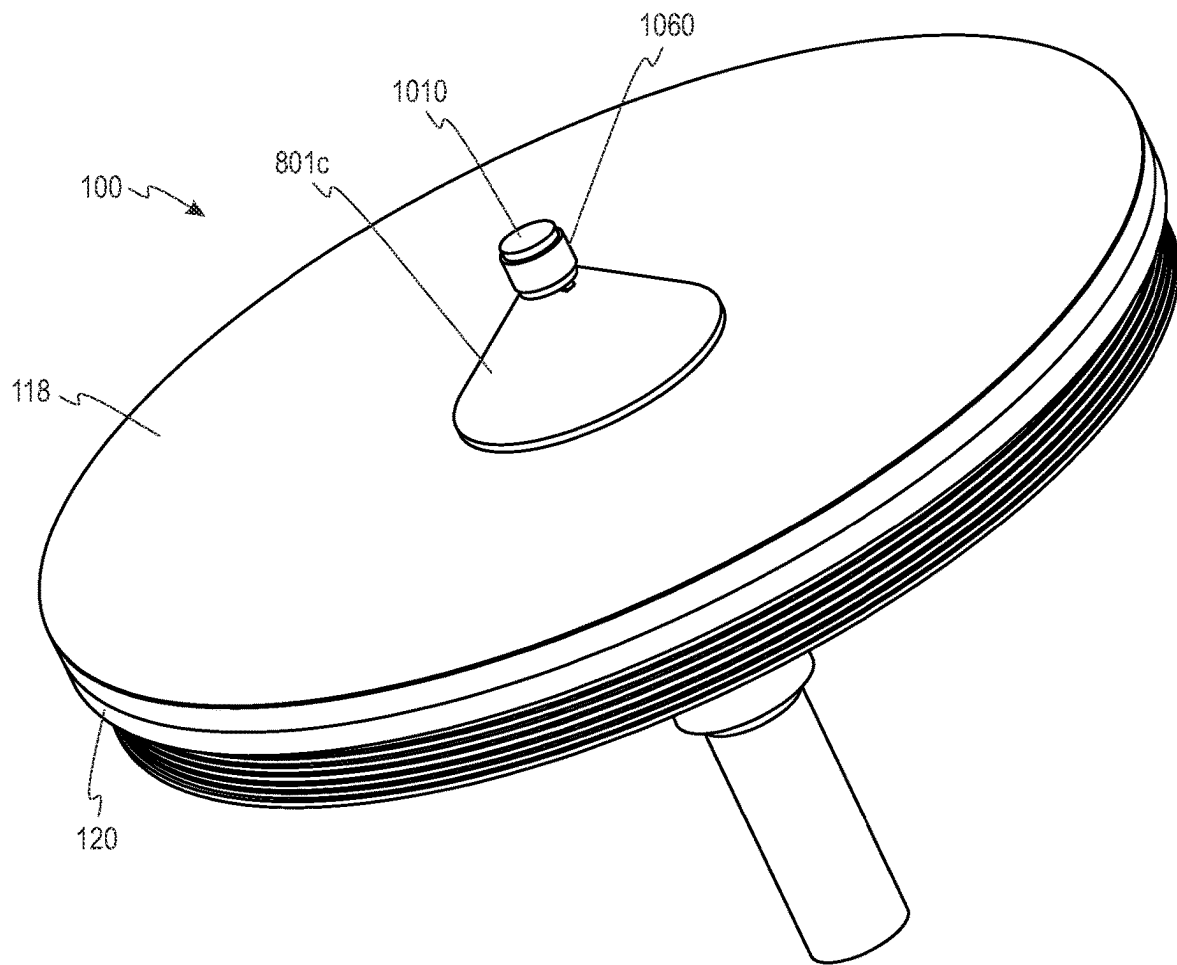

Fig. 10A



*Fig. 11*

1

COIN PAD FOR COIN PROCESSING SYSTEM

CROSS-REFERENCE TO RELATED APPLICATION(S)

This application is a continuation of U.S. patent application Ser. No. 17/816,393, filed Jul. 29, 2022, which is a divisional of U.S. patent application Ser. No. 16/733,494, filed Jan. 3, 2020, which claims priority to U.S. Provisional Patent Application No. 62/788,627, filed Jan. 4, 2019, the disclosures of which are incorporated herein by reference.

TECHNICAL FIELD

The present disclosure relates generally to coin sorting devices and, more particularly, to coin sorters of the type which use a coin-driving member and a coin-guiding member or sorting head for sorting coins of mixed diameters.

BACKGROUND

Generally, disc-type coin sorters sort coins according to the diameter of each coin. Typically, in a given coin set such as the United States coin set, each coin denomination has a different diameter. Thus, sorting coins by diameter effectively sorts the coins according to denomination.

Disc-type coin sorters typically include a resilient pad (disposed on a rotating disc) that rotates beneath a stationary sorting head having a lower surface positioned parallel to the upper surface of the resilient pad and spaced slightly therefrom. The rotating, resilient pad presses coins upward against the sorting head as the pad rotates. The lower surface of sorting head includes a plurality of shaped regions including exit slots for manipulating and controlling the movement of the coins. Each of the exit slots is dimensioned to accommodate coins of a different diameter for sorting the coins based on diameter size. As coins are discharged from the sorting head via the exit slots, the sorted coins may follow respective coin paths to, for example, sorted coin receptacles where the sorted coins are stored.

Although coin sorters have been used for a number of years, problems are still encountered in this technology. For example, as coins are guided by the sorting head, portions of the sorting head and/or pad become worn due to friction between the stationary sorting head and the moving coins.

SUMMARY

According to some embodiments of the present disclosure, a resilient coin sorting pad for imparting motion to a plurality of coins is provided, the resilient pad designed to be coupled to a rotatable disc of a coin sorter, the resilient pad being generally circular and having an outer periphery edge. The resilient pad comprises a lower foam layer having a top surface, an upper skin layer coupled to the top surface of the foam layer, and a layer of mesh material. According to some embodiments, the upper skin layer comprises at least one layer of nitrile rubber and the layer of mesh material is Kevlar® fiber mesh. According to some embodiments, the upper skin layer comprises at least one layer of nitrile rubber and the layer of mesh material is nylon fiber mesh having woven pattern such as a leno or a triaxial weave pattern. According to some embodiments, the upper skin layer comprises at least two layers of nitrile rubber and the layer of mesh material is positioned between the at least two layers of nitrile rubber.

2

The above summary of the present disclosure is not intended to represent each embodiment, or every aspect, of the present disclosure. Additional features and benefits of the present disclosure will become apparent from the detailed description, figures, and claims set forth below.

BRIEF DESCRIPTION OF THE DRAWINGS

FIG. 1A is a perspective view of a coin processing system or coin sorter, according to some embodiments of the present disclosure, with portions thereof broken away to show the internal structure.

FIG. 1B is a functional block diagram of a control system for the coin processing system shown in FIG. 1A;

FIG. 2 is a bottom plan view of a first sorting head for use with the system of FIGS. 1A and 1B;

FIG. 3 is a bottom plan view of a second sorting head for use with the system of FIGS. 1A and 1B;

FIGS. 4A-4J illustrate examples of damage caused to coin sorter pads by non-coin sharp objects;

FIG. 5A and FIG. 5B are top views of a mesh material that may comprise a layer of a coin pad according to some embodiments;

FIG. 5C is a side view of a skin layer having a layer of mesh material embedded therein according to some embodiments;

FIG. 5D is a partial cross-sectional view of a portion of a sorting head illustrating an exemplary coin pressing a portion of a pad downward according to some embodiments;

FIG. 5E illustrates three exemplary options for placement of a mesh layer within a skin layer of a pad according to some embodiments;

FIG. 5F is a top view of an exemplary leno weave pattern for a mesh layer according to some embodiments;

FIG. 5G is a top view of an exemplary triaxial weave pattern for a mesh layer according to some embodiments;

FIG. 6A is a schematic view of a sensor for detecting characteristics of a pad and/or a coin positioned on the pad according to some embodiments;

FIG. 6B is a side sectional view of a portion of a pad comprising a lower foam layer and an upper skin layer and having a detectable coating and/or detectable elements according to some embodiments;

FIG. 7A is a schematic top view of a coin pad having one or more tear detectable elements according to some embodiments;

FIG. 7B is a schematic side view of a coin pad having one or more tear detectable elements according to some embodiments;

FIG. 7C is a schematic top view of exemplary tear detectable elements that may be employed with a coin pad such as, for example, the coin pad illustrated in FIG. 7A;

FIG. 8A is a top perspective view and FIG. 8B is a bottom perspective view of a twist-lock debris blade according to some embodiments;

FIG. 8C is a bottom perspective view of a debris blade post and a retaining washer interface according to some embodiments;

FIG. 8D is a side perspective view of the debris blade post, the retaining washer interface, and a coupler according to some embodiments;

FIG. 8E is a bottom perspective view of a retaining washer interface according to some embodiments;

FIG. 8F is an exploded, perspective view of some components of a twist-lock debris blade assembly and disc mounting assembly according to some embodiments;

3

FIG. 8G illustrates perspective views of parts of a twist-lock debris blade assembly and disc mounting assembly and a post coupling tool according to some embodiments;

FIG. 8H is a perspective view of a post coupling tool engaged with a twist-lock debris blade assembly according to some embodiments;

FIG. 9A is a side perspective view; FIG. 9B is a first side; FIG. 9C is a second side view; FIG. 9D is a top view; and FIG. 9E is a cross-sectional side view of an alternative embodiment of a retaining washer interface according to some embodiments;

FIG. 10A is a perspective view; FIG. 10B is a first side; and FIG. 10C is a second side view of an alternative embodiment of a post coupling tool according to some embodiments; and

FIG. 11 is a perspective view of portions of a coin processing system showing a center cone retaining post holding a center cone against the top of a pad.

While the disclosure is susceptible to various modifications and alternative forms, specific embodiments will be shown by way of example in the drawings and will be desired in detail herein. It should be understood, however, that the disclosure is not intended to be limited to the particular forms disclosed. Rather, the disclosure is to cover all modifications, equivalents and alternatives falling within the spirit and scope of the inventions as defined by the appended claims.

DETAILED DESCRIPTION

Turning now to the drawings and referring first to FIG. 1A, a disc-type coin processing system or coin sorter 100 according to some embodiments of the present disclosure is shown. FIG. 1A is a perspective view of a coin processing system or coin sorter, according to some embodiments of the present disclosure, with portions thereof broken away to show the internal structure. The coin processing system 100 includes a hopper 110 for receiving coins of, for example, mixed denominations that feeds the coins through a central opening in an annular sorting head 112. As the coins pass through this opening, they are deposited on the top surface of a rotatable disc 114. This rotatable disc 114 is mounted for rotation on a shaft (not shown) and driven by an electric motor 116. The disc 114 typically comprises a resilient pad 118, preferably made of a resilient rubber or polymeric material, bonded to the top surface of a solid disc 120. While the solid disc 120 is often made of metal, it can also be made of a rigid polymeric material.

According to some embodiments, coins are initially deposited by a user or operator in a coin tray (not shown) disposed above the coin processing system 100 shown in FIG. 1A. The user lifts the coin tray which funnels the coins into the hopper 110. A coin tray suitable for use in connection with the coin processing system 100 is described in detail in U.S. Pat. No. 4,964,495, which is incorporated herein by reference in its entirety.

As the disc 114 is rotated, the coins deposited on the resilient pad 118 tend to slide outwardly over the surface of the pad 118 due to centrifugal force. As the coins move outwardly, those coins which are lying flat on the pad 118 enter a gap between the surface of the pad 118 and the sorting head 112 because the underside of the inner periphery of the sorting head 112 is spaced above the pad 118 by a distance which is about the same as the thickness of the thickest coin the coin sorter 100 is designed to sort. The coins are processed and sent to exit stations or channels where they are discharged. The coin exit stations or channels

4

may sort the coins into their respective denominations and discharge the coins from the sorting head 112 corresponding to their denominations.

FIG. 1B is a functional block diagram of a control system for the coin processing system 100 shown in FIG. 1A which may be employed with the sorting heads 112, 212, 312 to be subsequently described. FIG. 1B illustrates a system controller 180 and its relationship to the other components in the coin processing system 100. More details regarding a system controller 180 and its relationship to the other components in the coin processing system 100 are described in U.S. Pat. No. 7,743,902, which is incorporated herein by reference in its entirety. But briefly, an operator of system 100 communicates with the coin processing system 100 via an operator interface 182 which is configured to receive information from the operator and display information to the operator about the functions and operation of the coin processing system 100. The controller 180 monitors the angular position of the disc 114 via an encoder 184 which sends an encoder count to the controller 180 upon each incremental movement of the disc 114. Based on input from the encoder 184, the controller 180 determines the angular velocity at which the disc 114 is rotating as well as the change in angular velocity, that is, the acceleration and deceleration, of the disc 114. The encoder 184 allows the controller 180 to track the position of coins on the sorting head 112, 212 or 312 after being sensed. According to some embodiments of the coin processing system 100, the encoder has a resolution of 40,000 pulses per revolution of the disc 114.

The controller 180 also controls the power supplied to the motor 116 which drives the rotatable disc 114. When the motor 116 is a DC motor, the controller 180 can reverse the current to the motor 116 to cause the rotatable disc 114 to decelerate. Thus, the controller 180 can control the speed of the rotatable disc 114 without the need for a braking mechanism. If a braking mechanism 186 is used, the controller 180 also controls the braking mechanism 186. Because the amount of power applied is proportional to the braking force, the controller 180 has the ability to alter the deceleration of the disc 114 by varying the power applied to the braking mechanism 186.

FIG. 2 is a bottom plan view of a first exemplary sorting head for use with the system of FIGS. 1A and 1B and FIG. 3 is a bottom plan view of a second exemplary sorting head for use with the system of FIGS. 1A and 1B. The sorting heads 212 and 312 and the operation of system of FIGS. 1A and 1B employing these sorting heads are described in more detail in U.S. patent application Ser. No. 15/782,343 filed Oct. 12, 2017, now issued as U.S. Pat. No. 10,181,234, each of which is incorporated herein by reference in its entirety.

In FIGS. 2-3, the underside of sorting heads 212, 312 are shown. The coin sets for any given country are sorted by the sorting heads 212, 312 due to variations in the diameter size. The coins circulate between the sorting head 212, 312 and the pad 118 (FIG. 1A) on the rotatable disc 114 (FIG. 1A). The pad 118 has a circular surface with a center at C. The sorting head 212, 312 has a circular portion centered at point C2, C3 which corresponds with the center C of pad 118. The coins are deposited on the pad 118 via a central opening 202, 302 and initially enter an entry area 204, 304 formed in the underside of the sorting head 212, 312. It should be kept in mind that the circulation of the coins in FIGS. 2-3 appear counterclockwise as FIGS. 2-3 are views of the underside of the sorting heads 212, 312.

The sorting heads 212, 312 may include a cutout for a discrimination sensor 234, 334. The discrimination sensor 234, 334 may be disposed flush with a flat surface 239, 339

5

of a discrimination region **230, 330** or recessed slightly within the sorting head just above the flat surface **239, 339** of the discrimination region **230, 330**. Likewise, a coin trigger sensor **236, 336** is disposed just upstream of the discrimination sensor **234, 334** for detecting the presence of a coin. Coins first move over the coin trigger sensor **236, 336** (e.g., a photo detector or a metal proximity detector) which sends a signal to a controller (e.g., controller **180**) indicating that a coin is approaching the coin discrimination sensor **234, 334**. According to some embodiments, the sensor **236, 336** is an optical sensor which may employ a laser to measure a chord of passing coins and/or the length of time it takes the coin to traverse the sensor **236, 336** and this information along with the information from the coin discrimination sensor is used to determine the diameter, denomination, and validity of a passing coin. Additional description of such embodiments may be found in U.S. Pat. No. 7,743,902, incorporated herein by reference in its entirety.

According to some embodiments, the coin discrimination sensor **234, 334** is adapted to discriminate between valid and invalid coins. Use of the term “valid coin” refers to coins of the type the sorting head is designed or configured to sort. Use of the term “invalid coin” refers to items being circulated on the rotating disc that are not one of the coins the sorting head is designed to sort. Any truly counterfeit coins (i.e., a slug) are always considered “invalid.” According to another alternative embodiment of the present disclosure, the coin discriminator sensor **234, 334** is adapted to identify the denomination of the coins and discriminate between valid and invalid coins.

Some coin discrimination sensors suitable for use with the disc-type coin sorter **100** shown in FIGS. 1A-3 are described in detail in U.S. Pat. Nos. 7,743,902; 5,630,494; and 5,743,373, each of which is incorporated herein by reference in its entirety. Another coin discrimination sensor suitable for use with the present disclosure is described in detail in U.S. Pat. No. 6,892,871, which is incorporated herein by reference in its entirety. Other coin discrimination sensors suitable for use with the present disclosure are described in detail in U.S. Pat. Nos. 9,430,893; 9,508,208; 9,870,668; 10,068,406; 9,501,885; 9,916,713; and 10,685,523.

In disc-type coin processing systems or coin sorters **100** such as those shown in FIGS. 1A, 1B, 2 and 3, processing of coins without errors or interruptions and/or preventing interference can be very important. In many applications such as in self-service coin applications in which a customer deposits coins into a coin sorter system or sorter **100** (as opposed to an employee depositing coins into the coin sorter system or sorter **100**), maintaining uptime may be important as these machines are a source of revenue for their owner. Component failures can result in costly service calls. One particular high frequency of failure component is the coin sorting pad **118**.

In some environments or applications, such as for example, in some self-service applications, bulk coin that is received from users (patrons or customers) can contain non-coin materials. Although coin processing systems or sorters **100** may employ one or more methods of debris management to remove, cull or minimize debris getting onto the pad **118**, debris, particularly sharp objects (screws, paperclips, nails, etc.), that, nonetheless, makes its way to the sort pad **118** can stall, tear, rip, ripple, puncture, and/or stretch, etc. the pad **118**. Resulting damage to the pad **118** can affect the processing capabilities of the coin processing system or sorter **100** and/or interfere with accurate authentication, counting, sorting and general processing of coins, and/or may ultimately result in the coin processing system or

6

sorter **100** being unusable, forcing a service call where a technician would repair the coin processing system or sorter **100** by replacing the pad **118**.

Coin processing in the coin processing system or sorter **100** relies on the pad **118** to drive the coins under the sort head **212, 312** past a series of grooves and undulations in a predetermined method to authenticate, count and/or direct coins into one or more coin receptacles such as mixed denomination or denomination-specific containers. The process relies on a good quality flat pad to ensure control of the coins. When debris and other non-coin materials enter the system, the pad **118** can tear, rip, gouge, ripple, and/or stretch, affecting the accuracy of the coin processing system or sorter **100**. The damage to the pad **118** can cause problems in the ability to process the coins.

Some coin processing systems or coin sorters **100** employ a pad **118** made from a nitrile rubber rubber-based material. While such material may provide good coin sorting performance, it may also be very susceptible to tears, gouges, rips, punctures, stretching, etc., when debris (sharp debris) is deposited onto the pad **118**. As a result, such pad material, when punctured, may tear very easily, propagating the puncture to the point that the coin processing system or sorter **100** is quickly rendered un-usable. Some exemplary damage to coin sorter pads **118** caused by non-coin sharp objects is illustrated in FIGS. 4A-4J. More particularly, FIGS. 4A-4C illustrate examples of damage such as gouges or tears DA, DB, DC near an edge **118a** of a pad **118**; FIGS. 4D-4G illustrate examples of damage such as tears or gouges DD, DE, DF to a center portion **118c** of a pad **118**; and FIGS. 4H-4J illustrate examples of damage such as tears to portions **118h** of a pad **118** under a sorting head such as sorting head **212, 312**. In FIG. 4E, coins CN have accumulated under the center portion **118c** of the pad **118** after a top portion of the center portion **118c** has been torn away from a bottom portion of the pad **118**. In FIG. 4F, a gouged-out area DF is illustrated along with a tear extending from the gouged-out area DF toward the center of the pad **118**. In FIG. 4G, a gouged-out area DG2 is illustrated along with a tear DG3 extending from a damaged area DG1 toward the center of the pad **118**. In FIG. 4H, gouged-out areas DH1, DH2 are illustrated along with a bent-shaped tear DH3 extending from the gouged-out area DH2 toward the edge of the pad **118** and having a top portion or layer of the pad near the gouged-out area DH2 that has separated from a bottom portion or layer of the pad. In FIG. 4I, a gouged-out area DI is illustrated along with a tear extending from an edge of the gouged-out area DI. In FIG. 4J, a gouged-out area DJ is illustrated.

In some environments or applications, such as for example, in some self-service applications, failures caused by pad damage from non-coin, sharp objects may typically occur within 400,000 coins processed on average. In some environments, such as for example, in some self-service applications, failures caused by pad damage from non-coin, sharp objects may occur within the processing of 100,000-800,000 coins. In contrast, in some environments, such as, for example, in some attended applications in which a trained operator feeds coins into a coin hopper **110**, failures caused by pad damage from non-coin, sharp objects may be much rarer and coin pad **118** may last for the processing of as many as 4-6 million coins, with typical pad life ranging from 1.5 million coins to 4 million coins. A typical service interval for the coin processing systems or coin sorters **100** where a technician visits to perform routine maintenance, including a pad **118** replacement, may occur at an average interval of approximately 1.5 million coins processed by the

coin processing systems or coin sorters **100**. Having to visit a coin processing system or coin sorter **100** between regular service intervals, such as, for example, every 400,000 coins processed on average in, for example, some self-serve applications, increases the cost of maintenance by nearly a factor of four (4), and decreases coin processing system or coin sorter **100** uptime resulting in lost revenue.

According to some embodiments, a need exists for a solution that results in an average service life of the coin pad **118** of approximately 1.5 million coins processed and/or for the ability for an untrained user to replace the pad **118** without a service call in the event of early failure, thereby avoiding an unplanned service call. According to some embodiments, it has been found that it would be desirable if the pad **118** were made from a material that was puncture resistant and/or from a material if punctured that would resist propagation on the puncture, thus, resisting the formation of a tear and/or gouged-out area. Furthermore, it has also been found that it would be desirable if a pad **118** were constructed so as to prevent and/or minimize the extent of tears, rips, ripples, stretch, gouges, and/or punctures of or in the pad **118** and/or for a system for detecting the existence of damage to a pad **118** and annunciating and/or alerting an operator of or owner of or maintenance personnel for a coin processing system or coin sorter **100** of damage to a pad **118** when it occurs, before the damage to the pad **118** compromises the counting/sorting function of the coin processing system or coin sorter **100**.

Often the pad surface, or skin, material can be fabricated in different ways such as Calendaring or coating techniques.

The present disclosure provides several improvements to increase pad **118** resilience and operating life and/or to detect the existence of damage to a pad **118** and annunciate and/or alert an operator of or owner of or maintenance personnel for a coin processing system or coin sorter **100** of damage to a pad **118** when it occurs, before the damage to the pad **118** compromises the counting/sorting function of the coin processing system or coin sorter **100** and/or to reduce downtime of a coin processing system or coin sorter **100** by facilitating pad **118** replacement by an unskilled person as opposed to a trained service technician. These improvements include (1) a debris-resilient pad skin having a mesh layer; (2) a pad skin that is machined to achieve tight pad tolerances; (3) a coin pad **118** having detectable coin pad layers; (4) a system for detecting pad **118** damage; (5) a composite differential adhesive for adhering a coin pad **118** to disc **120**; and/or (6) a twist-lock debris blade or cone. According to some embodiments, one or more or all of these improvements may be employed with a coin processing system or coin sorter **100**. According to some embodiments, one or more or all of these improvements may be employed in a self-service coin processing system or coin sorter **100** and/or an attended coin processing system or coin sorter **100**.

(1) Debris-Resilient Pad Skin Having a Mesh Layer

FIG. 5A and FIG. 5B are top views of a mesh material **501** that may comprise a layer of coin pad **118**. According to some embodiments, the mesh material **501** is made of Kevlar® fiber made by DuPont, nylon, or other material. Bench testing has shown little to no stretch of pads **118** made using a Kevlar® fiber mesh **501** and/or the prevention of or the resistance to puncture of the skin **118s** of a pad **118** made using a Kevlar® fiber mesh **501**.

FIG. 5F a top view of an exemplary leno weave pattern for a mesh layer **501** according to some embodiments. Such a leno weave pattern is also illustrated in FIG. 5A. According to some embodiments, the leno weave pattern is achieved

when parallel sets of twisted pairs of fibers WARP are oriented generally orthogonal to a set of single fibers WEFT, wherein the single fibers WEFT are woven through adjacent twists of the twisted pairs of the fibers WARP. According to some embodiments, 4.1 ounce (116 g) nylon leno mesh is employed. According to some embodiments, the mesh material **501** is made of Kevlar® fibers. According to some embodiments, the use of a leno weave pattern increases the stability (e.g., tear resistance, stretch resistance) of the mesh materials and the NBR diagonally between the orthogonal sets of fibers. According to some embodiments, the use of leno nylon mesh in combination with nitrile rubber inhibits, reduces, or prevents stretching of the pad **118** in a diagonal direction D5F (see. FIG. 5F) with respect to the leno weave pattern.

FIG. 5G is a top view of an exemplary triaxial weave pattern for a mesh layer **501'** according to some embodiments. According to some embodiments, three sets of parallel threads are oriented at about 60° from each other and are interwoven in an alternating over one, under one pattern with respect to the threads of the non-parallel sets of threads. According to some embodiments, the mesh material **501'** is made of Kevlar® fibers. According to some embodiments, the mesh material **501'** is made of nylon fibers. According to some embodiments, the use of a triaxial weave pattern provides better stability (e.g., tear resistance, stretch resistance) in all directions. According to some embodiments, the use of a triaxial weave pattern provides three dimensional (3D) stretch resistance and may reduce or minimize the “rebounding” or “slingshot” effect as the pressure on the top of the pad generating a “plowing” effect otherwise exhibited by some pads when pad pressure on a coin is released, such as in a re-gauging area, such as described in U.S. Pat. No. 10,679,449, herein incorporated by reference in its entirety. According to some embodiments, use of pads without a mesh layer or without a mesh layer employing a triaxial weave pattern, may result in a “rebounding” or “slingshot” effect as the pressure on the top of the pad generating the “plowing” effect is relieved such as when the coins move downstream of the re-gauging wall **252** and/or the re-gauging block **254** whereby the top of the pad **118** which has been pushed radially inward by a coin moving along re-gauging wall **252** moves or rebounds radially outward as a coin moves past the downstream end of the gauging block **254** and/or along the re-gauging wall **252** and/or the downstream end of the re-gauging wall **252**.

According to some embodiments, alternative weave patterns are employed for mesh material **501**, **501'** such as, for example, two sets of parallel threads oriented orthogonal to each other and interwoven in an alternating one over, one under pattern.

According to some embodiments, a layer of mesh **501**, **501'** made of Kevlar®, nylon, and/or other material is incorporated into a pad **118** and the layer of mesh enhances tensile strength, dimensional stability, puncture/cut resistance, impact resistance, stretch resistance, and overall longevity. According to some embodiments, a layer of mesh **501**, **501'** having a leno weave pattern or triaxial weave pattern and made of Kevlar®, nylon, and/or other material is incorporated into a pad **118** and the layer of mesh enhances tensile strength, dimensional stability, puncture/cut resistance, impact resistance, stretch resistance, and overall longevity.

According to some embodiments, the layer of mesh **501**, **501'** is imbedded and/or fabricated within a pad **118** such as a pad **118** made of nitrile rubber. FIG. 5D is a partial cross-sectional view of a portion of a sorting head **312**

illustrating an exemplary coin C50 (US 500 coin) pressing a portion of pad 118 downward. In some embodiments, the pad 118 may comprise a lower foam layer 118f and an upper skin layer 118s coupled to the lower foam layer 118f such as with adhesive. According to some embodiments, a layer of mesh material 501, 501' is contained within the skin layer 118s of the pad 118. Fabricating such a pad skin 118s can be accomplished in several ways such as, for example, calendaring and coating approaches. FIG. 5C is a side view of a skin layer 118s having a layer of mesh material 501 (or 501') embedded therein.

Turning to FIG. 5E, the mesh layer 501, 501' can be positioned and controlled in any position (distance) within the thickness of the skin 118s. FIG. 5E illustrates three exemplary options for placement of a mesh layer 501, 501' within a skin layer 118s of a pad 118 (not to scale). According to Option #1 and Option #2, a skin layer 118s has an overall thickness of 0.043 inches (1.1 mm). In the illustrated example in Option #1, a 0.005 inch (0.1 mm) thick mesh layer 501, 501' is positioned above a bottom 0.010 inch (0.25 mm) thick nitrile rubber layer and below a top inch (0.71 mm) thick nitrile rubber layer. In Option #2, the mesh layer 501, 501' is positioned closer to the middle of the skin layer 118s, with a 0.005 inch (0.1 mm) thick mesh layer 501, 501' positioned between a bottom 0.019 inch (0.48 mm) thick nitrile rubber layer and below a top 0.019 inch (0.48 mm) thick nitrile rubber layer. According to Option #3, a skin layer 118s has an overall thickness of 0.068 inches (1.7 mm) and comprises a 0.005 inch (0.1 mm) thick mesh layer 501, 501' positioned between a bottom 0.010 inch (0.25 mm) thick nitrile rubber layer and below a top inch (1.3 mm) thick nitrile rubber layer. According to some embodiments, the nitrile rubber layers are made from WARCO 80-P-987 material.

According to some embodiments, pads 118 incorporating such a layer of mesh 501, 501' have prevented or inhibited the occurrence of tears, rips, gouges, stretching, ripples, stretch etc. According to some embodiments, embedding a mesh layer 501, 501' between two layers of rubber such as nitrile rubber or other material allows for any final surface finish, such as a mesh finish.

While nitrile rubber has been described as a material from which the skin 118s of a pad 118 may be made, other materials additionally or alternatively be used, such as, for example, Neoprene, urethane, composite urethane, polymers, rubber, or rubber products, leather, or a spongy, compliant material.

Likewise, while layer 501, 501' has been described as a mesh, other configurations and/or materials may be used according to some embodiments, such as, for example, a solid layer of support material, loose fibers in spoke or overlapping material, a layer of urethane, spray on materials, embedded materials, gold specs, or a pad skin made from a slurry of materials cured into a pad skin. The materials may include, for example, Kevlar® fiber, nylon, urethane, metal, etc.

Likewise, while pads 118 in the present disclosure have been and/or are later described as having a bottom foam layer, the bottom layer may be made out of other material such as, for example, nitrile rubber, Neoprene, urethane, composite urethane, polymers, rubber, or rubber products, leather, or a spongy, compliant material.

Finally, while the pads 118 in the present disclosure have been and/or are later described as having separate skin 118s and bottom 118f layers, a pad without separate layers may also be used according to some embodiments, such as, for example, a pad 118 with an embedded mesh or stiffening

materials without separate skin and foam layers, e.g., a single type of material throughout the pad and/or such a single type of material with a layer of mesh or other strengthening layer therein.

(2) Machine Skin to Achieve Tight Pad Tolerances

In Options #1 and #3 of FIG. 5E, the mesh layer 501, 501' is positioned closer to the bottom of the skin layer 118s, leaving more nitrile rubber material on top to enhance the wear life of the pad 118, allowing the completed pad 118 to be post-processed, by machining the thicker side of the skin top surface to control the overall thickness of the pad 118 with great accuracy. According to some embodiments, the mesh layer 501, 501' is positioned in the lower 50% of the skin thickness. According to some embodiments, the mesh layer 501, 501' is positioned in the lower 40% of the skin thickness. According to some embodiments, the mesh layer 501, 501' is positioned in about the lower 33%-35% of the skin thickness. According to some embodiments, the mesh layer 501, 501' is positioned in the lower 25% of the skin thickness.

According to some embodiments, it can be desirable to maintain a tight tolerance on the height or thickness of coin pads 118. In disc-type coin processing systems 100 such as coin sorters or coin counters or coin sorters, an air gap exists between the top of the sort pad 118 and the underside of the sorting head 112. The height of the air gap will vary based on the country set of coins to be processed by the system 100 and whether the system 100 is a coin counter or a coin sorter. For example, a properly adjusted machine 100 may be set with an air gap range of 0.005"-0.008" (a 0.003" range) [0.13 mm-0.020 mm (a 0.07-0.08 mm range)]. This air gap is set once a new sort pad 118 is installed in the machine 100. Setting/adjusting the air gap is performed by a trained technician. When the pad 118 needs to be replaced, a new pad 118 will be installed. Coin pads 118 could have a height or thickness tolerance of +/-0.003" (0.08 mm). Thus, if, for example, the original pad 118 that was installed had a thickness on the low end of the tolerance range (-0.003") [-0.08 mm] and the new pad 118 being installed has a thickness on the high end of the tolerance range (+0.003") [+0.08 mm], the 0.006" [0.15 mm] increase in height/thickness of the pad could eliminate the intended air gap or cause it to fall outside an acceptable range. As a result, a trained technician or trained attendant installing the new pad 118 would need to adjust air gap so it was within an acceptable range, e.g., by adjusting the height of the sorting head 112.

Sort pads 118 used on attended machines 100 typically have a life expectancy of 4-6 million coins. However, sort pads 118 used on self-service machines 100 typically have a much shorter life expectancy of under 1 million coins. The shorter lifespan in self-service machines 100 can be attributed to several factors, such as, for example, coin condition and/or user training but is mainly due debris and non-coin objects (nails, screws, keys, etc.) that are deposited into the machine 100 by a customer. The shorter coin pad life expectancy and the lack of trained personnel to change coin pads and adjust the air gap in self-service applications can result in more downtime for a self-service machine 100 and/or higher maintenance costs.

According to some embodiments, coin pads 118 are manufactured to tighter height/thickness tolerances so as to obviate or reduce the need to adjust the machines 100 to obtain an air gap within a desired range (e.g., by adjusting the height of the sorting head 112). To remove the need to adjust the air gap after each sort pad change, the tolerance range of the coin sort pad 118 overall thickness is made

tighter than the allowable air gap range. Therefore, according to some embodiments, coin pads **118** are made with a height/thickness tolerance range for a finished pad **118** of about ± 0.0015 " (about ± 38 μm).

According to some embodiments, in order to achieve this tolerance range, a face grinding process is performed following the final assembly process of a sorting pad **118**. The desired pad thickness tolerance is achieved by grinding the top skin **118s** of a pad **118**. According to some embodiments, an assembled sorting pad **118** is mounted to a vacuum chuck in a lathe. Then using a tool post grinder and grinding wheel, the face (top skin) **118s** of the pad **118** is ground so as to bring the coin pad **118** to a desired or target finish dimension/thickness within a tolerance of about ± 0.0015 " (about ± 38 μm).

(3) Detectable Coin Pad Layers/Coatings

According to some embodiments, one or more coatings of detectable material is/are applied to the top surface of the coin pad skin **118s**. According to some embodiments, the presence and/or thickness or level of the coating(s) is detected using one or more sensors such as, for example, a discrimination sensor **234**, **334**. According to some embodiments, one or more sensors such as, for example, a discrimination sensor **234**, **334** are employed to determine or measure: (a) coin thickness, (b) pad wear levels, (c) coin spacing (if the coating is eddy current detectable and distinguishable from the coins), (d) basic imaging of coins (and/or distinguishing between the presence and absence of a coin under the sensor(s)), such as, for example, if an infrared (IR) coating is used, and/or (e) diameter of coin such as, for example, if an infrared (IR) coating is used.

FIG. 6A is a schematic view of a sensor **600** for detecting characteristics of pad **118** and/or a coin positioned on the pad such as within a monitored path **604** and/or area **603** located within an annular region **604** of the pad **118**. According to some embodiments, the sensor **600** comprises one or more emitters **601** and one or more detectors **602**. According to some embodiments, a plurality of emitters **601** are positioned about or around the one or more detectors **602**. According to some embodiments, the emitters **601** emit ultraviolet (UV) and/or infrared (IR) light and the detectors **602** sense reflected or emitted ultraviolet (UV) and/or infrared (IR) and/or visible light. According to some embodiments, the sensor **600** is mounted in the sorting head **212**, **312** such as, for example, in the location of discrimination sensor **234**, **334** and may be mounted in the sorting head **212**, **312** so as to be in close proximity to the top surface of the skin **118s**.

FIG. 6B is a side sectional view of a portion of a pad **118** comprising a lower foam layer **118f** and an upper skin layer **118s**. According to some embodiments, a coating **605** of detectable material is applied on the surface of the coin pad skin **118s**. Alternatively, according to some embodiments, detectable elements **606** are applied on the surface of the coin pad skin **118s**. Alternatively, according to some embodiments, both a coating **605** of detectable material and detectable elements **606** are applied on the surface of the coin pad skin **118s**. One or more of the sensors **600** are configured to detect the detectable material of the coating **605** and/or the detectable elements **606**. The coating **605** and/or the detectable elements **606** have a thickness of D6. According to some embodiments, the coating **605** (and/or the detectable elements **606**) are applied across the entire surface of the pad **118**. According to some embodiments, the coating **605** (and/or the detectable elements **606**) are applied

across only select portions of the surface of the pad **118** such as, for example, near the perimeter of the pad **118**, e.g., within annular region **604**.

According to some embodiments, the sorting head assembly including the sorting head **212**, **312** and pad **118** are manufactured to a high degree of precision. As a result, the location and relative proximities of pad surface features are known with a high degree of accuracy. According to such embodiments, the sensor(s) **600** can be calibrated to detect the distance between an upper surface of a new coin pad **118** and the sensor(s) **600** and set the detected distance as corresponding to a pad life of 100%, e.g., a processor such as controller **180** may store an initial detected distance in a memory such as memory **188**, and associate that detected distance with a pad life of 100%. Then as coins wear away the top surface of the pad **118**, the distance between the sensor(s) **600** and the top surface of the pad **118** will increase and the increase in distance can be associated with a detected degree of wear, and a processor such as controller **180** may receive periodic distance measurements from a corresponding sensor such as sensor **600** and compare those measurements with the initial detected distance and detect any change and/or the degree of change in the measured distance and take appropriate action or actions as the measured distance satisfies one or more predetermined thresholds, such as, sending or displaying a warning to change the pad shortly when a first threshold is met (e.g., associated with 10% remaining pad life) and/or stop the operation of the coin sorter or counter **100** and send or display a message to change the pad when a second threshold is met (e.g., when 0% pad life remains).

For example, according to some embodiments, when a new pad is installed on rotatable solid disc **120**, using average distance or specific location distance (such as by employing disc encoder **184** to associate a measured distance with a specific location on the surface of the pad **118**), a location specific distance and/or average distance "X" between one or more sensor(s) **600** and the top surface of the pad **118** is measured. For example, the initial distance may be detected to be 0.25 inches (6.3 mm), e.g., 0.21" (5.3 mm) recess depth between the bottom of sensor **600** and the lowermost surface **210/310** of the sorting head **212/312** plus a 0.04" (1.0 mm) gap between the lowermost surface **210/310** of the sorting head **212/312** and the top of the pad **118** such as the level of the top of coating **605**. The height of the level of the top of the coating **605** (and/or the detectable elements **606**) and/or pad **118** is then repeatedly monitored and the level of wear of the coating **605** (and/or the detectable elements **606**) and/or pad **118** is repeatedly determined. For example, when a new coin pad **118** is installed, the distance between the sensor(s) **600** and the coating level **605** is detected, e.g., by sensor **600**, and the measured distance is set or associated with a pad life of 100%, e.g., a processor such as controller **180** communicatively coupled to an associated distance sensor, e.g., sensor **600**, may store an initial measured distance in a memory such as memory **188**, and associate that measured distance with a pad life of 100%. As the top surface of the coating **605** (and/or the detectable elements **606**) and/or pad **118** and/or pad skin **118s** wears away, the measured distance increases and may increase proportionally. A processor such as controller **180** may receive periodic distance measurements from a corresponding sensor such as sensor **600** and compare those measurements with the initial measured distance and detect any change and/or the degree of change in the measured distance and take appropriate action or actions as the measured distance satisfies one or more predetermined thresh-

13

olds. For example, when the measured distance reaches a predetermined amount, the controller **180** may generate a warning signal or message and, for example, alert an operator via operator interface **182**, to indicate that the coin pad **118** should be cleaned and/or replaced. For example, the controller **180** may generate such a warning signal when the measured distance increases to a distance associated with an expected remaining pad life of 10%-15% or 5%.

According to some embodiments, a gap between the lower surface of a sorting head such as the lowermost surface **210/310** of the sorting head **212/312** and the top of the pad **118** may change over time such as caused by pad wear or settling of the pad. According to some embodiments, when the measured gap distance exceeds of predetermined threshold, a processor such as controller **180** receiving periodic distance measurements from a corresponding sensor such as sensor **600** may send and/or display a message instructing an operator or service technician that the height of the sorting head relative to the top of the pad **118** needs to be manually adjusted, such as by lowering the sorting head.

According to some embodiments, the top of a pad **118** may have waves in it causing the measured gap between the lower surface of a sorting head such as the lowermost surface **210/310** of the sorting head **212/312** and the top of the pad **118** to vary by rotation of the pad. According to some such embodiments, one or more specific location distances (such as by employing disc encoder **184** to associate a measured distance with a specific location on the surface of the pad **118**) may be employed for distance measurements and decisions.

According to some embodiments, the sensor(s) **600** measure the amount of light (e.g., visible, infrared and/or ultraviolet light) reflected off or emitted by the coating **605** (and/or the detectable elements **606**) and the amount of detected light is used to measure pad wear. For example, according to some embodiments, when a new pad is installed on rotatable solid disc **120**, using average light intensity or specific location light intensity (such as by employing disc encoder **184** to associate a measured light intensity with a specific location on the surface of pad **118**), a location specific light intensity and/or average light intensity "Y" is measured, e.g., by sensor **600**, and a processor such as controller **180** communicatively coupled to an associated sensor may store an initial light intensity "Y" in a memory such as memory **188**, and associate that measured light intensity "Y" with a pad life of 100%. The light intensity received by the sensor(s) **600** from the coating **605** (and/or the detectable elements **606**) is then repeatedly monitored, e.g., by a processor such as controller **180** communicatively coupled to an associated light intensity sensor, e.g., sensor **600**, and the level of wear of the coating **605** is repeatedly determined. For example, when a new coin pad **118** is installed, the light intensity is detected and the measured light intensity is set or associated with a pad life of 100% e.g., a processor such as controller **180** communicatively coupled to an associated light intensity sensor may store an initial detected or measured light intensity in a memory such as memory **188**, and associate that detected light intensity with a pad life of 100%. A processor such as controller **180** may receive periodic light intensity measurements from a corresponding sensor such as sensor **600** and compare those measurements with the initial measured light intensity and detect any change and/or the degree of change in the measured light intensity and take appropriate action or actions as the measured light intensity satisfies one or more predetermined thresholds. As the top surface of the coating

14

605 (and/or the detectable elements **606**) wears away, the detectable coating **605** (and/or the detectable elements **606**) wears away such as by, for example, wearing away proportionally and the corresponding detected light intensity diminishes or increases such as by, for example, diminishing or increasing proportionally. When the detectable light intensity level reaches a predetermined amount, the controller **180** may generate a warning signal or message and, for example, alert an operator via operator interface **182**, to indicate that the coin pad **118** should be cleaned and/or replaced. For example, the controller **180** may generate such a warning signal when the measured light intensity decreases or increases to an intensity associated with an expected remaining pad life of 10%-15% or 5%. According to some embodiments, a deeper fabric finish or a thicker coating **605** (and/or thicker layer of the detectable elements **606**) is provided to allow for a longer coating wear life.

According to some embodiments, the coating **605** (and/or the detectable elements **606**) is IR (infrared) detectable and is used with a coin imaging sensor [see, e.g., U.S. Pat. Nos. 9,430,893; 9,508,208; 9,870,668; 10,068,406; 9,501,885; 9,916,713; and 10,685,523, each incorporated by reference herein by its entirety] to discern whether a coin is present under the sensor or not (Coin/No Coin), and/or provide a high precision coin diameter measurement, including the ability to measure non-circular perimeters and internal voids in coins (e.g., holes, cutouts, etc.). According to some such embodiments, the IR coating **605** (and/or the IR detectable elements **606**) combined with the use of imaging sensor(s) enhances the contrast between a coin and the coin pad **118** hereby facilitating distinguishing a coin from the background coin pad **118** such as by a processor such as controller **180** communicatively coupled to an associated sensor wherein the processor is configured to receive data from the associated sensor and use the received data to distinguish a coin from the background coin pad **118**.

According to some embodiments, the coating **605** (and/or the detectable elements **606**) is eddy current detectable by an eddy current sensor (e.g., sensor **600** may be an eddy current sensor). According to such embodiments, the detection of such an eddy current coating **605** (and/or eddy current detectable elements **606**) is used to signal a break between closely spaced coins that would otherwise appear as overlapping signal patterns, particularly when the coins being processed are not eddy current detectable and the coating **605** (and/or elements **606**) are distinguishable from the coins such as by a processor such as controller **180** communicatively coupled to an associated sensor wherein the processor is configured to receive data or signal patterns from the associated sensor and use the received data or signal patterns to detect a spacing between coins and to distinguish one coin from an adjacent coin.

According to some embodiments, the distance a coin displaces the top of the coin pad **118** from the location it has been detected to be in the absence of a coin is measured and the increase in distance is used to measure the thickness of the coin displacing the top of the coin pad **118**. For example, using average distance or specific location distance (such as being employing disc encoder **184** to associate a measured distance with a specific location on the surface of pad **118**), a location specific distance and/or average distance "X" between one or more sensor(s) **600** and the top surface of the pad **118** is measured when no coins are present on the pad **118**. For example, the initial distance may be detected to be 0.25 inches (6.3 mm), e.g., 0.21" (5.3 mm) recess depth between the bottom of sensor **600** and the lowermost surface **210/310** of the sorting head **212/312** plus a 0.04" (1.0 mm)

gap between the lowermost surface **210/310** of the sorting head **212/312** and the top of the pad **118**. With this known initial distance, a coin passing beneath the sensor **600** presses the upper pad surface further away by the difference between the coin thickness and distance “X”. The controller **180** receiving distance measurements from sensor **606** can then determine the thickness of the coin to a high degree of accuracy. Uses of coin thickness detection might include differentiating between two coins of identical or similar diameter but having different thicknesses, etc.

(4) Detectable Pad/Skin Tear

FIG. 7A is a schematic top view of a coin pad **118** having a plurality of tear detectable elements **701** and/or **702**. FIG. 7B is a schematic side view of a coin pad **118** having a tear detectable element **701**. FIG. 7C is a schematic top view of exemplary tear detectable elements **701** that may be employed with a coin pad such as, for example, the coin pad illustrated in FIG. 7A. While only one detectable element **701a** is shown in FIG. 7A, according to some embodiments, a plurality of detectable elements **701a**, **701e**, and/or **701f** can be positioned about the pad **118** such as, for example, 4-6 elements **701a** (and/or **701e** and/or **701f**) per quarter of the circular pad **118**. According to some embodiments, a plurality of detectable elements **701a** (and/or **701e** and/or **701f**) can be positioned about the pad **118** every certain number **702d** of degrees such as, for example, about every 18 degrees. The pad **118** has a center C. According to some embodiments, a pad **118** may have only a single detectable element such as detectable element **701b** or **701d**.

The shape of the detectable elements such as **701a**, **701b**, **701e**, **701f** may take on different shapes such as, for example, arc-shaped configurations repeated in one or more or all of sectors **702d**.

According to some embodiments, each detectable element **701a-701f** comprises a wire such as, for example, a thin copper wire, providing a continuity path monitored by a continuity sensor communicatively coupled to controller **180**. While continuity is maintained in each detectable element **701a-701f**, the pad integrity is indicated to be O.K. (e.g., the continuity detector(s) communicate maintained continuity to controller **180**). When the surface of the pad **118** is damaged, such as by a sharp non-coin object, a tear, rip, gouge, etc., and the damage in the pad **118** breaks one or more of the detectable elements, e.g., wires, **701a-701f**, the continuity of one or more of the detectable element(s) is broken, halting the flow of electricity through the one or more of the detectable elements, e.g., wires, **701a-701f**. When electricity no longer flows through the one or more of the detectable elements, e.g., wires, **701a-701f**, such condition is detected by one or more continuity detectors and communicated to a processor such as controller **180** which can then generate a stop signal to cause the rotatable disc **120** to stop rotating, e.g., by turning off or reversing motor **116** and/or applying braking mechanism **186**, and/or the controller **180** can generate an alert that the pad **118** has been damaged, such as, for example, via operator interface **182**. Accordingly, if a break in the continuity of the one or more detectable elements **701a-701f** is detected, this condition could be used to detect a deterioration of the pad (e.g., a tear or rip in the coin pad). According to some embodiments, when a break in continuity is detected, an emergency stop signal may be issued (e.g., by controller **180**) and the motor **116** driving the pad **118** may be stopped and/or an associated brake **186** may be activated to stop the rotation of the rotatable disc **120** and the pad **118** and/or the controller may annunciate and/or alert an operator of or owner of or maintenance personnel for a coin processing system or coin

sorter **100** of damage to the pad **118**. According to some embodiments, the sensor(s) monitoring continuity communicates wirelessly with a processor such as the motor controller **180** and/or brake **186**.

According to some embodiments, magnetic detectors are employed instead of or in addition to continuity detectors to detect a break in one or more of the detectable elements **701a-701f**.

According to some embodiments, such as embodiments employing a plurality of detectable elements separately monitored, e.g., detectable elements **701a**, **701c**, **701e**, **701f**, the coin sorter or counter **100** may permit an operator to override (e.g., using operator interface **182**) a stop or halt command issued by a controller **180** upon the detection that one or more of the detectable elements has been broken in a particular one or more sectors **702d** if after inspection of the pad **118**, the operator believes the damage to the pad is not significant enough to warrant replacement of the pad.

According to some embodiments, the detectable elements **701a-701f** are printed on or inside the pad **118** using stretchable or flexible electronic technology (see, e.g., “Soft, Wearable Health Monitor with Stretchable Electronics,” by Georgia Institute of Technology, Tech Briefs, September 2019, pp. 35-36, www.techbriefs.com included as Exhibit 3 in the Appendix and/or “New conductive ink for electronic apparel,” Phys Org, Jun. 25, 2015, <https://phys.org/news/2015-06-ink-electronic-apparel.html> included as Exhibit 4 in the Appendix.

As shown in FIG. 7B, according to some embodiments, the detectable elements, e.g., wires, **701a-701f** are embedded within the pad **118** such as, for example, between the pad skin **118s** and the pad foam layer **118f**. In the example shown in FIG. 7B, layers of adhesive **710** are positioned on each side of the detectable elements, e.g., wires, **701a-701f** between the pad skin **118s** and the pad foam layer **118f**. According to some embodiments, a single layer of adhesive **710** positioned on one side of the detectable elements, e.g., wires, **701a-701f** between the pad skin **118s** and the pad foam layer **118f** could be employed. According to some embodiments, the wires **701** are made of copper printed on a fabric sheet embedded within the pad **118** as described above.

Additionally or alternatively, the pad **118** may comprise a detectable element **702** which may comprise a thin sheet of copper such as, for example, printed copper on a fabric sheet embedded within the pad **118** such as, for example, between the pad skin **118s** and the pad foam layer **118f**, such as explained above with connection with FIG. 7B. According to some embodiments, the printed detectable element **702** which may take any of a variety of forms or patterns such as, for example, the annular star shape having an undulating outer edge defined by line **701d** and a central area (inside of line **724**) devoid of copper shown in FIG. 7A. According to some embodiments, the central area has perimeter **724** having a diameter of between about 5-6 inches (12.7-15 cm), e.g., about 5.38 inches (13.7 mm). According to some embodiments, the central area (and/or continuity line **701d**) is sized so that the detectable elements **701a-701f**, **702** are positioned below the sorting head **212**, **312**, and not within the central opening **202**, **302** of the annular sorting head **212**, **312**. According to some embodiments, the annular star shape of the detectable element **702** has a plurality of outward projections positioned about the pad **118** every certain number **702d** of degrees such as, for example, about every 18 degrees.

According to some embodiments, when the surface of the pad **118** is damaged, such as by a sharp non-coin object

17

causing a tear, rip, gouge, etc., and the damage in the pad 118 results in a break in the detectable element 702, resulting in the continuity of the detectable element(s) being broken, the halt of the flow of electricity through the detectable element 702 is detected by one or more continuity detectors. Such a condition is communicated by the one or more continuity detectors to a processor such as controller 180 which can then cause the rotatable disc 120 to stop rotating, e.g., by turning off or reversing motor 116 and/or applying braking mechanism 186, and/or the controller 180 can generate an alert that the pad 118 has been damaged, such as, for example, via operator interface 182. Accordingly, if a break in the continuity of the detectable element 702 is detected, this condition could be used to detect a deterioration of the pad (e.g., a tear or rip in the coin pad). According to some embodiments, when a break in continuity is detected, an emergency stop signal may be issued (e.g., by controller 180) and the motor 116 driving the pad 118 may be stopped and/or an associated brake 186 may be activated to stop the rotation of the rotatable disc 120 and the pad 118 and/or the controller may annunciate and/or alert an operator of or owner of or maintenance personnel for a coin processing system or coin sorter 100 of damage to the pad 118. According to some embodiments, the sensor(s) monitoring continuity communicates wirelessly with a processor such as the motor controller 180 and/or brake 186.

According to some embodiments, a battery 720 supplies power to the detectable elements 701a-701f, 702 and/or the continuity sensor(s). For example, as shown via dotted lines coupled to the ends of detectable element 701a, the ends of the detectable elements 701a-701f may be connected to one or more power lines powered by battery 720 and monitored by one or more continuity sensors. According to some embodiments, kinetic energy is used to recharge the battery 720 (e.g., as done with some wrist watches). According to some embodiments, the battery 720 may be wirelessly charged. According to some embodiments, one or more transceivers are coupled to the continuity sensor(s) both of which may be located in an electronics area 722. The one or more transceivers enable the continuity sensors to wirelessly communicate with a processor such as, for example, controller 180. According to some embodiments, an external power source may be employed and fed to the electronics on the pad 118 such as the detectable elements 701a-701f, 702 and/or the continuity sensor(s).

According to some embodiments, the pad 118 has an outer edge 118e having a diameter of about 11 inches (28 cm). According to some embodiments, an electronics area 722 has a diameter of about 2-3 inches (5-8 cm), e.g., about 2.63 inches (6.68 cm) and fits under or in and/or is protected by a center cone 801c, see, e.g., FIGS. 4A, 4I, 8A, and 8B.

According to some embodiments, the battery 720 and electronic area(s) 722 are mounted on a removable pad interface 728 having, e.g., a circular shape and dimensioned to fit under or in and/or be protected by a center cone 801c. During a pad change, the removable pad interface 728 may be decoupled from a pad 118 to be replaced and coupled to a new pad 118 to be or which has been coupled to the solid disc 120. According to some embodiments, the removable pad interface 728 and/or the pad 118 have printing or other alignment indications thereon to facilitate the proper alignment of the removable pad interface 728 with respect to the pad 118. According to some embodiments, a bottom surface of the removeable pad interface 728 has a plurality of electrodes extending therefrom and which electrically couple the electronics on the removeable pad interface 728

18

to the detectable elements 701a-701f, 702 when the removeable pad interface 728 is pressed into the top surface of the pad 118.

(5) Composite Differential Adhesive

According to some embodiments, to facilitate the changing of a pad 118, such as by an operator of the system 100 between visits of regular maintenance personnel and/or by maintenance personnel, an adhesive having a lower level of tackiness is used to couple a pad 118 to the rotatable disc 120. According to some embodiments, due to the size and high surface energy of the turntable (e.g., a disc 120 having an 11" (28 cm) diameter and being made of machined aluminum) a "low tack" adhesive is able to produce high amounts of strength in a shear direction (e.g., parallel to the surface of the disc 120 while allowing for very low force required while removing the pad when in tension (e.g., in a direction perpendicular and/or some other angle other than parallel to the surface of the disc 120). Additionally or alternatively, according to some embodiments, a differential adhesive (different levels of adhesion on each side) is employed that will properly bond with the low surface energy of the machined pad and the high surface energy of the turntable platen/disc 120. According to some such embodiments, an operator may peel off a pad 118 that needs to be replaced and couple a new pad 118 to the disc 120 in its place.

According to some embodiments, the differential adhesive is oriented with respect to the lower surface of the pad 118 such that the differential adhesive releases the bond between it and the disc 120 while remaining adhered to the old pad 118 so that when an old pad 118 is removed, all or most of the adhesive remains attached to the removed old pad 118 and the top surface of the rotatable disc 120 is substantially free of adhesive. Then an adhesive protective layer (e.g., film) may be removed from the bottom of a new pad 118 and then the pad 118 may be coupled to the top surface of the disc 120.

According to some embodiments, the differential adhesive is made by adhering or laminating a "low tack" adhesive layer to a "high tack" or high-strength adhesive layer and adhering the "high tack" adhesive layer to the bottom surface of the pad 118. A liner remains over the "low tack" adhesive layer until the pad 118 is to be adhered to a disc 120. According to some embodiments, 3M Flexomount™ Solid Printing Tape 412DL is used as the "high tack" adhesive layer and 3M Repositionable Tape 9415PC tape is used as the "low tack" adhesive layer. "High tack" is a tackiness equal to or greater than the tackiness of 3M Flexomount™ Solid Printing Tape 412DL and "low tack" is a tackiness equal to or less than the tackiness of 3M Repositionable Tape 9415PC. The 3M Repositionable Tape 9415PC tape may be used on items that need to be repositioned easily and carries a very low adhesive bond similar to that of a 3M Post-it® note. More information about 3M Flexomount™ Solid Printing Tapes including 412DL is provided in the data sheet included as Exhibit 1 in the Appendix and more information about 3M Repositionable Tapes including 9415PC is provided in the data sheet included as Exhibit 2 in the Appendix. According to some embodiments, 3M Flexomount™ Solid Printing Tape 412DL serves as a high strength adhesive that provides a good bond to a machined foam 118f/surface of the sort pad 118.

According to some embodiments, a sheet of differential adhesive is made beginning with a sheet of 3M Flexomount™ Solid Printing Tape 412DL and a sheet of 3M Repositionable Tape 9415PC tape, each having a paper or

plastic liner on both opposing surfaces thereof. The liner on one surface of each of the 3M Flexomount™ Solid Printing Tape 412DL and 3M Repositionable Tape 9415PC tape is removed, and the exposed surfaces of the sheets of 3M Flexomount™ Solid Printing Tape 412DL and 3M Repositionable Tape 9415PC tape are adhered or laminated together to create a sheet of differential adhesive. The high tack side of the 3M Flexomount™ Solid Printing Tape 412DL is then attached or adhered to the foam 118f side of a sort pad 118 (after removing the liner from that side of the sheet of differential adhesive) while the liner on the 9415PC side of the differential adhesive sheet remains on the sort pad 118 until the pad 118 ready to be installed on a disc 120. At that time, the liner covering the 9415PC side of the differential adhesive sheet is removed, and the pad 118 via the differential adhesive is adhered to the disc 120 of a coin sorter 100.

(6) Twist-Lock Debris Blade or Cone

According to some embodiments, to facilitate the changing of a pad 118, such as by an operator of the system 100 between visits of regular maintenance personnel and/or by maintenance personnel, a twist-lock debris blade or cone 801 is employed. FIG. 8A is a top perspective view and FIG. 8B is a bottom perspective view of a twist-lock debris blade or cone 801. FIG. 8C is a bottom perspective view of a debris blade or cone post 810 and a retaining washer interface 820 and FIG. 8D is a side perspective view of the debris blade or cone post 810, the retaining washer interface 820, and a coupler 830. FIG. 8E is a bottom perspective view of the retaining washer interface 820. FIG. 8F is an exploded, perspective view of some components of a twist-lock debris blade or cone assembly 861 and disc mounting assembly 862 according to some embodiments. FIG. 8G illustrates perspective views of parts of a twist-lock debris blade assembly 861 and disc mounting assembly 862 and a post coupling tool 870 according to some embodiments. FIG. 8H is a perspective view of a post coupling tool 870 engaged with a twist-lock debris blade assembly 861 according to some embodiments.

According to some embodiments, the debris blade 801 may have a relatively straight debris arm 801a coupled to or integral with a center cone 801c as illustrated in FIGS. 8A, 8B, 4A, and 4B or a curved debris arm 801b coupled to or integral with a center cone 801c as illustrated in FIG. 4E.

According to some embodiments, utilizing the spring force of the sorting pad 118, the debris blade 801 incorporates a quarter turn, locking geometry to install and retain the debris blade while in use. To remove, the user depresses the debris blade post 810 using a post coupling tool (such as, for example, a $\frac{5}{16}$ inch [8 mm] hex tool or key fitted into a tool interface 810t located on the top of the debris blade post 810) and rotates the debris blade post 810 a quarter turn in the counter-clockwise direction. The pad 118 is then removed by lifting on the outer edge of the pad 118.

According to some embodiments, the debris blade post 810 has one or more retaining flanges 812 located near the bottom of the post 810. The retaining washer interface 820 has a central generally circular opening or cylindrical aperture 826 slightly larger than the generally circular or cylindrical lower portion of the post 810. The retainer washer interface 820 also has one or more retaining flange unlocked profiles 824 and one or more retaining flange locking profiles or surfaces 822 which may define one or more detents. In between the unlocked profiles 824 and the locking surfaces 822, the interface 820 has one or more cam profiles or surfaces 820c. To install the post 810 and couple it to the washer interface 820, the generally circular or

cylindrical lower portion of the post 810 is fitted through the central, generally circular opening 826 of the interface 820 with the retaining flanges 812 lined up with the unlocked profiles 824. The post 810 is then turned a quarter turn in a clockwise direction (e.g., using the post coupling tool 870) and the retaining flanges 812 travel under the cam surfaces 820c and are retained by the locking surfaces 822 in the absence of downward pressure by the post coupling tool 870. The pad 118 is made of a flexible, resilient material that permits the post 810 and the retaining flanges 812 thereof to be moved downward when the post 810 is pressed downward by a person. However, when the person no longer pushes downward on the post 810, the pad 118 presses the post 810 and the retaining flanges 812 into locked engagement with the locking surfaces 822.

To uncouple the post 810 from the interface 820, the post is pressed downward and rotated a quarter-turn in the counter-clockwise direction, first moving the retaining flanges 812 out of locked engagement with the locking surfaces 822, then moving the retaining flanges 812 over the cam surfaces 820c and finally aligning the retaining flanges with the unlocked profiles 824 of the interface 820. The generally circular or cylindrical lower portion of the post 810 is then removed from the central, generally circular opening 826 of the interface 820 with the retaining flanges 812 lined up with the unlocked profiles 824.

Although not shown in FIGS. 8C and 8D, according to some embodiments, the debris blade 801a, 801b and the associated center cone 801c may remain coupled to the post 810 during the process of coupling and decoupling the post 810 to the interface washer 820.

According to some embodiments, the washer interface 820 is fixedly coupled to the rotatable disc 120 such as via one or more fasteners (e.g., screws) inserted through apertures 828 and coupled directly or indirectly to the rotatable disc. For example, according to some embodiments, the washer interface 820 is fixedly coupled to a disc coupler or debris cone base 830 which in turn is fixedly coupled to the rotatable disc 120 such as via a threaded post 832.

Turning to FIG. 8F, some components of a twist-lock debris blade assembly 861 and disc mounting assembly 862 according to some embodiments are shown. As shown, the twist-lock debris blade assembly 861 comprises a stop 841, a shim 842, the center cone 801c having a debris blade 801a formed integral therewith, a bearing housing 843, a shim 844, a washer 845, an angled washer 846, and the debris blade post 810 into which a dowel pin 847 is inserted above the stop 841. A retaining ring 848 is also coupled to the debris blade post 810. According to some embodiments, the several washers assist with allowing free rotation of the post 810 and/or reduce friction, etc., during the rotation of the post 810. According to some embodiments, the bearing housing 843 may be a one-way bearing.

The disc mounting assembly 862 comprises the retainer washer interface 820, two screws 851 and washers 852 used to secure the retaining washer interface 820 to the disc coupler or debris cone base 830. The threaded post 832 is fitted through a central aperture in the base 830 and screwed into a corresponding threaded aperture in the center of the disc 120 (not shown in FIG. 8F). Referring to FIGS. 8D and 8F, the base 830, also has one or more retaining tabs 830t which fit into matching depressions or holes in the surface of the disc 120 which keep the base 830 from rotating with respect to the disc 120 when the base 830 is secured to the disc 120. When installed, a top surface 830ts of the base 830 is flush with the top surface of the disc 120 according to some embodiments. Additionally, the base 830 may have a

21

raised, circular, pad centering portion **830d**. During installation of a new pad **118**, the pad **118** may have a central aperture sized to accommodate the raised, circular, pad centering portion **830d** of the base **830** which assists with centering the pad **118** on the disc **120**.

According to some embodiments, the twist-lock debris blade assembly **861** is assembled during production and remains assembled during the processes of coupling and decoupling the debris blade post **810** to the retaining washer interface **820**. Rather, the twist-lock debris blade assembly **861** may be removed and installed as a unit during a pad change operation.

As shown in FIGS. **8G** and **8H**, according to some embodiments, the post coupling tool **870** may have a large handle at the top of the tool **870** to facilitate the ability of a person to press down on the tool **870** and rotate it during the process of uncoupling and/or coupling the post **810** from/to the retaining washer interface **820**. The lower end of the tool **870** is configured to mate with the tool interface **810i** located on the top of the debris blade post **810**, and may be, for example, a $\frac{5}{16}$ inch (8 mm) hex tool or key. According to other embodiments, the tool **870** and the tool interface **810i** may have other configurations such as, for example, an internal or external wrenching hex, flat head or cross recessed head, knurl, or other shape that provides adequate torque to the post **810** to get its retaining flanges **812** to engage and seat properly within the interface **820**.

While FIGS. **8A-8B** and **8F-8H** illustrate a cone **801c** having a debris blade or arm **801a**, **801b** extending therefrom, according to some such embodiments, a cone **801c** not having a debris blade or arm **801a**, **801b** may be used.

FIG. **9A** is a side perspective view; FIG. **9B** is a first side; FIG. **9C** is a second side view; FIG. **9D** is a top view; and FIG. **9E** is a cross-sectional side view of an alternative embodiment of a retaining washer interface **920** according to some embodiments. The second side view shown in FIG. **9C** is about 90° offset from the first side view shown in FIG. **9B**. The cross-sectional view shown in FIG. **9E** is taken along line **9E-9E** shown in FIG. **9D**.

10A is a perspective view; FIG. **10B** is a first side; and FIG. **10C** is a second side view of an alternative embodiment of a center cone retaining post **1010** according to some embodiments. FIG. **11** is a perspective view of portions of a coin processing system **100** showing a center cone retaining post **1010** holding a center cone **801c** against the top of a pad **118**. The pad **118** is bonded or coupled to the top surface of a solid disc **120**. In FIG. **11**, the retaining post **1010** is coupled to the retaining washer interface **920** which has been coupled to the solid disk **120** and/or other portion of a turntable such as by a threaded end **932** being screwed into a threaded aperture in the center of the solid disk **120** and/or turntable.

As shown in FIGS. **10A-10C**, the center cone retaining post **1010** has a cylindrical post section **1012** having a high-friction handle **1060** near a first end and having retaining flanges **1012** near a second end. According to some embodiments, the high-friction handle **1060** has a knurled surface. When in an operative position, a bottom surface **1062** of the handle **1060** engages a top surface of a cone **801c** to bias the cone **801c** downward into a pad **118** as shown in FIG. **11**. According to some embodiments, the post may not have a handle and may have a cone engaging surface **1062** without having a handle **1060**.

Turning back to FIGS. **9A-9E**, the retaining washer interface **920** may have a generally cylindrical shape and have a generally cylindrical central aperture **926** in a top end of the interface **920** and one or more side apertures **924a** and one

22

or more pivot apertures **927a**. As illustrated, two side apertures have a generally vertical orientation and are defined by generally vertical internal side walls **924** extending from near the top of the interface **920** to a lower internal wall **927**. As illustrated, two pivot apertures **927a** defined by internal walls **927** extend generally horizontally from lower portions of side apertures **924a** in a common direction (clockwise in FIG. **9A**) and terminate with a raised upper wall **922**. Although not visible in FIG. **9A**, there is a second pivot aperture **927a** on the far side of the interface **920** having the same or similar shape as the visible aperture **927a**. The cylindrical center aperture **926** is sized to accommodate the cylindrical post section **1012** of the cone retaining post **1010** and the apertures **924a**, **927a** are sized to accommodate the retaining flanges **1012** of the cone retaining post **1010**. The interface **920** also has a threaded post **932** at a lower end that is configured to be screwed into a corresponding threaded aperture in the center of the disc **120**, thereby securely coupling the interface **920** to the disc **120**.

To assemble the arrangement shown in FIG. **11**, the threaded post **932** of the interface **920** is screwed into a corresponding threaded aperture in the center of the disc **120**. Then a pad **118** is coupled to the disc **120**. According to some embodiments, the pad **118** has a central opening or aperture sized to just fit about the circumference of a bottom portion **920B** of the interface **920**, thereby aiding in centering the pad **118** on the disc **120**. Once the pad **118** has been installed in the disc **120**, the cone **801c** having a central opening in placed over the interface **920**.

Next, the center cone retaining post **1010** is coupled to the interface **920**. To accomplish this coupling, the lower end of the cone retaining post **1010** is inserted through the center opening in the cone and the retaining flanges **1012** on the post **1010** are aligned with the side apertures **924a** of the interface **920**. According to some embodiments, the center opening in the cone may have cut outs sized to permit the retaining flanges **1012** of the post **1010** to fit therethrough. Once the retaining flanges **1012** on the post **1010** are aligned with the side apertures **924a** of the interface **920**, the post **1010** is lowered within the interface **920** until the retaining flanges **1012** contact the lower internal walls **927**. The post **1010** is then rotated about its longitudinal axis (here, vertical axis) until the retaining flanges **1012** contact the walls at the end of the pivot apertures **927a**. To aid in the rotation of the post **1010**, the handle **1060** may have a high-friction surface such as a knurled surface. According to some embodiments, a user, operator, or technician may insert and rotate the post **1010** into and within the interface **920** by holding and squeezing the handle **1060** in his or her handle. According to some embodiments, while the post **1010** is being lowered vertically within the interface **920** with the retaining flanges aligned within the vertical apertures **924a**, the lower surface of **1062** of the handle contacts the top edge of the cone **801c**. To enable the post **1010** to travel further down into the interface **920** so that the retaining flanges **1012** may become aligned with the horizontal apertures **927a**, the user must press the handle **1060** downward, thereby pushing the cone **801c** into the compressible pad **118**. While still pressing downward, the handle is then turned or rotated (clockwise in FIG. **9A**) as the retaining flanges pass through the pivot apertures **927a**. Once the retaining flanges **1012** contact the walls at the end of the pivot apertures **927a** and the downward bias or pressure from a person installing the post **1010** within the interface **920** is removed, the resilient pad **118** biases the cone **801c** upward, thereby pressing upwardly into the lower surface **1062** of the handle **1060** and thereby

23

biasing the post **1010** upward and raising the retaining flanges **1012** into the raised upper walls **922** and the corresponding rotation prevention notches or detents **927b**.

To remove the cone **801c** and pad **118** from the arrangement shown in FIG. **11**, the above steps are followed in reverse order. A person presses the handle **1060** downward, thereby pushing the cone **801c** into the compressible resilient pad **118** and moving the retaining flanges out of the rotation prevention notches or detents **927b**. While still pressing downward, the handle is then turned or rotated (counter-clockwise in FIG. **9A**) as the retaining flanges pass through the pivot apertures **927a**. Once the retaining flanges **1012** contact the far interior walls **924** at the other end of the pivot apertures **927a** and/or the retaining flanges **1012** become aligned with the vertical side apertures **924a**, the post **1010** may be moved upward and out of the interface **920**. Next the cone **801c** may be lifted over the interface **920** and removed. Next the pad **118** may be decoupled from the disc **120** and, if desired, a new pad **118** may be coupled to the disc **120** and the cone **801c** and the post **1010** may be reinstalled.

According to some embodiments, the post **1010** may have a tool interface on the top of the post **1010** or handle **1060**. Such a tool interface may be the same or similar to tool interface **810i** discussed above and may be designed to work with tool **870**. According to some such embodiments, the high-friction area of the handle **1060** may be omitted.

While the cone **801c** shown in FIG. **11** does not have a debris blade or arm **801a**, **801b** extending therefrom, according to some embodiments, it may have a debris blade or arm. Likewise, while some of the embodiments above utilize a cone **801c** having a debris blade or arm **801a**, **801b** extending therefrom, according to some such embodiments, a cone **801c** not having a debris blade or arm **801a**, **801b** may be used.

Thus, employing one or more of the above improvements (1)-(6), a number of advantages may be achieved. For example, a pad **118** with a higher tensile strength may be provided; a pad **118** that is tear resistant may be provided; a pad **118** that is puncture resistant may be provided; a pad **118** exhibiting reduced stretch may be provided which can contribute to maintaining a coin on its desired path, the reduction of mis-sorts, and the ability to process coin sets that are otherwise more challenging; pad tears or damage may be detected and annunciated such as by notifying appropriate personnel and halting operation of the coin sorter **100** thereby minimizing sorting inaccuracies that may otherwise be caused by use of a damaged pad; pad wear detection and/or preventative measures may be provided and, for example, the detection of a certain level of pad wear may be used to prompt service or other personnel to change a worn pad before a catastrophic failure or mis-sorts due to a worn pad occur; and/or a coating that allows for improved coin authentication and/or coin discrimination may be provided.

When combined, improvements (2), (5) and/or (6) detailed above may provide an untrained user the ability to reliably repair the machine **100** in a situation where the sorting pad **118** is damaged due to unexpected debris. For example, the twist-lock debris blade **801** may be removed using a counter-clockwise quarter-turn motion such as with an appropriate tool (e.g., a $\frac{5}{16}$ " (8 mm) Hex Key), and the pad **118** is then removed by lifting on the outer edge of the pad **118**. According to some embodiments, a compound differential adhesive (5) allows the pad **118** to be removed from the turntable **120** surface easily without any or minimal residue being left behind. With improvement (2), the toler-

24

ances held during the manufacturing of the pad **118** may eliminate the need for an attendant or operator to adjust the mechanical sorting gap desired for optimal machine operation. With a new pad **118** in place, the twist-lock debris blade **801** may be reinstalled and the machine **100** may be placed back in operation.

Alternative Embodiments

Embodiment 1. A resilient coin sorting pad for imparting motion to a plurality of coins, the resilient pad configured to be coupled to a rotatable disc of a coin sorter, the resilient pad being generally circular and having an outer periphery edge, the resilient pad comprising:

- a lower foam layer having a top surface;
- an upper skin layer coupled to the top surface of the foam layer; and
- a layer of mesh material.

Embodiment 2. The resilient pad of embodiment 1 wherein:

- the upper skin layer comprises at least one layer of nitrile rubber; and
- the layer of mesh material is Kevlar® fiber mesh.

Embodiment 3. The resilient pad of embodiment 1 wherein:

- the upper skin layer comprises at least one layer of nitrile rubber; and
- the layer of mesh material is nylon fiber mesh.

Embodiment 4. The resilient pad of embodiment 2 or embodiment 3 wherein:

- the upper skin layer comprises at least two layers of nitrile rubber; and
- the layer of mesh material is positioned between the at least two layers of nitrile rubber.

Embodiment 5. The resilient pad of embodiment 4 wherein:

- the at least two layers of nitrile rubber comprise a first layer having a first thickness and a second layer having a second thickness, and the layer of mesh material has a third thickness, and the first thickness is larger than the combined thicknesses of the second and third thicknesses, and wherein the first, second, and third thicknesses contribute to a thickness of the skin layer.

Embodiment 6. The resilient pad of embodiment 5 wherein the first, second, and third thicknesses are such that the layer of mesh is positioned in about the lower 33%-35% of the thickness of the skin layer.

Embodiment 7. The resilient pad of embodiment 5 wherein the first, second, and third thicknesses are such that the layer of mesh is positioned in the lower 40% of the thickness of the skin layer.

Embodiment 8. The resilient pad of embodiment 5 wherein the first, second, and third thicknesses are such that the layer of mesh is positioned in the lower 20% of the thickness of the skin layer.

Embodiment 9. The resilient pad of embodiment 5 wherein the first, second, and third thicknesses are such that the layer of mesh is positioned in the lower 50% of the thickness of the skin layer.

Embodiment 10. The resilient pad of embodiment 5 wherein the first, second, and third thicknesses are such that the layer of mesh is positioned in the lower 70% of the thickness of the skin layer.

Embodiment 11. The resilient pad of according to any of embodiments 1-10 wherein the layer of mesh material has a leno weave pattern.

25

Embodiment 12. The resilient pad of according to any of embodiments 1-10 wherein the layer of mesh material has a triaxial weave pattern.

Embodiment 13. The resilient pad of according to any of embodiments 1-10 wherein the layer of mesh material comprises interwoven fibers.

Embodiment 14. A resilient coin sorting pad for imparting motion to a plurality of coins, the resilient pad designed to be coupled to a rotatable disc of a coin sorter, the resilient pad being generally circular and having an outer periphery edge, the resilient pad comprising:

a lower foam layer having a top surface;
an upper skin layer coupled to the top surface of the foam layer; and

one or more coatings of detectable material applied to a top surface of the skin layer.

Embodiment 15. The resilient pad of embodiment 14 wherein:

the detectable material reflects or emits light responsive to infrared illumination.

Embodiment 16. The resilient pad of embodiment 15 wherein:

the detectable material emits visible light responsive to infrared illumination.

Embodiment 17. The resilient pad of according to any of embodiments 14-16 wherein:

the detectable material reflects or emits light responsive to ultraviolet illumination.

Embodiment 18. The resilient pad of any of embodiment 14-17 wherein:

the detectable material emits visible light responsive to ultraviolet illumination.

Embodiment 19. A resilient coin sorting pad for imparting motion to a plurality of coins, the resilient pad designed to be coupled to a rotatable disc of a coin sorter, the resilient pad being generally circular and having an outer periphery edge, the resilient pad comprising:

a lower foam layer having a top surface;
an upper skin layer coupled to the top surface of the foam layer; and

one or more electrically conductive elements coupled to or embedded within the skin layer.

Embodiment 20. A coin processing system for processing a plurality of coins comprising:

a rotatable disc having a resilient coin sorting pad of embodiment 19 coupled thereto for imparting motion to the plurality of coins, the resilient pad being generally circular and having an outer periphery edge; and
one or more continuity sensors coupled to the one or more electrically conductive elements configured to sense when one or more of the electrically conductive elements have a break therein preventing the flow of electricity therethrough.

Embodiment 21. The coin processing system of embodiment 20 further comprising:

a processor communicatively coupled to the one or more continuity sensors;

a motor operatively coupled to the rotatable disc for causing the rotatable disc to rotate and the motor being communicatively coupled to the processor;

wherein upon sensing one or more of the electrically conductive elements have a break therein preventing the flow of electricity therethrough, the processor sends a signal to the motor to stop the rotation of the rotatable disc.

26

Embodiment 22. A coin processing system for processing a plurality of coins of a mixed plurality of denominations, the coins of the plurality of denominations having a plurality of diameters, comprising:

a rotatable disc having a resilient coin sorting pad according to any of embodiments 1-19 coupled thereto for imparting motion to the plurality of coins, the resilient pad being generally circular and having an outer periphery edge; and

a stationary sorting head having a lower surface generally parallel to and spaced slightly away from the resilient pad, the lower surface forming a coin path for directing the movement of each of the coins.

Embodiment 23. A disc-type coin processing system comprising:

a hopper for receiving coins;
an annular sorting head having a central opening;
a rotatable disc having a top surface; and
a resilient pad of according to any of embodiments 1-19 coupled to the top surface of the rotatable disc.

Embodiment 24. A coin processing system for processing a plurality of coins of a mixed plurality of denominations, the coins of the plurality of denominations having a plurality of diameters, comprising:

a rotatable disc having a resilient pad coupled thereto for imparting motion to the plurality of coins, the resilient pad being generally circular and having an outer periphery edge, the resilient pad comprising:

a lower foam layer having a top surface;
an upper skin layer coupled to the top surface of the foam layer; and

one or more electrically conductive elements coupled to or embedded within the skin layer, when unbroken the electrically conductive elements conducting electricity and completing one or more associated continuity paths;

a stationary sorting head having a lower surface generally parallel to and spaced slightly away from the resilient pad, the lower surface forming a coin path for directing the movement of each of the coins;

at least one continuity sensor communicatively coupled to a processor or controller, the continuity sensor monitoring whether the one or more electrically conductive elements continue to conduct electricity and complete the associated one or more associated continuity paths; wherein when the sensor detects that one or more of the continuity paths have been disrupted and no longer conduct electricity, the processor or controller generates a stop signal to stop the rotation of the rotatable disc.

Embodiment 25. The coin processing system of embodiment 24 further comprising a motor driving the rotation of the rotatable disc and being communicatively coupled to the processor or controller; and wherein in response to the generation of a stop signal, the processor or controller halts the operation of the motor.

Embodiment 26. The coin processing system of embodiment 24 or embodiment 25 further comprising a rotatable disc brake communicatively coupled to the processor or controller; and wherein in response to the generation of a stop signal, the processor or controller initiates the operation of the brake to stop the rotation of the rotatable disc.

Embodiment 27. A twist-lock debris blade comprising:

a debris blade post; and
a retaining washer interface;
wherein the debris blade post comprises a generally circular lower portion and one or more retaining flanges

27

located near a bottom of the post extending outward from the generally circular lower portion;
 wherein the retaining washer interface comprises:
 a central, generally circular opening,
 one or more retaining flange unlocked profiles,
 one or more retaining flange locking profiles or surfaces,
 and
 one or more cam profiles or surfaces between the unlocked profiles and the locking surfaces;
 wherein to couple the post to the washer interface, the generally circular lower portion of the post is fitted through the central, generally circular opening of the interface with the retaining flanges lined up with the unlocked profiles, the post is then turned a quarter turn so that the retaining flanges travel under the cam surfaces and are retained by the locking surfaces in the absence of downward pressure on the post;
 wherein to uncouple the post from the washer interface, the post is pressed downward and rotated a quarter-turn so that the retaining flanges move out of locked engagement with the locking surfaces and then move over the cam surfaces and are finally aligned with the unlocked profiles of the washer interface, whereby the post may be moved upward and the generally circular lower portion of the post may be removed from the central, generally circular opening of the interface.

Embodiment 28. A twist-lock debris blade or cone comprising:

a post; and
 a retaining washer interface;
 wherein the post comprises a generally circular lower portion and one or more retaining flanges located near a bottom of the post extending outward from the generally circular lower portion;
 wherein the retaining washer interface comprises:
 a central, generally circular opening,
 one or more retaining flange unlocked profiles,
 one or more retaining flange locking profiles or surfaces,
 and
 one or more cam profiles or surfaces between the unlocked profiles and the locking surfaces.

Embodiment 29. The twist-lock debris blade or cone of embodiment 28 wherein the generally circular lower portion of the post and the retaining flanges are sized to fit through the central, generally circular opening of the interface when the retaining flanges are lined up with the unlocked profiles and wherein the generally circular lower portion of the post and the retaining flanges are sized not to fit through the central, generally circular opening of the interface when the retaining flanges are lined up with flange locking profiles or surfaces.

Embodiment 30. The twist-lock debris blade or cone of embodiments 28 or 29 wherein the unlocked profiles and the flange locking profiles or surfaces of the retaining washer interface are displaced from each other by about 90° relative to the central, generally circular opening of the retaining washer interface.

Embodiment 31. A method of coupling the post of any of embodiments 28-30 to the retaining washer interface of any of embodiments 28-30 in a disc-type coin processing system comprising an annular sorting head having a central opening, a rotatable disc having a top surface, and a resilient pad coupled to the top surface of the rotatable disc, wherein the post has a longitudinal axis, wherein the retaining washer interface is coupled to the rotatable disc, the method comprising:

28

aligning the retaining flanges of the post with the unlocked profiles of the retaining washer interface;
 fitting the generally circular lower portion of the post through the central, generally circular opening of the interface with the retaining flanges lined up with the unlocked profiles;
 pressing downward on the post to overcome an upward bias asserted on the post by the resilient pad and turning the post about its longitudinal axis so that the retaining flanges travel under the cam surfaces of the interface move adjacent to locking surfaces;
 removing the downward pressure on the post wherein the retaining flanges are biased upward by the resilient pad into engagement with the locking surfaces of the interface.

Embodiment 32. A method of decoupling the post of any of embodiments 28-30 from the retaining washer interface of any of embodiments 28-30 in a disc-type coin processing system comprising an annular sorting head having a central opening, a rotatable disc having a top surface, and a resilient pad coupled to the top surface of the rotatable disc, wherein the post has a longitudinal axis, wherein the retaining washer interface is coupled to the rotatable disc, and wherein the retaining flanges of the post are biased upward by the resilient pad into engagement with the locking surfaces of the interface, the method comprising:

pressing downward on the post to overcome the upward bias asserted on the post by the resilient pad and turning the post about its longitudinal axis so that the retaining flanges travel under the cam surfaces of the interface move into alignment with the unlocked profiles of the retaining washer interface;
 lifting the post upward out of the interface by fitting the generally circular lower portion of the post through the central, generally circular opening of the interface with the retaining flanges aligned with the unlocked profiles.

Embodiment 33. The methods according to any of embodiments 31 or 32 wherein the act of turning the post comprises turning the post a quarter turn.

Embodiment 34. The methods according to any of embodiments 31-33 wherein the post comprises a tool interface located on a top of the post and wherein the acts of pressing downward on the post and turning the post are performed using a tool engaged with the tool interface.

Embodiment 35. A resilient coin sorting pad for imparting motion to a plurality of coins, the resilient pad designed to be coupled to a rotatable disc of a coin sorter, the resilient pad being generally circular and having an outer periphery edge, the resilient pad comprising:

a foam layer having a bottom surface;
 a differential adhesive coupled to the bottom surface of the foam layer, the differential adhesive comprising at least two adhesive layers, the adhesive layers having different degrees of tack.

Embodiment 36. The resilient coin sorting pad of embodiment 35 wherein the differential adhesive comprises a layer of high tack coupled to the bottom surface of the foam layer and a layer of lower tack coupled to the layer of high tack adhesive.

Embodiment 37. The resilient coin sorting pad of embodiment 35 or embodiment 36 wherein the differential adhesive comprises a layer of 3M Flexomount™ Solid Printing Tape 412DL coupled to the bottom surface of the foam layer and a layer of 3M Repositionable Tape 9415PC tape coupled to the layer of 3M Flexomount™ Solid Printing Tape 412DL.

29

Embodiment 38. A coin processing system for processing a plurality of coins of a mixed plurality of denominations, the coins of the plurality of denominations having a plurality of diameters, comprising:

a rotatable disc having a resilient coin sorting pad according to any of embodiments coupled thereto for imparting motion to the plurality of coins, the resilient pad being generally circular and having an outer periphery edge, wherein the adhesive layer having the lower degree of tack contacts and couples the pad to the rotatable disc; and

a stationary sorting head having a lower surface generally parallel to and spaced slightly away from the resilient pad, the lower surface forming a coin path for directing the movement of each of the coins.

Embodiment 39. A disc-type coin processing system comprising:

a hopper for receiving coins;

an annular sorting head having a central opening;

a rotatable disc having a top surface; and

a resilient pad of according to any of embodiments 35-37 coupled to the top surface of the rotatable disc, wherein the adhesive layer having the lower degree of tack contacts and couples the pad to the rotatable disc.

Embodiment 40. A method of manufacturing a resilient coin sorting pad for imparting motion to a plurality of coins, the resilient pad designed to be coupled to a rotatable disc of a coin sorter, the resilient pad being generally circular and having an outer periphery edge, the pad comprising a foam layer and a skin layer, the method comprising:

a mounting an assembled sorting pad to a vacuum chuck in a lathe;

using a tool post grinder and grinding wheel, grinding the skin layer of the pad so as to bring the thickness of the coin pad to a desired thickness within a tolerance of about ± 0.0015 " (about $\pm 38 \mu\text{m}$).

Embodiment 41. A twist-lock cone retaining assembly comprising:

a cone retaining post; and

a retaining washer interface;

wherein the cone retaining post comprises a generally circular lower portion and one or more retaining flanges located near a bottom of the post extending outward from the generally circular lower portion;

wherein the retaining washer interface comprises:

a central, generally circular opening in a top surface of the interface,

one or more elongated side apertures in communication with the circular opening and extending downward from the top surface of the interface,

one or more pivot apertures pivot apertures, a first end of each pivot aperture being in communication with a respective one of the side apertures near a lower end of the side apertures, each pivot aperture having an upper detent near a second end of each pivot aperture.

Embodiment 42. The twist-lock debris blade of embodiment 41 wherein the generally circular lower portion of the post and the retaining flanges are sized to fit through the central, generally circular opening of the interface when the retaining flanges are lined up with the elongated side apertures and wherein the generally circular lower portion of the post and the retaining flanges are sized not to fit through the central, generally circular opening of the interface when the retaining flanges are lined up with the one or more upper detents.

Embodiment 43. The twist-lock debris blade of embodiments 41 or 42 wherein the elongated side apertures and the

30

upper detents of the retaining washer interface are displaced from each other by about 90° relative to the central, generally circular opening of the retaining washer interface.

Embodiment 44. A method of coupling the cone retaining post of any of embodiments 41-43 to the retaining washer interface of any of embodiments 41-43 in a disc-type coin processing system comprising an annular sorting head having a central opening, a rotatable disc having a top surface, and a resilient pad coupled to the top surface of the rotatable disc, wherein the post has a longitudinal axis, wherein the retaining washer interface is coupled to the rotatable disc, wherein the cone retaining post comprises a handle having a cone engaging surface configured to engage a post engaging surface of a cone, the cone having an upper central opening, the method comprising:

positioning the cone over retaining washer interface and over the pad so that the central opening of the cone is aligned with the central, generally circular opening in the top surface of the interface;

aligning the one or more retaining flanges of the cone retaining post with the one or more elongated side apertures of the retaining washer interface;

fitting the generally circular lower portion of the post through the central opening of the cone and the central, generally circular opening of the interface with the retaining flanges lined up with the elongated side apertures;

moving the post downward within the circular opening of the interface until the cone engaging surface of the handle of the post engages the post engaging surface of the cone;

pressing downward on the cone retaining post to overcome an upward bias asserted on the post by the resilient pad via the cone engaging with the cone engaging surface of the post so that the retaining flanges become aligned with the one or more pivot apertures and turning the post about its longitudinal axis so that the retaining flanges move through the pivot apertures until the retaining flanges move adjacent to the one or more detents;

removing the downward pressure on the cone retaining post wherein the retaining flanges are biased upward by the resilient pad into engagement with the detents of the interface.

Embodiment 45. A method of decoupling the cone retaining post of any of embodiments 41-43 from the retaining washer interface of any of embodiments 41-43 in a disc-type coin processing system comprising an annular sorting head having a central opening, a rotatable disc having a top surface, and a resilient pad coupled to the top surface of the rotatable disc, and a cone having an upper central opening, wherein the cone is positioned about the interface, wherein the post has a longitudinal axis, wherein the retaining washer interface is coupled to the rotatable disc, and wherein the retaining flanges of the cone retaining post are biased upward by the resilient pad into engagement with the detents of the interface, and wherein the cone retaining post comprises a cone engaging surface configured to engage a post engaging surface of a cone, the method comprising:

pressing downward on the cone retaining post to overcome the upward bias asserted on the post by the resilient pad and turning the post about its longitudinal axis so that the retaining flanges travel under the detents of the interface and move through the pivot apertures and come into alignment with the side apertures of the retaining washer interface;

31

lifting the cone retaining post upward out of the interface by fitting the generally circular lower portion of the post through the central, generally circular opening of the interface with the retaining flanges aligned with the side apertures and through the central opening of the cone.

Embodiment 46. The methods according to any of embodiments 44 or 45 wherein the act of turning the post comprises turning the post a quarter turn.

Embodiment 47. The methods according to any of embodiments 44-46 wherein the cone retaining post comprises a tool interface located on a top of the cone retaining post and wherein the acts of pressing downward on the cone retaining post and turning the post are performed using a tool engaged with the tool interface.

Embodiment 48. The methods according to any of embodiments 44-47 wherein the post has a high-friction handle having a knurled surface.

While the disclosure is susceptible to various modifications and alternative forms, specific embodiments have been shown by way of example in the drawings and described in detail herein. It should be understood, however, that the disclosure is not intended to be limited to the particular forms disclosed. Rather, the disclosure is to cover all modifications, equivalents and alternatives falling within the spirit and scope of the inventions as defined by the appended claims.

What is claimed is:

1. A twist-lock debris blade and cone comprising:
 - a post; and
 - a retaining washer interface,
 wherein the post comprises a lower portion and one or more retaining flanges located near a bottom of the post extending outward from the lower portion, and wherein the retaining washer interface comprises:
 - a central opening;
 - one or more retaining flange unlocked profiles;
 - one or more retaining flange locking profiles or surfaces; and
 - one or more cam profiles or surfaces between the one or more retaining flange unlocked profiles and the one or more retaining flange locking profiles or surfaces.
2. The twist-lock debris blade and cone of claim 1, wherein the lower portion of the post and the one or more retaining flanges are sized to fit through the central opening of the retaining washer interface when the one or more retaining flanges are lined up with the one or more retaining flange unlocked profiles, and wherein the lower portion of the post and the one or more retaining flanges are sized not to fit through the central opening of the retaining washer interface when the one or more retaining flanges are lined up with the one or more retaining flange locking profiles or surfaces.
3. The twist-lock debris blade and cone of claim 1, further comprising a debris arm coupled to or integral with a center cone.
4. The twist-lock debris blade and cone of claim 3, further comprising an angled washer coupled to the center cone and operable to reduce friction during rotation of the post.
5. The twist-lock debris blade and cone of claim 1, further comprising a stop and a dowel pin inserted above the stop and into an aperture of the post.
6. The twist-lock debris blade and cone of claim 1, wherein:
 - the post is configured to couple to the retaining washer interface in a disc-type coin processing system, the

32

disc-type coin processing system comprising an annular sorting head having a central opening, a rotatable disc having a top surface, and a resilient pad coupled to the top surface of the rotatable disc;

the post has a longitudinal axis;

the retaining washer interface is coupled to the rotatable disc; and

to couple the post to the retaining washer interface in the disc-type coin processing system:

the one or more retaining flanges of the post are configured to be aligned with the one or more retaining flange unlocked profiles of the retaining washer interface;

the lower portion of the post is configured to be fitted through the central opening of the retaining washer interface with the one or more retaining flanges lined up with the one or more retaining flange unlocked profiles;

the post is configured to be pressed downward via downward pressure to overcome an upward bias asserted on the post by the resilient pad and the post is configured to be turned about its longitudinal axis so that the one or more retaining flanges travel under the one or more cam profiles or surfaces of the retaining washer interface and move adjacent to the one or more retaining flange locking profiles or surfaces; and

the post is configured to have the downward pressure removed, wherein the one or more retaining flanges are biased upward by the resilient pad into engagement with the one or more retaining flange locking profiles or surfaces of the retaining washer interface.

7. The twist-lock debris blade and cone of claim 1, wherein:

the post is configured to decouple from the retaining washer interface in a disc-type coin processing system, the disc-type coin processing system comprising an annular sorting head having a central opening, a rotatable disc having a top surface, and a resilient pad coupled to the top surface of the rotatable disc;

the post has a longitudinal axis;

the retaining washer interface is coupled to the rotatable disc;

the one or more retaining flanges of the post are biased upward via an upward bias by the resilient pad into engagement with the one or more retaining flange locking profiles or surfaces of the retaining washer interface; and

to decouple the post from the retaining washer interface in the disc-type coin processing system:

the post is configured to be pressed downward to overcome the upward bias asserted on the post by the resilient pad and the post is configured to be turned about its longitudinal axis so that the one or more retaining flanges travel under the one or more cam profiles or surfaces of the retaining washer interface move into alignment with the one or more retaining flange unlocked profiles of the retaining washer interface; and

the post is configured to be lifted upward out of the retaining washer interface by fitting the lower portion of the post through the central opening of the retaining washer interface with the one or more retaining flanges aligned with the one or more retaining flange unlocked profiles.

8. A twist-lock debris blade and cone retaining assembly comprising:

33

a cone retaining post; and
 a retaining washer interface,
 wherein the cone retaining post comprises a lower portion
 and one or more retaining flanges located near a bottom
 of the cone retaining post extending outward from the
 lower portion, and
 wherein the retaining washer interface comprises:
 a central opening in a top surface of the retaining
 washer interface;
 one or more elongated side apertures in communication
 with the central opening and extending downward
 from the top surface of the retaining washer inter-
 face; and
 one or more pivot apertures, a first end of each pivot
 aperture being in communication with a respective
 one of the one or more elongated side apertures near
 a lower end of the one or more elongated side
 apertures, each of the one or more pivot apertures
 having an upper detent near a second end of each of
 the one or more pivot apertures.

9. The twist-lock debris blade and cone retaining assem-
 bly of claim 8, further comprising a cone having a center
 opening including one or more cut outs sized according to
 the one or more retaining flanges.

10. The twist-lock debris blade and cone retaining assem-
 bly of claim 8, wherein the cone retaining post includes a
 high-friction handle disposed near a top of the cone retaining
 post.

11. The twist-lock debris blade and cone retaining assem-
 bly of claim 10, wherein the high-friction handle has a
 knurled surface.

12. The twist-lock debris blade and cone retaining assem-
 bly of claim 8, wherein the retaining washer interface further
 comprises a threaded post configured to be threaded into a
 disc of a coin sorting system.

13. The twist-lock debris blade and cone retaining assem-
 bly of claim 8, wherein:

the cone retaining post is configured to couple to the
 retaining washer interface in a disc-type coin process-
 ing system, the disc-type coin processing system com-
 prising an annular sorting head having a central open-
 ing, a rotatable disc having a top surface, and a resilient
 pad coupled to the top surface of the rotatable disc;
 the cone retaining post has a longitudinal axis;
 the retaining washer interface is coupled to the rotatable
 disc;

the cone retaining post comprises a handle having a cone
 engaging surface configured to engage a post engaging
 surface of a cone, the cone having an upper central
 opening; and

to couple the cone retaining post to the retaining washer
 interface in the disc-type coin processing system:

the cone is configured to be positioned over the retain-
 ing washer interface and over the resilient pad so that
 the central opening of the cone is aligned with the
 central opening in the top surface of the retaining
 washer interface;

the one or more retaining flanges of the cone retaining
 post is configured to be aligned with the one or more
 elongated side apertures of the retaining washer
 interface;

the lower portion of the cone retaining post is config-
 ured to be fitted through the central opening of the

34

cone and the central opening of the retaining washer
 interface with the one or more retaining flanges lined
 up with the one or more elongated side apertures;
 the cone retaining post is configured to be moved
 downward within the central opening of the retaining
 washer interface until the cone engaging surface of
 the handle of the cone retaining post engages the post
 engaging surface of the cone;

the cone retaining post is configured to be pressed
 downward via downward pressure to overcome an
 upward bias asserted on the cone retaining post by
 the resilient pad via the cone engaging with the cone
 engaging surface of the cone retaining post so that
 the one or more retaining flanges become aligned
 with the one or more pivot apertures and the cone
 retaining post is configured to be turned about its
 longitudinal axis so that the one or more retaining
 flanges move through the pivot apertures until the
 one or more retaining flanges move adjacent to a
 corresponding one of the upper detents; and

the cone retaining post is configured to have the down-
 ward pressure removed, wherein the one or more
 retaining flanges are biased upward by the resilient
 pad into engagement with the corresponding one of
 the upper detents of the retaining washer interface.

14. The twist-lock debris blade and cone retaining assem-
 bly of claim 8, wherein the cone retaining post is configured
 to decouple from the retaining washer interface in a disc-
 type coin processing system, the disc-type coin processing
 system comprising an annular sorting head having a central
 opening, a rotatable disc having a top surface, and a resilient
 pad coupled to the top surface of the rotatable disc;

the cone retaining post has a longitudinal axis;
 the retaining washer interface is coupled to the rotatable
 disc;

the one or more retaining flanges of the cone retaining
 post are biased upward via an upward bias by the
 resilient pad into engagement with a corresponding one
 of the upper detents of the retaining washer interface;
 the cone retaining post comprises a cone engaging surface
 configured to engage a post engaging surface of a cone;
 and

to decouple the cone retaining post from the retaining
 washer interface in the disc-type coin processing sys-
 tem:

the cone retaining post is configured to be pressed
 downward to overcome the upward bias asserted on
 the cone retaining post by the resilient pad and the
 cone retaining post is configured to be turned about
 its longitudinal axis so that the one or more retaining
 flanges travel under the corresponding one of the
 upper detents of the retaining washer interface and
 move through the pivot apertures and come into
 alignment with the one or more elongated side
 apertures of the retaining washer interface; and

the cone retaining post is configured to be lifted upward
 out of the retaining washer interface by fitting the
 lower portion of the cone retaining post through the
 central opening of the retaining washer interface
 with the one or more retaining flanges aligned with
 the one or more elongated side apertures and though
 the central opening of the cone.

* * * * *